

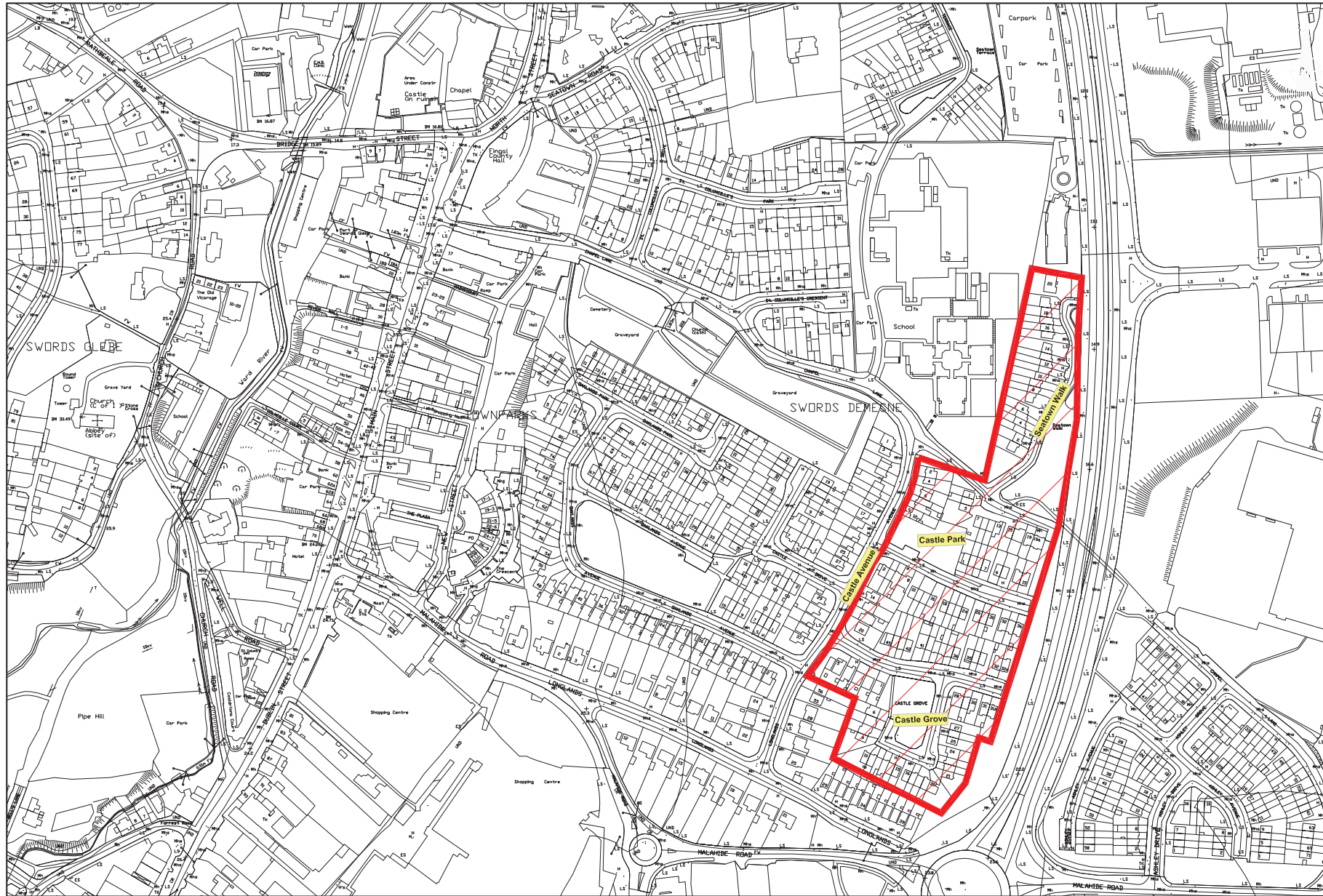

PROPOSED 30km/h SPEED LIMITS - CHAPEL LANE, CASTLE AVENUE & CASTLE PARK, SWORDS, CO. DUBLIN.



TYPICAL SIGNAGE LAYOUT



LEGEND

 -Proposed Residential and Housing Estate 'Slow Zone' - Speed Limit 30km/h



No.	DATE	REVISION

SCALE:-	NTS
DATE:-	MAY 2017
DRAWN:-	COF

PROJECT TITLE:	30km/h SPEED LIMIT
DRAWING TITLE	CHAPEL LANE, CASTLE AVENUE & CASTLE PARK, SWORDS, CO.DUBLIN.
SENIOR ENGINEER:	Colm Keenan

PROJECT ENGINEERS	COLUM GALLAGHER
-------------------	-----------------

DRAWING. NO:	30km/h-2017-SPL-1-006
--------------	-----------------------