

***PROPOSED TRAFFIC
MANAGEMENT SCHEME***

for

***TMP for St Patrick`s Day
Malahide
2024***

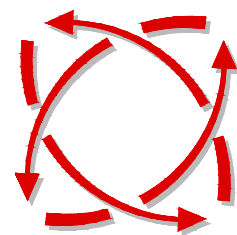

***FREEFLOW
TRAFFIC
MANAGEMENT***

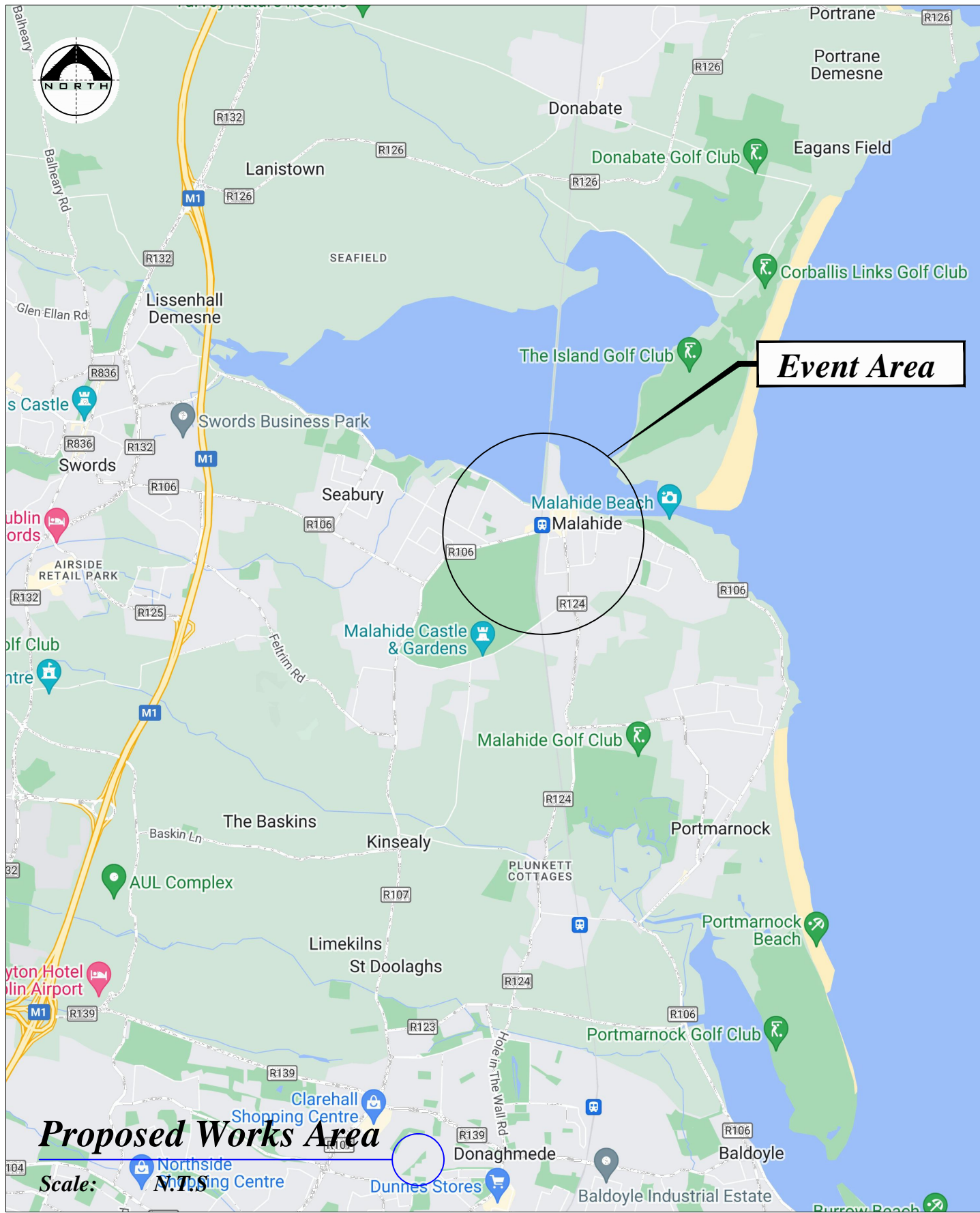

St. Patrick's Day
MALAHIDE PARADE 2024

Comhairle Contae Finghail
 Fingal County Council

PARADE STARTS 2PM
 PLEASE NOTE NEW ROUTE!

12.30 pm
 Assembly Open
 Malahide Cricket Club

1.30 pm
 Assembly Closed

2pm
Parade Starts

Parade Ends
 Malahide Beach Car Park

Find Out More:
www.eventsinfingal.ie/st-patricks-day

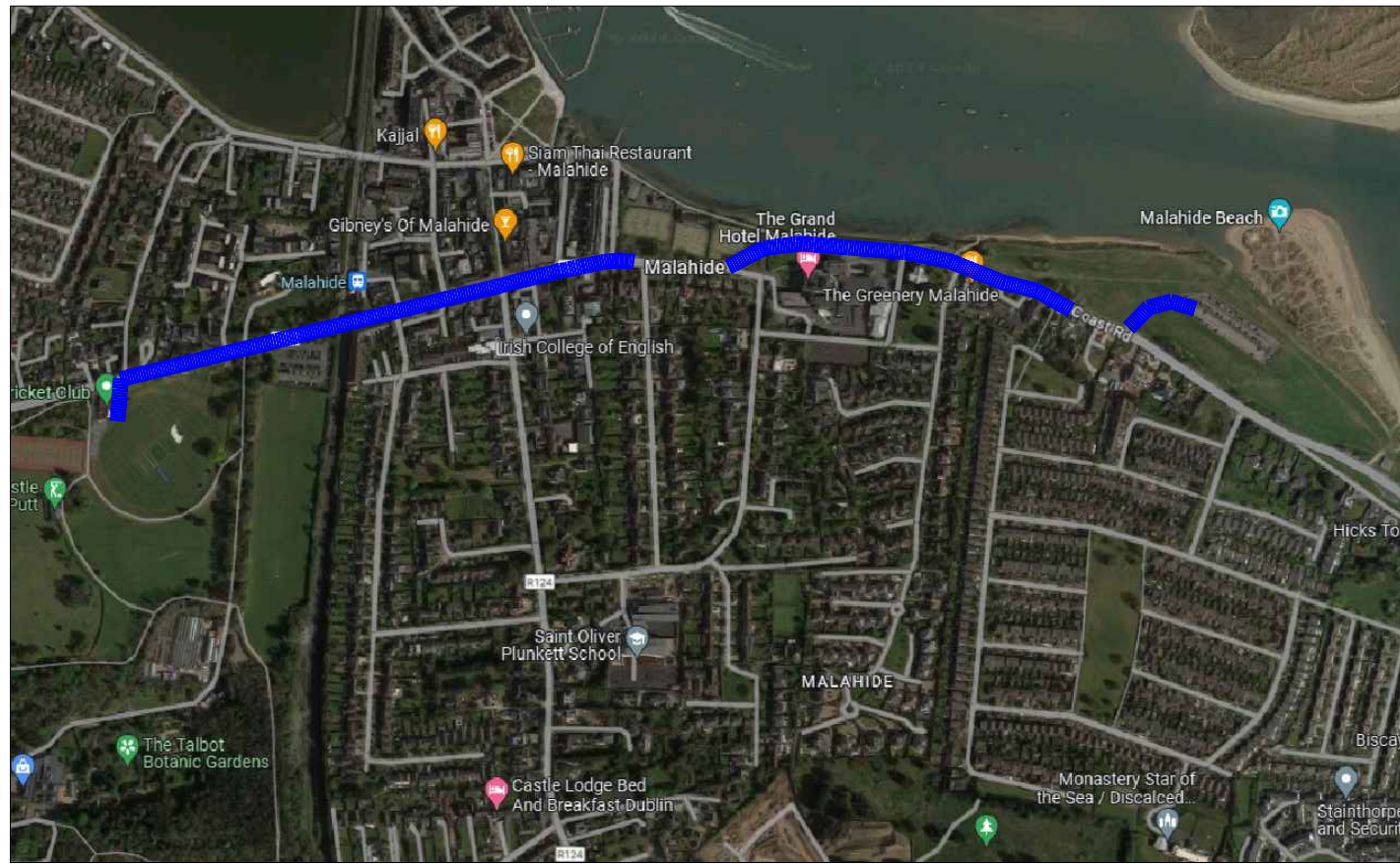

	Rev:	Description:	Date:	Job Details:	Drawing:		Dwg no:
				Proposed Traffic management Plan for St Patrick's Day in Malahide 2024	Proposed Event Location		Rev:
				Sheet:	CAD File ref.:	Drawn By: DM	Date: January 2024

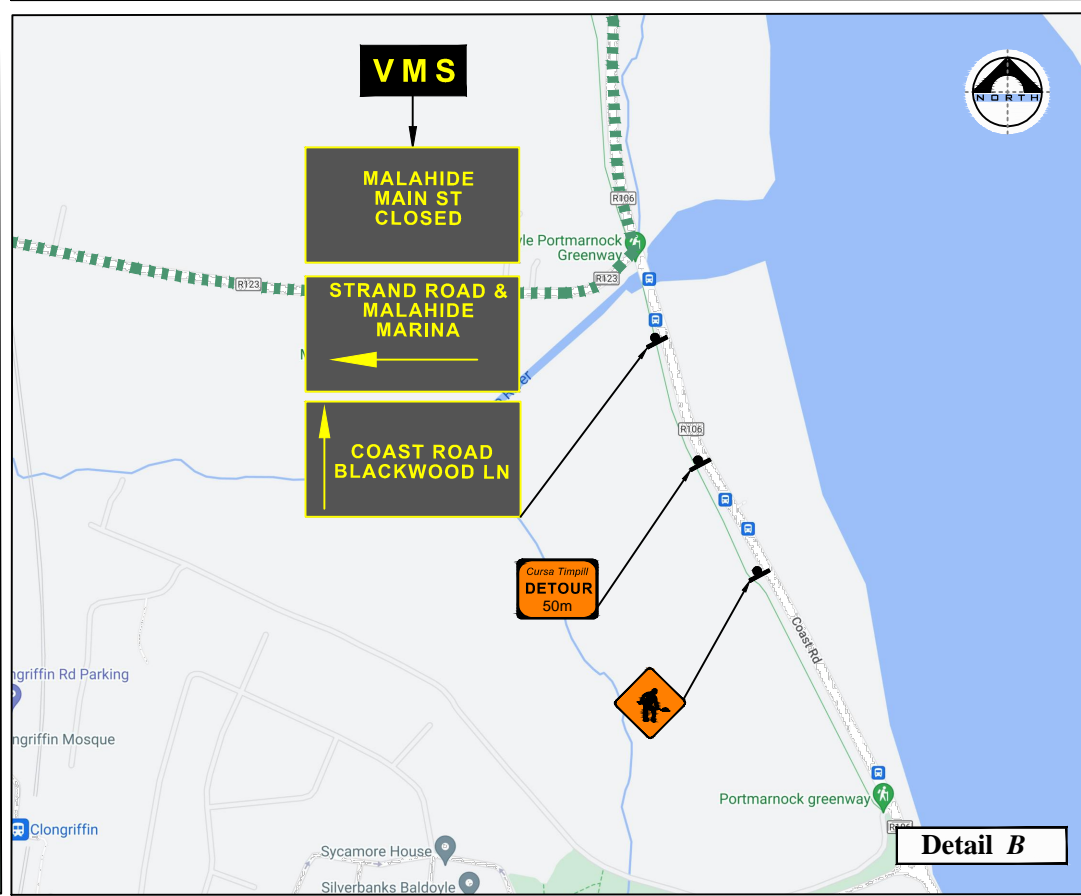
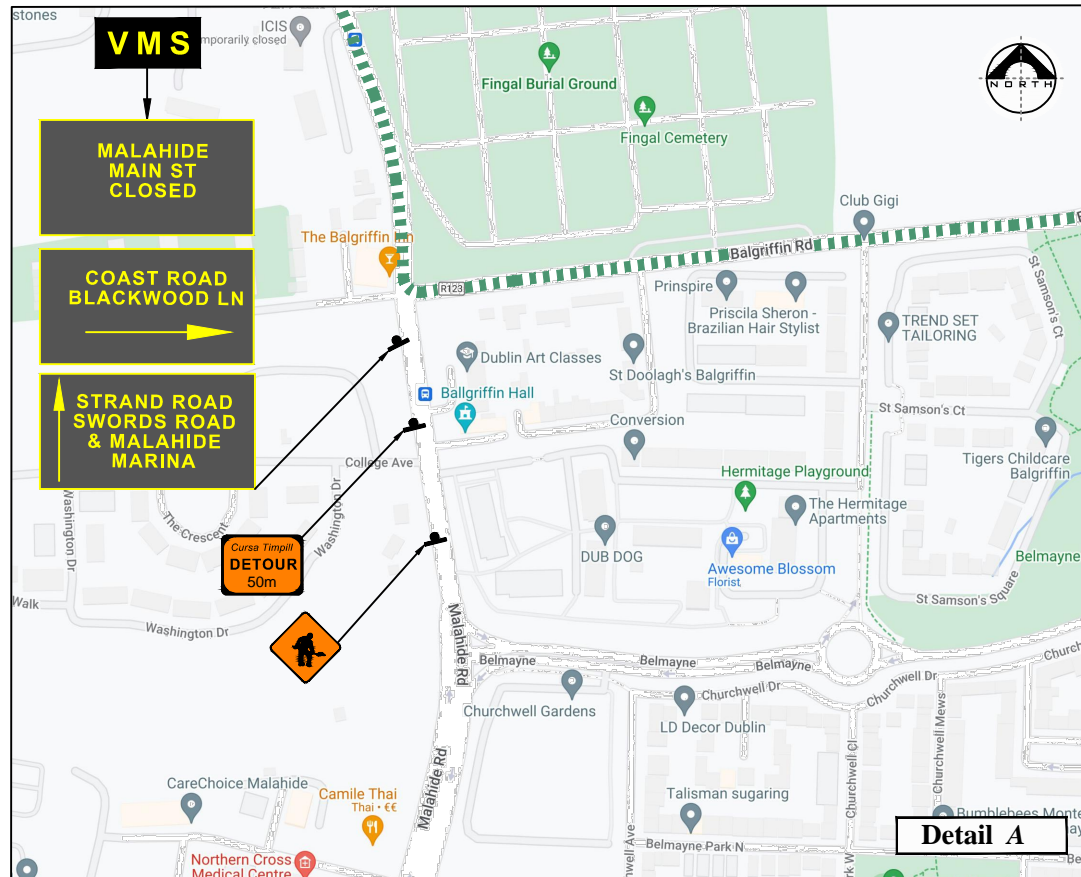
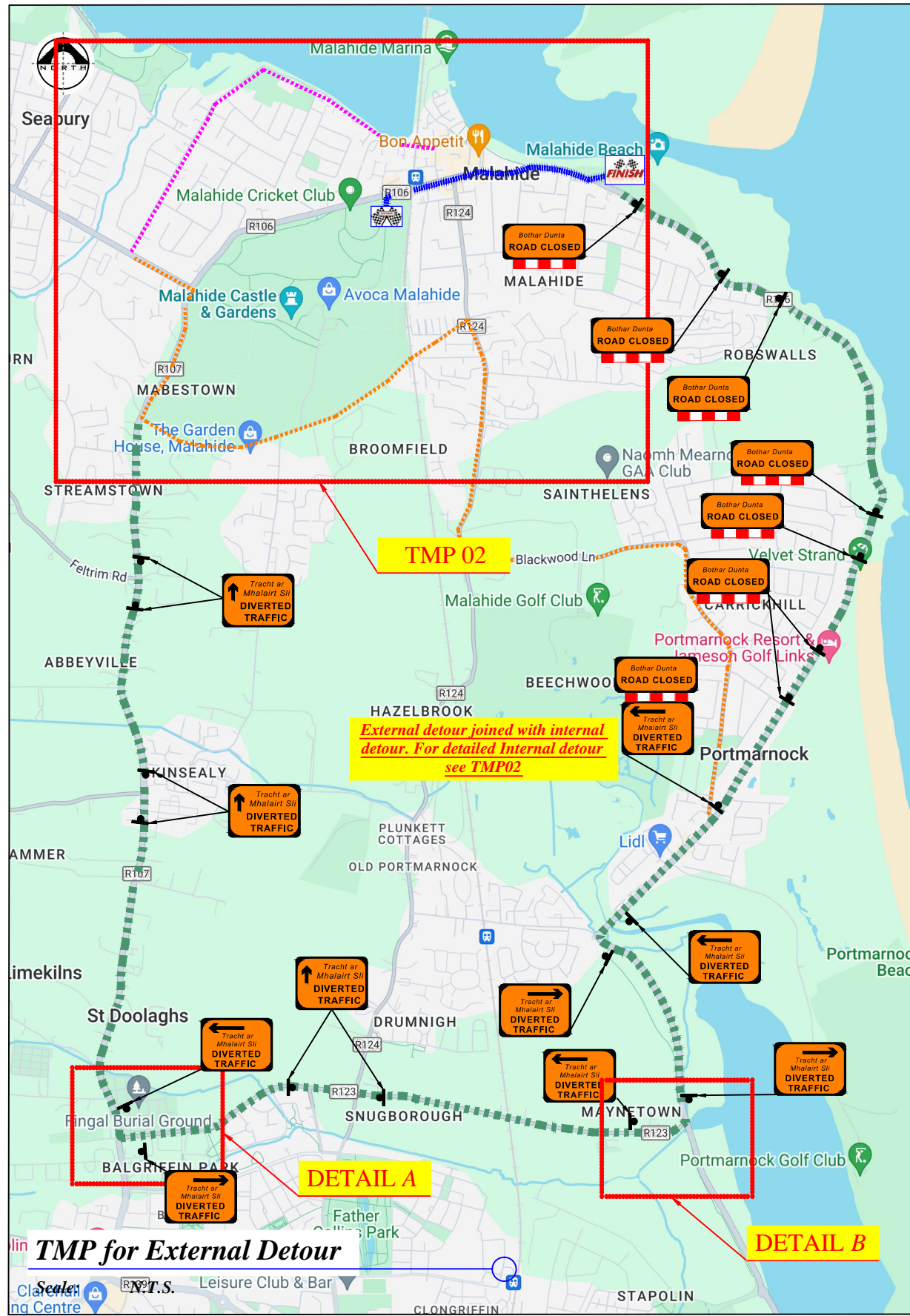

LEGEND

- Sign Location
- Traffic Cones
- Event Route
- Internal Diversion Routes
- Traffic Management Operative
- External Diversion Route

Works TTM type:	Static Type A				
	Design Type A: >12h				
Design Parameters:	LV-1 (I)	LV-1 (III)	LV-1 (IV)	LV-2 (I)	LV-2 (II)
1. Minimum Sign Size mm	450	600	600	600	750
2. Statutory Speed of the Road	30km/h	50	60	80	100
3. Distance between Advance Signs	10m	20m	20m	120m	200m
4. Number of Advance Signs	1 (<12h) 2 (>12h)	2	3 (<12h) 2 (>12h)	3 (<12h) 4 (>12h)	3 (<12h) 4 (>12h)
5. Minimum Visibility of Signs	25m	50m	60m	90m	120m
6. Longitudinal Safety Zone	0.5m	5m	15m	45m	60m
7. Lateral Safety Zone	0.5m	0.5m	0.5m	1.2m	1.2m
8. Leading Taper	1in1m	1in5m	1in10m	1in40	1in100
9. Maximum at Tapers Cone Space	1m	3m	3m	3m	3m
10. Maximum Longitudinal Cone Space	3m	3m	6m	12m	12m
11. Lane Width (m)	2.5m	3 (2.5)	3 (2.5)	3 m	3 m
12. Two-way Roadway width (m)	5m	5m	5m	-	-

- Note:**
- All signs to comply with Chapter 8 of the "Traffic Signs Manual"-Guidance Document-2019.
 - All Traffic Management to be carried out in accordance with Chapter 8 of the "Traffic Signs Manual".
 - Detailed Risk Assessment to be carried out prior to the installation of Traffic Management System.
 - Exact sign positions to be agreed on site.
 - All affected Parties and An Garda Siochana to be notified prior to works commencing.
 - Signs to be positioned so as not to cause an obstruction to other road users.
 - All signs to be faced with retro-reflective material to class ref 2 of EN 12899.
 - "End of Roadworks" sign placed 20m to 50m from end of works area.
 - Road Closure points to be manned.
 - External detour joined with internal detour. For detailed Internal detour see TMP02**

FREEFLOW TRAFFIC MANAGEMENT

Rev:	Description:	Date:

Job Details:
 Proposed Traffic Management Plan for St Patrick's Day in Malahide 2024

Sheet: CAD File ref.:

Drawing:
 TMP for External Detour

Drawn By: **DM** Date: **January 2024**

Dwg no: **01**
 Rev: **01**
 Scale: **As Shown**

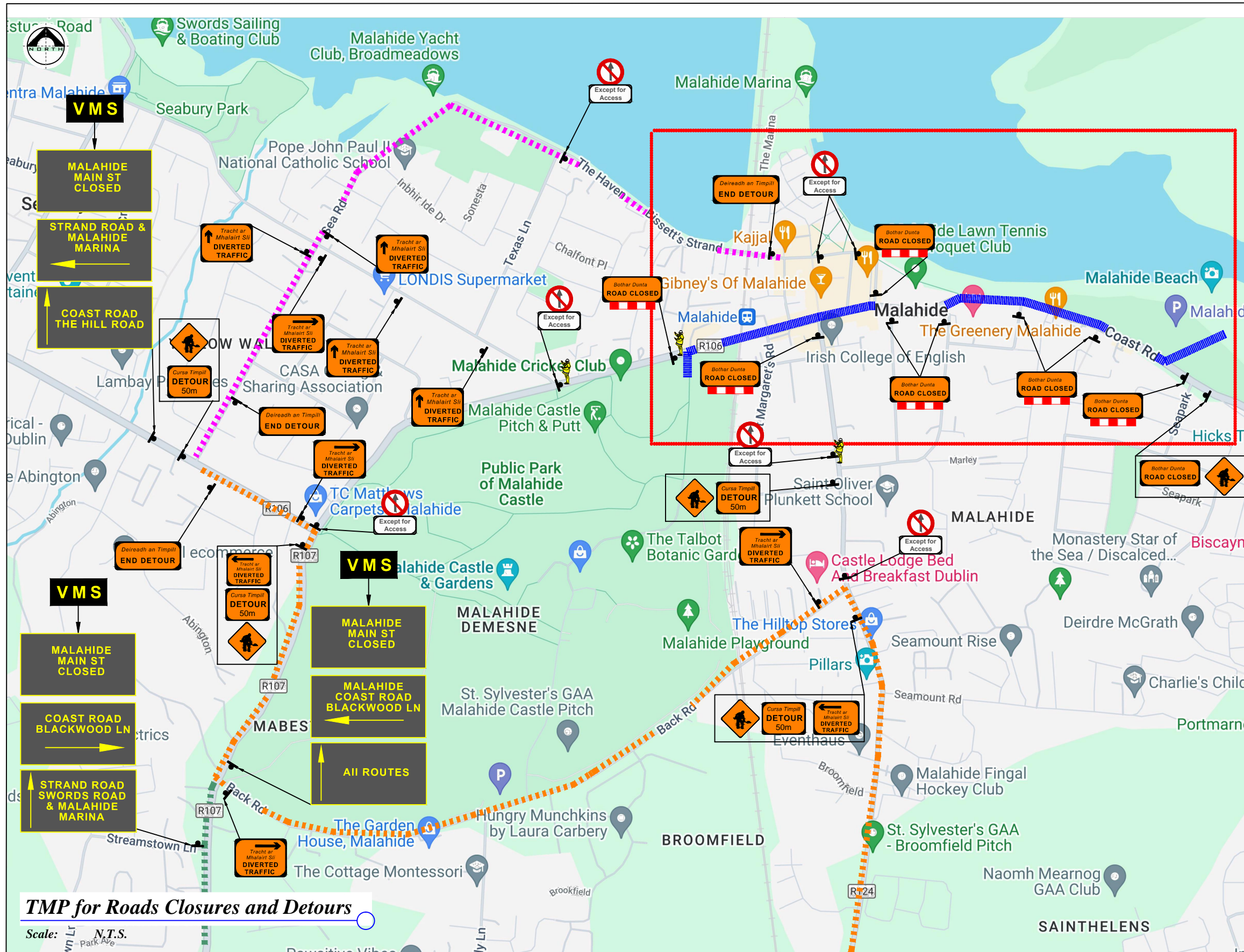

LEGEND

- Sign Location
- Traffic Cones
- Event Route
- Internal Diversion Routes
- Traffic Management Operative
- External Diversion Route

Works TTM type:	Static Type B				
Design Parameters:	Design Type B: <12h				
	LV-1 (I)	LV-1 (III)	LV-1 (IV)	LV-2 (I)	LV-2 (II)
1. Minimum Sign Size mm	450	600	600	600	750
2. Statutory Speed of the Road	30km/h	50	60	80	100
3. Distance between Advance Signs	10m	20m	20m	120m	200m
4. Number of Advance Signs	1 (<12h)	2	3 (<12h)	3 (<12h)	3 (<12h)
5. Minimum Visibility of Signs	25m	50m	60m	90m	120m
6. Longitudinal Safety Zone	0.5m	5m	15m	45m	60m
7. Lateral Safety Zone	0.5m	0.5m	0.5m	1.2m	1.2m
8. Leading Taper	1in1m	1in5m	1in10m	1in40	1in100
9. Maximum at Tapers Cone Space	1m	3m	3m	3m	3m
10. Maximum Longitudinal Cone Space	3m	3m	6m	12m	12m
11. Lane Width (m)	2.5m	3 (2.5)	3 (2.5)	3m	3m
12. Two-way Roadway width (m)	5m	5m	5m	-	-

Note:

- All signs to comply with Chapter 8 of the "Traffic Signs Manual"-Guidance Document-2019.
- All Traffic Management to be carried out in accordance with Chapter 8 of the "Traffic Signs Manual".
- Detailed Risk Assessment to be carried out prior to the installation of Traffic Management System.
- Exact sign positions to be agreed on site.
- All affected Parties and An Garda Siochana to be notified prior to works commencing.
- Signs to be positioned so as not to cause an obstruction to other road users.
- All signs to be faced with retro-reflective material to class ref 2 of EN 12899.
- "End of Roadworks" sign placed 20m to 50m from end of works area.
- Road Closure points to be manned.
- Once parade is in Beach Car Park, Traffic will be released westbound only to allow dismantle of barriers.



Rev:	Description:	Date:	Job Details:	Drawing:	Dwg no:
			Proposed Traffic Management Plan for St Patrick's Day in Malahide 2024	TMP for Road Closures	02
			Sheet:	Drawn By:	Rev:
			CAD File ref.:	DM	
				Date:	Scale:
				January 2024	As Shown

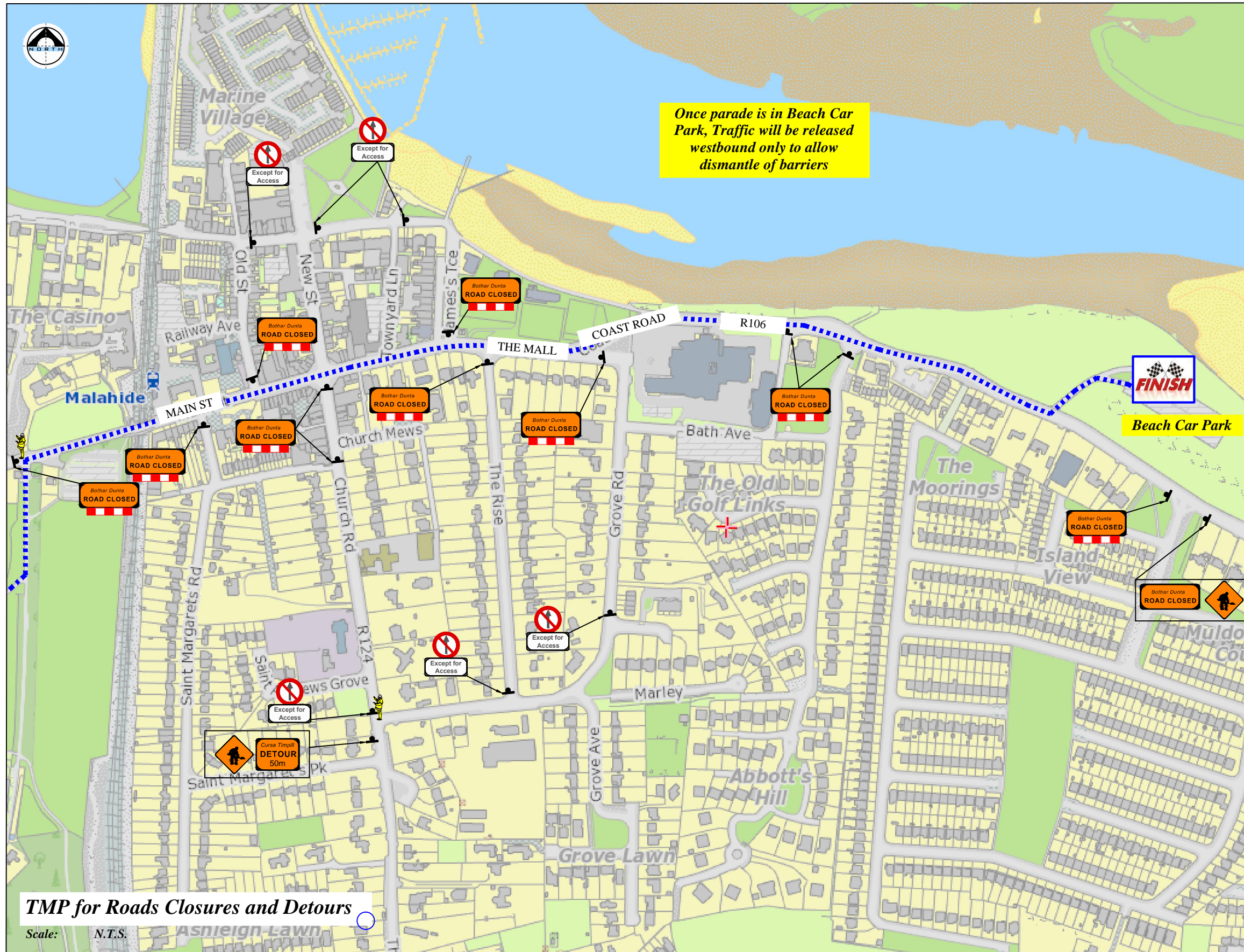

Once parade is in Beach Car Park, Traffic will be released westbound only to allow dismantle of barriers

LEGEND

- Sign Location
- Traffic Cones
- Event Route
- Internal Diversion Routes
- Traffic Management Operative
- External Diversion Route

Works TTM type:	Static Type B				
	Design Type B: <12h				
Design Parameters:	LV-1 (I)	LV-1 (III)	LV-1 (IV)	LV-2 (I)	LV-2 (II)
1. Minimum Sign Size mm	450	600	600	600	750
2. Statutory Speed of the Road	30km/h	50	60	80	100
3. Distance between Advance Signs	10m	20m	20m	120m	200m
4. Number of Advance Signs	1 (<12h) 2 (>12h)	2	3 (<12h) 2 (>12h)	3 (<12h) 4 (>12h)	3 (<12h) 4 (>12h)
5. Minimum Visibility of Signs	25m	50m	60m	90m	120m
6. Longitudinal Safety Zone	0.5m	5m	15m	45m	60m
7. Lateral Safety Zone	0.5m	0.5m	0.5m	1.2m	1.2m
8. Leading Taper	1in1m	1in5m	1in10m	1in40	1in100m
9. Maximum at Tapers Cone Space	1m	3m	3m	3m	3m
10. Maximum Longitudinal Cone Space	3m	3m	6m	12m	12m
11. Lane Width (m)	2.5m	3 (2.5)	3 (2.5)	3 m	3 m
12. Two-way Roadway width (m)	5m	5m	5m	-	-

- Note:**
- All signs to comply with Chapter 8 of the "Traffic Signs Manual"-Guidance Document-2019.
 - All Traffic Management to be carried out in accordance with Chapter 8 of the "Traffic Signs Manual".
 - Detailed Risk Assessment to be carried out prior to the installation of Traffic Management System.
 - Exact sign positions to be agreed on site.
 - All affected Parties and An Garda Siochana to be notified prior to works commencing.
 - Signs to be positioned so as not to cause an obstruction to other road users.
 - All signs to be faced with retro-reflective material to class ref 2 of EN 12899.
 - "End of Roadworks" sign placed 20m to 50m from end of works area.
 - Road Closure points to be manned.
 - Once parade is in Beach Car Park, Traffic will be released westbound only to allow dismantle of barriers.

TMP for Roads Closures and Detours

Scale: N.T.S.



Rev:	Description:	Date:	Job Details:	Drawing:	Dwg no:
			Proposed Traffic Management Plan for St Patrick's Day in Malahide 2024	TMP for Road Closures	03
			Sheet:	Drawn By:	Rev:
			CAD File ref.:	DM	
				Date:	Scale:
				January 2024	As Shown