

TMP for Road Closure at New Road / R126 Junction

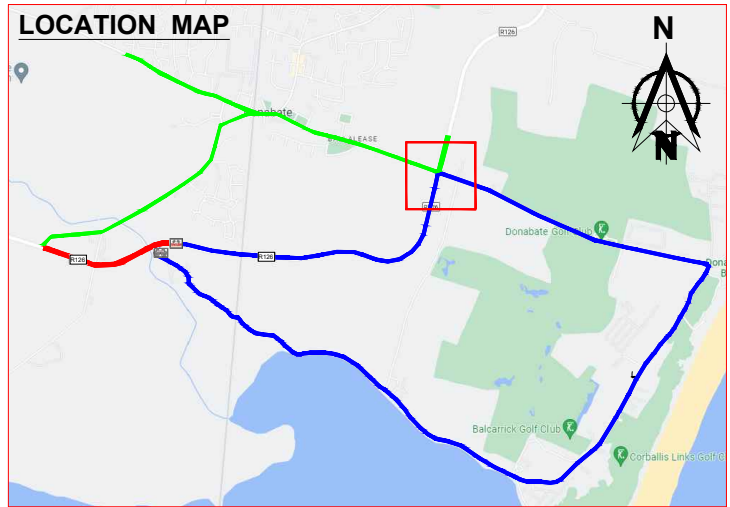
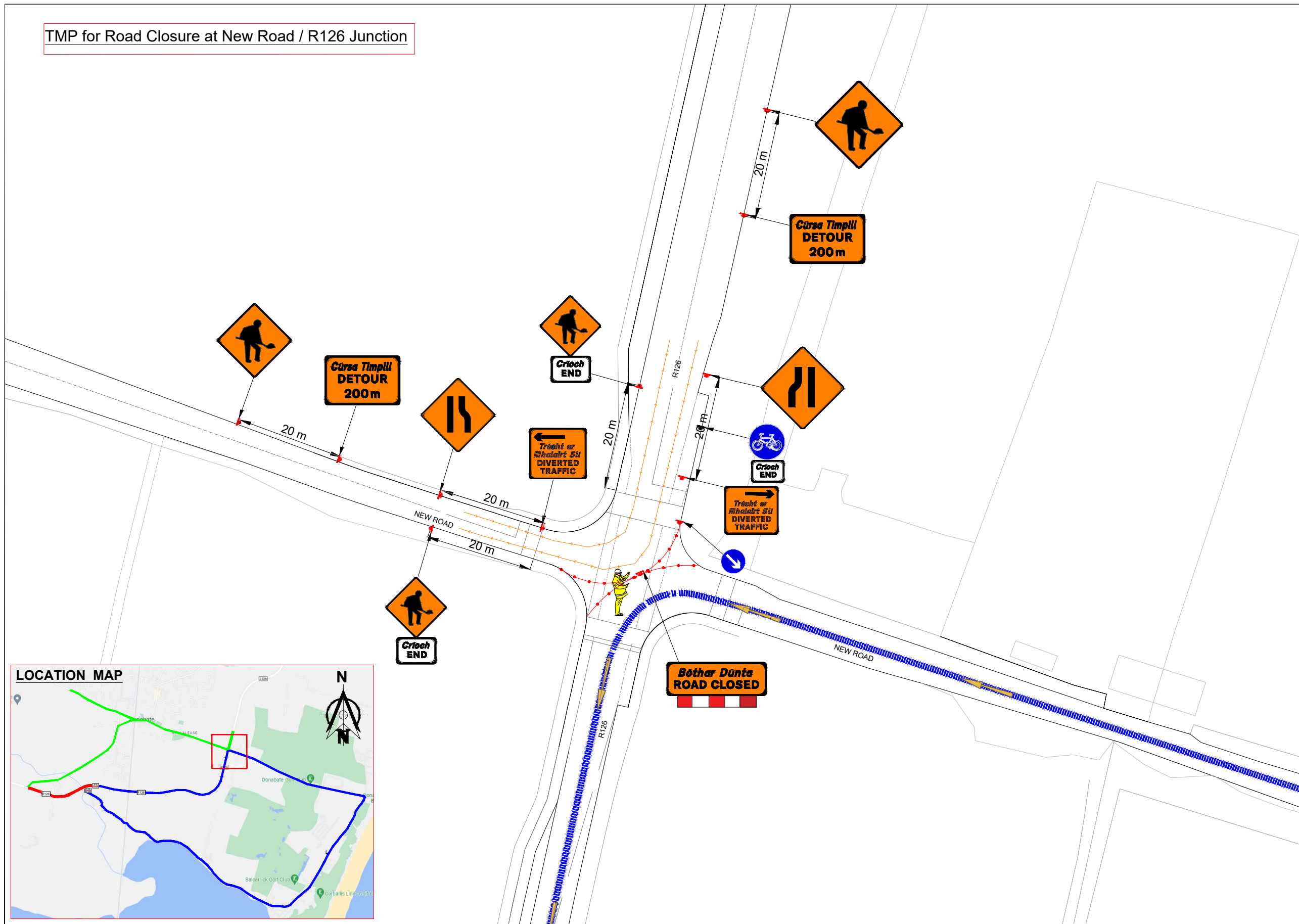

DESIGNS PARAMETERS:

DESIGN PARAMETERS	LEVEL 1
ROAD LEVEL/SUB-LEVEL:	1(iii)
ROAD SPEED LIMIT:	50km/h
WORKS TYPE:	B
NUMBER OF ADW SIGNS:	2
DISTANCE BETWEEN SIGNS	20m
SIGN VISIBILITY:	50m
MINIMUM SIGN SIZE:	600mm
LONGITUDINAL SAFETY ZONE:	5m
LATERAL SAFETY ZONE:	0.5m
TAPER CONE SPACING:	3m
LONGITUDINAL CONE SPACING:	3m
TAPER LENGTH at LANE:	1 in 5
TAPER LENGTH at H/S	1 in 5
LAMP SPACING at TAPER:	6m
LAMP SPACING at LONGITUDINAL:	6m
MINIMUM CONE SIZE:	750mm
MINIMUM LANE WIDTH:	3 (2.5)m
TRAFFIC MANAGEMENT SYSTEM:	Stop & Go

- GENERAL NOTES:**
- All signs to be in accordance with Chapter 8 of TSM Guidance Document 2019.
  - Signs to be placed so as not to cause a hazard to road users and pedestrians.
  - Safety Zones to be in accordance with Chapter 8 and maintained at all times.
  - All necessary consultation, liaison and approvals will have taken place before installation.
  - Any changes to TM Plan undertaken on site must be communicated to and approved by the Designer and notified to the PSDP and PSCS.
  - Installation of central coning to be assessed by TM Supervisor on-site. If there is not enough room, central coning not to be placed.

- DUTIES & RESPONSIBILITIES :**
- The Designer has designed the attached TTM plan with all the best available information at the time of design. Should any further information become applicable it should be communicated to the designer for review and inclusion in the design as necessary.
  - It is the client's responsibility to employ a competent person to ensure that the scheme is installed safely.
  - For safe and consistent methods of TTM installation the installer of the scheme should as a minimum refer to the DTT as documents "Temporary Traffic Management Operations Guidance Parts 0,1,2 & 3" as appropriate. This should be carried out in addition to and in combination with the installers own method statement, risk assessment and SOP's.SITE

- SITE SPECIFIC NOTES:**
- A risk assessment to be done on site before the implementation of this traffic management plan
  - Temporary pedestrian ramps to be used where footpath is closed and pedestrians are diverted on the other side of footpath.
  - Residents to be notified in advance of the works and the tm system to be put in place.

- LEGEND:**
- Event Area
  - Sign Symbol
  - T.M.O or Marshal
  - Traffic Flow
  - Traffic Cones



Project Title:  
Proposed Traffic Management Plan for LSA Peninsula 4-Mile Road Race

Drawing Title:  
TMP for Road Closure at New Road / R126 Junction

Revision Details Box	
Rev. No	Comments

Detail Box		
Draft by: MV	Scale: not to scale	Drawing no.: TMD-2023-TP-003
Designed by: PMC	Date: 19.01.2023	Rev: 00
Approved by: PMC		