



**THE PROPOSED DEVELOPMENT INCLUDES:**

The construction of 2 number 4 storey apartment buildings - One building on Site Number 1 and one building on Site Number 2, comprising of 36 number apartments in total.

The apartment buildings will be faced in brick and render and have flat green roofs with solar panels.

Landscaping works for both sites include boundaries, SUDs drainage, and all associated site works.

**Site Number 1 includes:**

20 number 2 bed (4 person) apartments across 4 floors with stairs / lift / external walkway access and;

Hard and soft landscaping with 10 number car parking spaces and a communal bin store to the south east of the site; and secure bike stores to the north east of the site; and communal landscaping to the north west of the site.

**Site Number 2 includes:**

8 number 2 bed (4 person) apartments and 8 number 2 bed (3 person) apartments across 4 floors with stairs / lift / external walkway access and;

Hard and soft landscaping including 8 number car parking spaces and bin and secure bike stores and communal landscaping to the south east of the site and communal landscaping to the north west of the site.

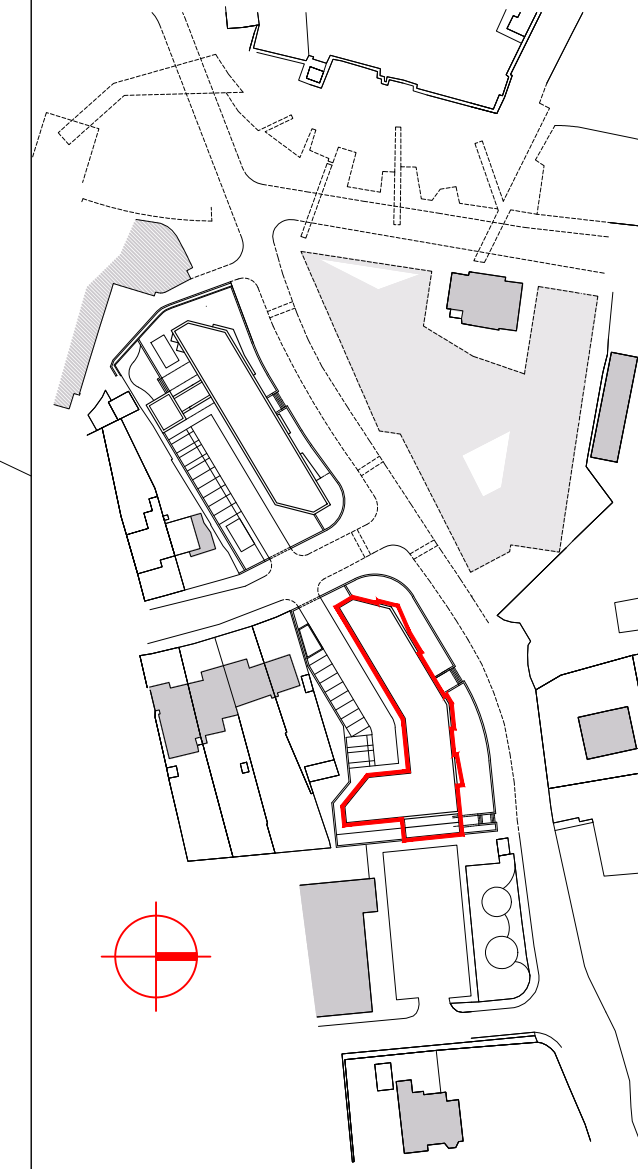

**Comhairle Contae Fhine Gall  
Fingal County Council**  
ARCHITECTS' DEPARTMENT  
FINGAL COUNTY HALL, MAIN ST.,  
SWORDS CO., DUBLIN  
Tel: (01) 890 5050, Fax: (01) 890 5079  
COUNTY ARCHITECT  
FIONNULA MAY Dip.Arch., B.Arch. Sc., M.U.B.C., M.R.I.A.I.

CLIENT	FCC Housing Department
PROJECT TITLE	Proposed Apartment Development at Seatown Road, Swords
PROJECT STAGE	Part XI
DRAWING TITLE	SITE NO 1 PROPOSED GROUND FLOOR PLAN

PROJECT ARCHITECT	DD	CHECKED	CB
DRAWN	DD	DATE	September 2022
SCALE	As shown @ A1		

DRAWING NUMBER	22027-P-201	REV	
----------------	-------------	-----	--

**SITE NO 1 - PROPOSED GROUND FLOOR PLAN (SCALE 1:100)**