

GENERAL NOTES:

1. ALL DIMENSIONS AND LEVELS TO BE VERIFIED ON SITE PRIOR TO COMMENCEMENT OF THE WORKS. ANY DISCREPANCIES TO BE REPORTED TO THE ENGINEER.
2. THIS DRAWING IS TO BE READ IN CONJUNCTION WITH THE RELEVANT ARCHITECT'S AND OTHER ENGINEERING DRAWINGS.

WATERMAIN LAYOUT LEGEND

- EXISTING WATERMAIN (CONFIRMED BY GPR SURVEY)
- - - EXISTING WATERMAIN (RECORDS ONLY)
- - - PROPOSED WATERMAIN 100mm (PE80)
- W PROPOSED STOPCOCK AND WATER METER BOUNDARY BOX
- - - 25mm ϕ SERVICE CONNECTION FROM BOUNDARY BOX
- FH PROPOSED FIRE HYDRANT
- MP PROPOSED MARKER POST & INDICATOR PLATE
- TB PROPOSED CONCRETE THRUST BLOCK
- AV PROPOSED AIR VALVE
- SV PROPOSED SLUICE VALVE
- MB PROPOSED MANIFOLD BOUNDARY BOX TO I.W. SPECIFICATION (UNITS 10-13)

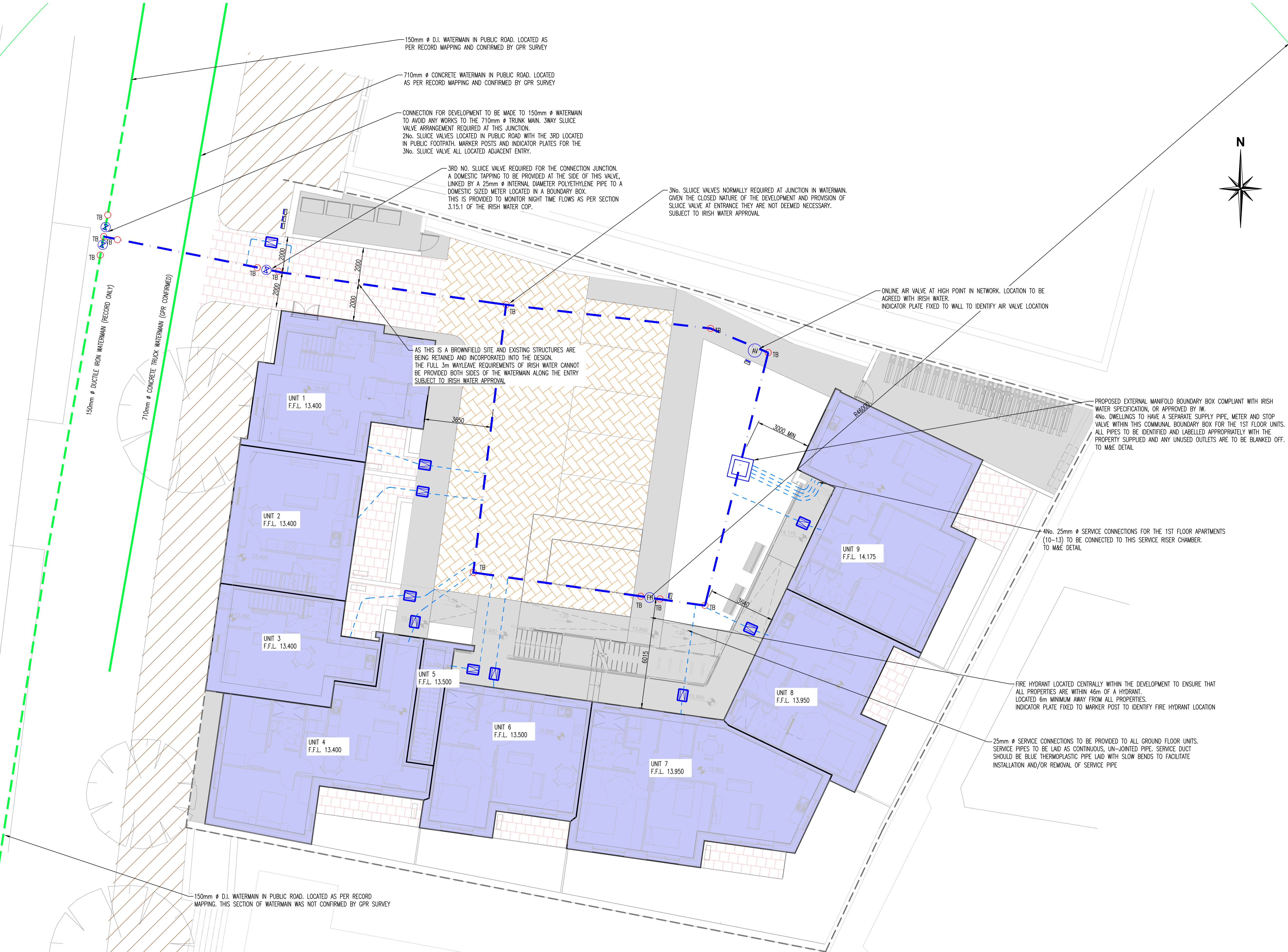
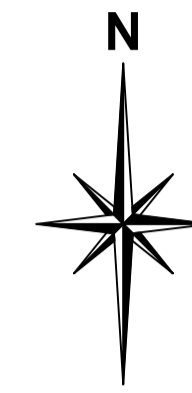

PROPOSED WATERMAIN LAYOUT
SCALE 1:100

REV	DATE	DESCRIPTION	BY	APPR
B	19.10.22	UPDATED WITH LATEST LAYOUT FROM ARCHITECT 17.05.22	WD	MK
A	01.09.22	UPDATED WITH LATEST LAYOUT	FM	MK

DRAWING STATUS:
PART 8_PLANNING

CLIENT:
FINGAL COUNTY COUNCIL

JOB DESCRIPTION:
13No. DWELLING HD AT 30-32 NORTH STREET, SWORDS, Co. DUBLIN

DRAWING TITLE:
PROPOSED WATERMAIN LAYOUT

PROJECT No.:	DRAWING No.:
P-3626	C-03
SCALE:	REV. No.:
1:100	B
SHEET:	DATE:
A1	25.07.22
DRAWN BY:	CHECKED BY:
PM	MK
APPROVED BY:	DATE:
PMCM	

McMahon Associates
Consulting Civil & Structural Engineers, Project Managers
Environmental Engineers, PSDP & Traffic Engineers
The Mill Building, Newtown Link Road, Greenhills, Drogheda, Co. Louth
t: 041 2137 050 e: info@mcMahonengineers.com