

GENERAL NOTES:

1. ALL DIMENSIONS AND LEVELS TO BE VERIFIED ON SITE PRIOR TO COMMENCEMENT OF THE WORKS. ANY DISCREPANCIES TO BE REPORTED TO THE ENGINEER.
2. THIS DRAWING IS TO BE READ IN CONJUNCTION WITH THE RELEVANT ARCHITECT'S AND OTHER ENGINEERING DRAWINGS.

DRAINAGE LAYOUT LEGEND

- PROPOSED uPVC STORM SEWER & 1200mm Ø MANHOLE
- PROPOSED uPVC FOUL SEWER & 1200mm Ø MANHOLE
- PROPOSED 1200mm Ø BACKDROP MANHOLE
- PROPOSED 1200mm Ø BACKDROP MANHOLE
- PROPOSED 150mm I.D. uPVC STORM SEWER & 450mm Ø DEMARCATION IC
- EXISTING STORM SEWER
- EXISTING FOUL SEWER
- PROPOSED FILTER DRAIN / PLANTED RILL
- 100mm PERFORATED LAND DRAIN
- PROPOSED DOMESTIC GULLY
- PROPOSED ACO CHANNEL & SUMP OUTLET O.E.A.
- PROPOSED ROAD GULLY
- PROPOSED 210L RAINWATER BUTTS
- PROPOSED TREE PIT

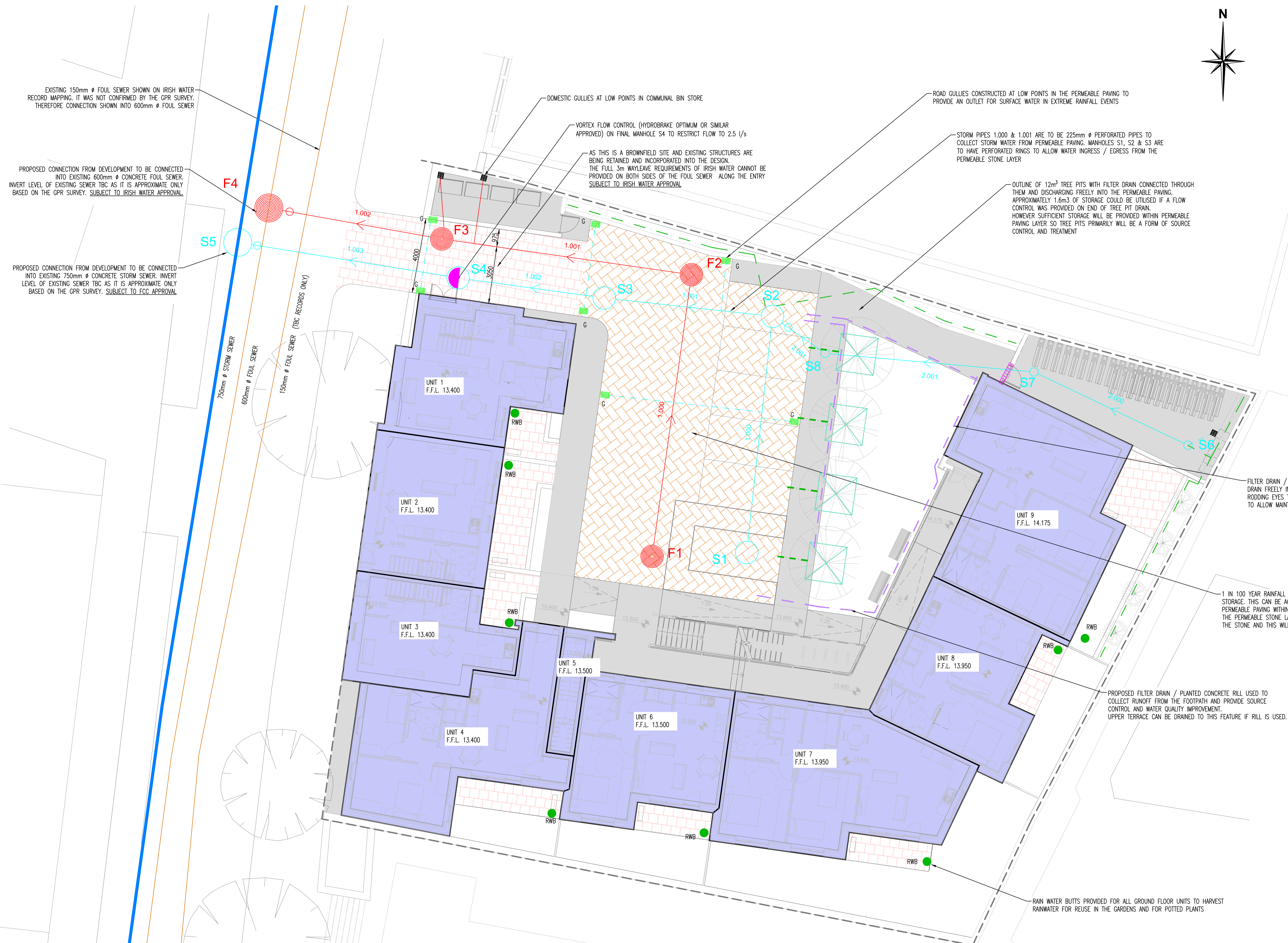
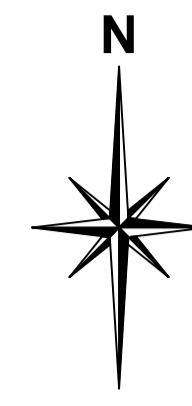

REV	DATE	DESCRIPTION	BY	APPR
C	19.10.22	UPDATED WITH LATEST LAYOUT FROM ARCHITECT 17.10.22	WD	MK
B	21.09.22	UPDATED WITH LATEST LAYOUT	PM	MK
A	09.08.22	DWG STATUS UPDATED TO PLANNING	PM	PM/M

DRAWING STATUS:	
PART_8_PLANNING	
CLIENT:	
FINGAL COUNTY COUNCIL	
JOB DESCRIPTION:	
13No. DWELLING HD AT 30-32 NORTH STREET, SWORDS, Co. DUBLIN	
DRAWING TITLE:	
PROPOSED DRAINAGE LAYOUT	
PROJECT No.:	DRAWING No.:
P-3626	C-02
SCALE:	DATE:
1:100	25.07.22
DRAWN BY:	CHECKED BY:
PM	MK
APPROVED BY:	DATE:
PMCM	

McMahon Associates
 Consulting Civil & Structural Engineers, Project Managers
 Environmental Engineers, PSDP & Traffic Engineers
 The Mill Building, Newtown Link Road, Greenhills, Drogheda, Co. Louth
 t: 041 2137 050 e: info@mcMahonengineers.com

PROPOSED DRAINAGE LAYOUT
SCALE 1:100