

A1

DO NOT SCALE

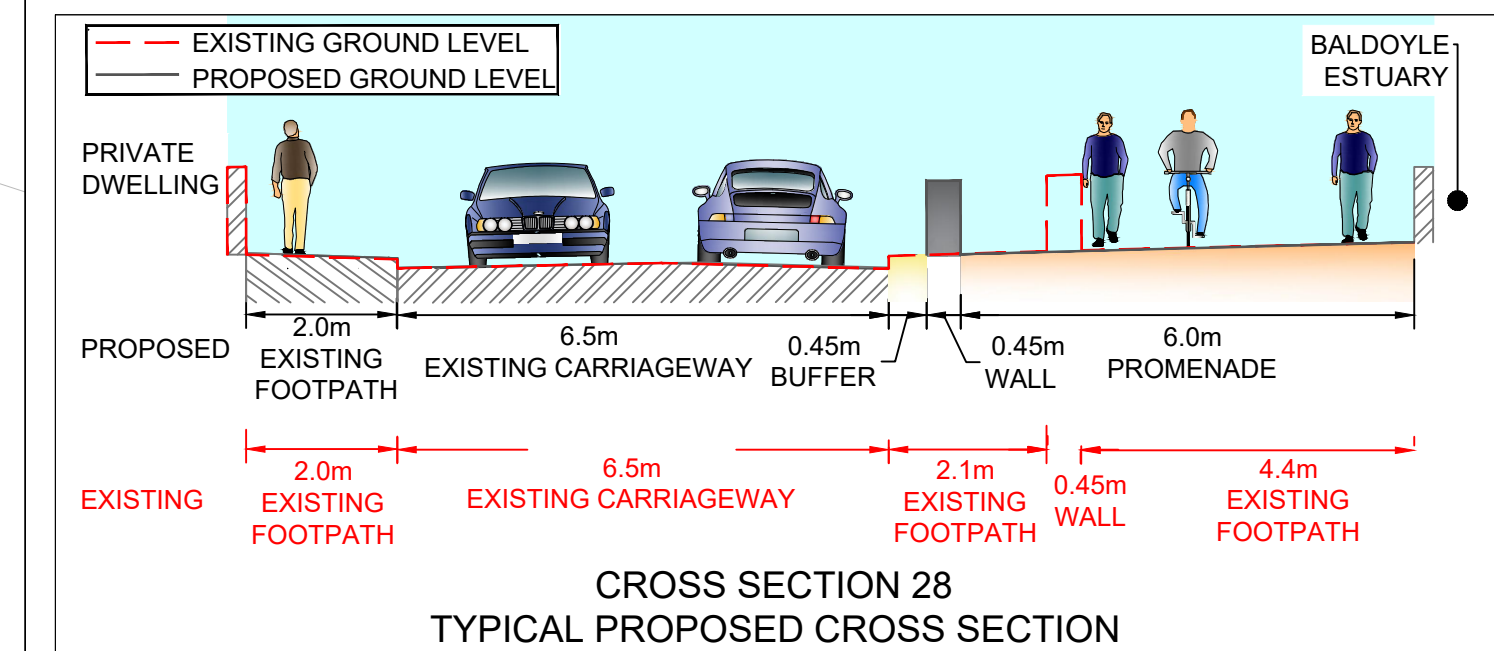
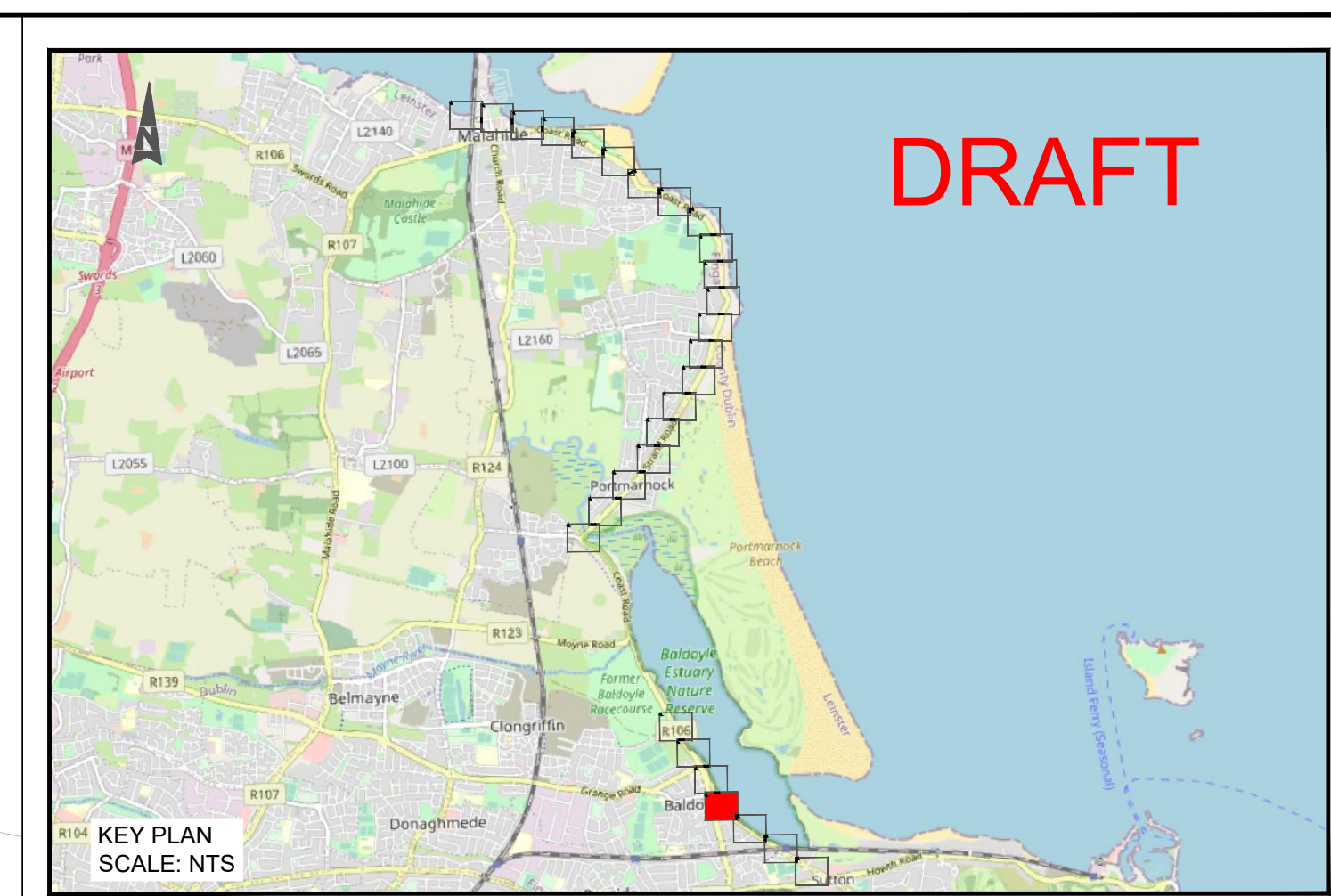
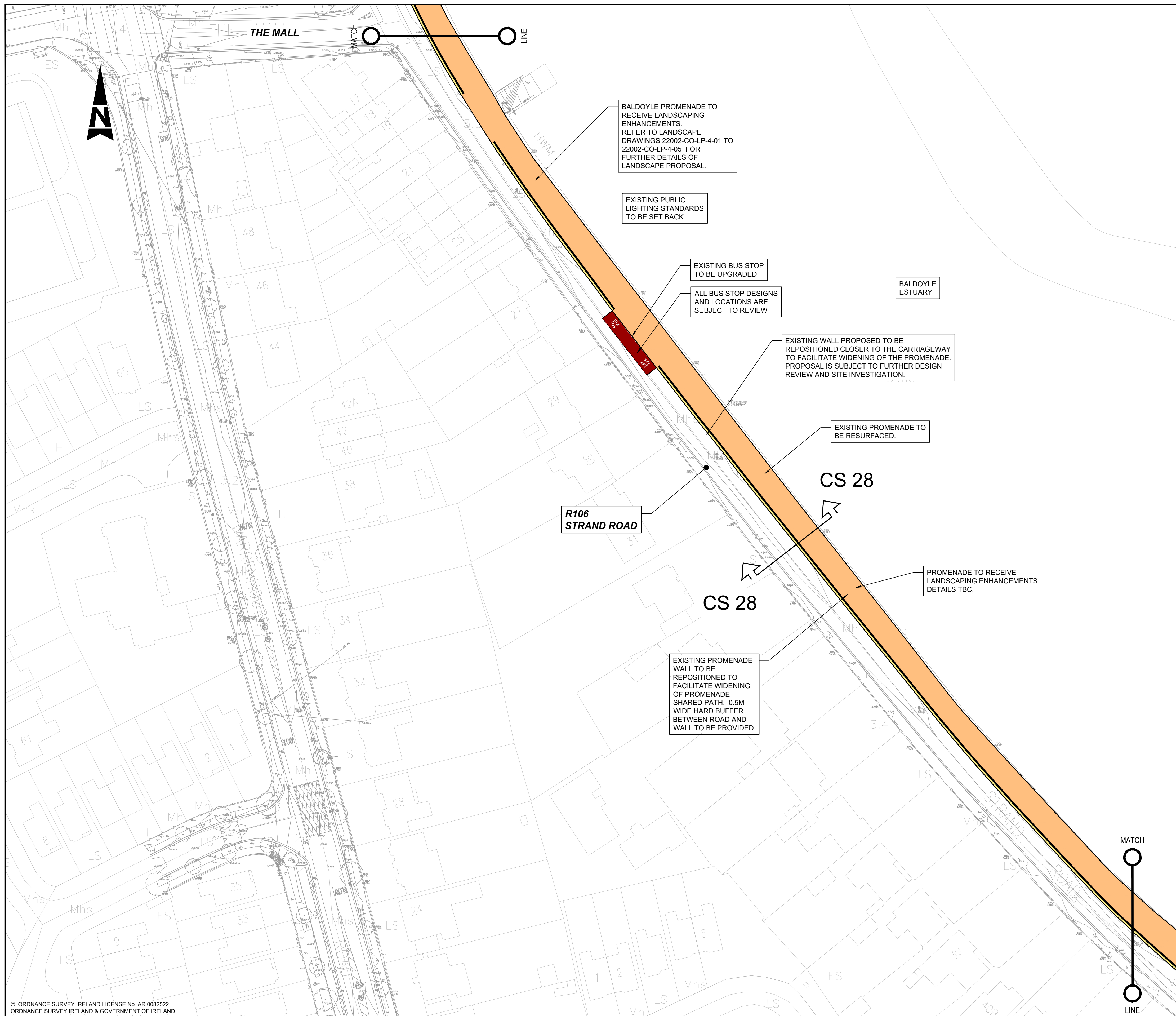

LEGEND:

	CYCLE TRACK		BUS STOP
	CYCLE LANE		LANDTAKE
	SHARED PATH		EXISTING TREES TO BE REMOVED
	FOOTPATH		EXISTING TREES TO BE RETAINED
	BRIDGE / BOARDWALK		CROSS SECTION
	CARRIAGEWAY		
	RAISED CROSSING		
	GRASS VERGE		
	TACTILE PAVING - CONTROLLED		
	TACTILE PAVING - UNCONTROLLED		
	SHARED STREET (HIGH QUALITY PAVEMENT)		

(NOTE: ALL COLOURS ARE INDICATIVE)

© ORDNANCE SURVEY IRELAND LICENSE No. AR 0082522
 ORDNANCE SURVEY IRELAND & GOVERNMENT OF IRELAND

Comhairle Contae Fhine Gall
Fingal County Council

NTA
Udarás Náisiúnta Iompair
National Transport Authority

Rev	Description	By	Date	Chk'd	Auth
D	DRAFT	AK	21.03.22	PF	PF
C	DRAFT	AK	16.03.22	PF	PF
B	DRAFT	AK	14.03.22	PF	PF
A	DRAFT	AK	22.02.22	CF	CF
-	DRAFT	AK	07.02.22	CF	CF

ATKINS
Member of the SNC-Lavalin Group

Unit 2B, 2200 Cork Airport Business Park, Cork
Tel (+353) 01 810 8000 Fax (+353) 01 810 8001

1st Floor Technology House Parkmore Technology Park, Galway
Tel (+353) 091 786 050 Fax (+353) 091 779 830

FINGAL COUNTY COUNCIL

SUTTON TO MALAHIDE PEDESTRIAN AND CYCLE SCHEME

Purpose PUBLIC CONSULTATION			
Title PRELIMINARY DESIGN SHEET 25 OF 28 0125 - BALDOYLE			
Original Scale 1:500 at A1 1:1000 at A3	Design/Drawn AK	Checked CF	Authorised CF
Date 07.02.22	Date 07.02.22	Date 07.02.22	Date 07.02.22
Status I	Drawing Number 5158418 / HTR / DR / 02 / 0125	Rev D	

File: 5158418_HTR_DR_02_0101-0128(COMBINED).dwg
 Date: Mar 21, 2022 - 8:53pm
 Plotted by: AKoyobolisev