

A1

DO NOT SCALE

File: 5158418\_HTR\_DR\_02\_0101-0128(COMBINED).dwg  
Date: Mar 21, 2022 - 8:14pm  
Plotted by: AKyobolisev

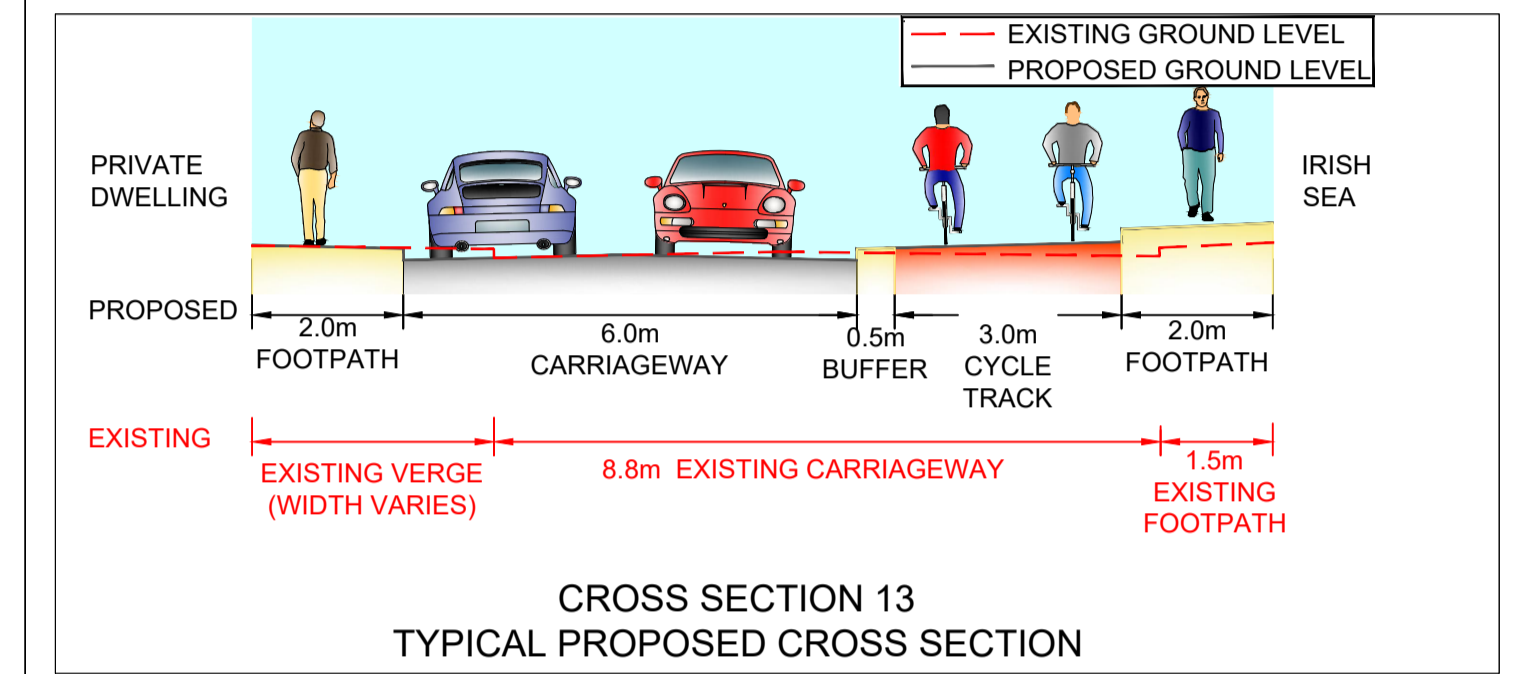
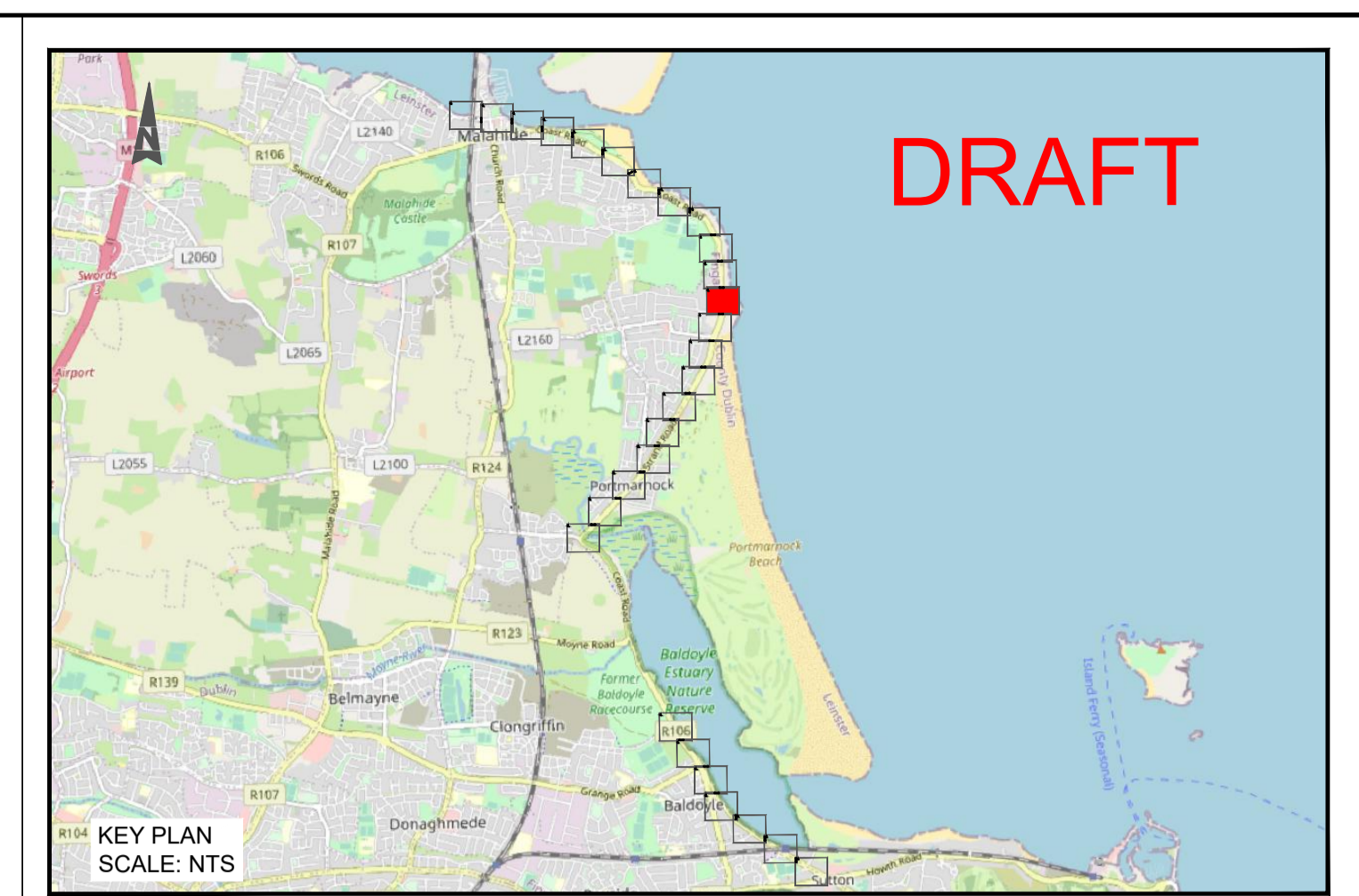
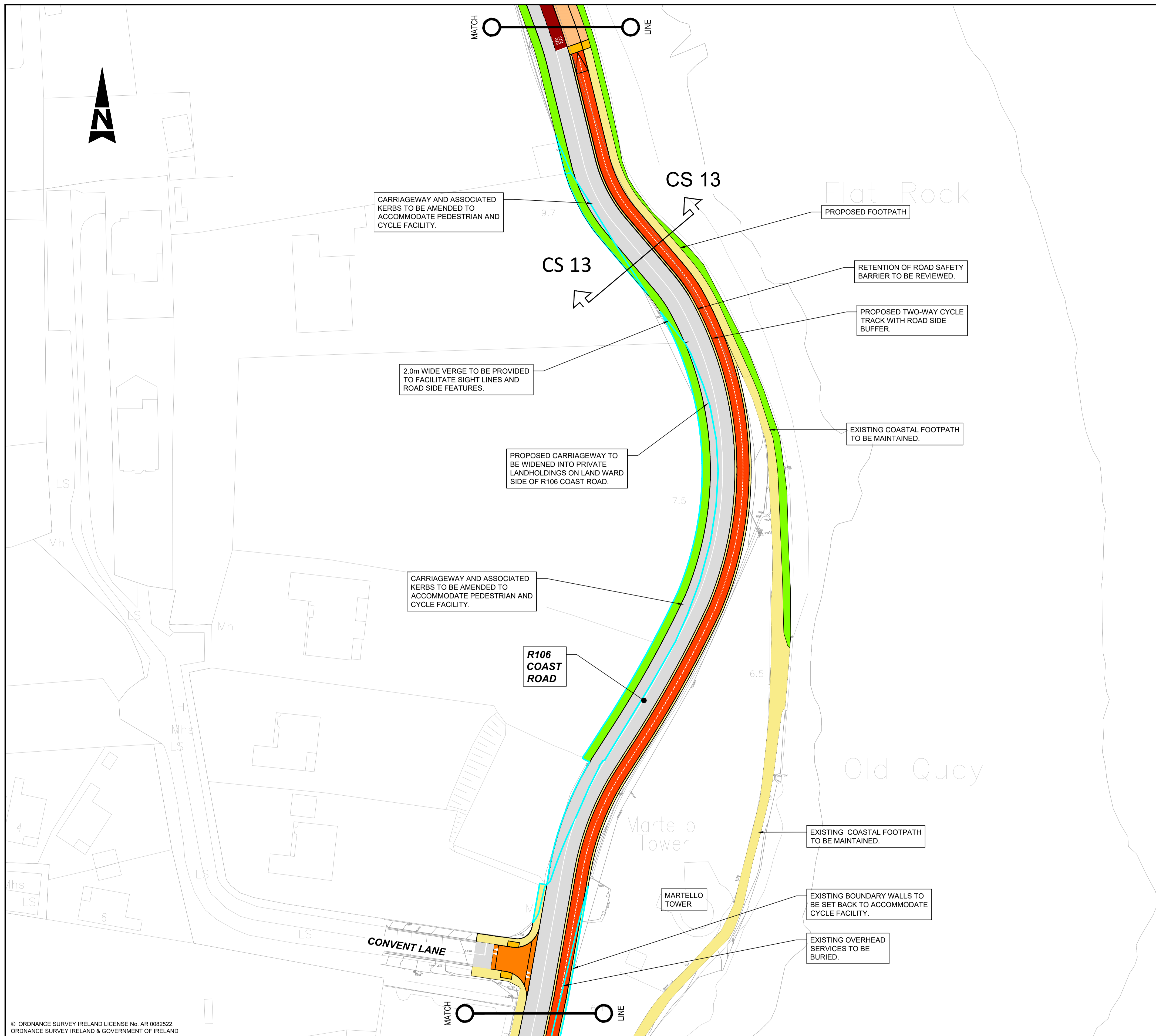

**LEGEND:**

	CYCLE TRACK		BUS STOP
	CYCLE LANE		LANDTAKE
	SHARED PATH		EXISTING TREES TO BE REMOVED
	FOOTPATH		EXISTING TREES TO BE RETAINED
	BRIDGE / BOARDWALK		CROSS SECTION
	CARRIAGEWAY		
	RAISED CROSSING		
	GRASS VERGE		
	TACTILE PAVING - CONTROLLED		
	TACTILE PAVING - UNCONTROLLED		
	SHARED STREET (HIGH QUALITY PAVEMENT)		

(NOTE: ALL COLOURS ARE INDICATIVE)

© ORDNANCE SURVEY IRELAND LICENSE No. AR 0082522  
ORDNANCE SURVEY IRELAND & GOVERNMENT OF IRELAND



Rev	Description	By	Date	Chk'd	Auth
D	DRAFT	AK	21.03.22	PF	PF
C	DRAFT	AK	16.03.22	PF	PF
B	DRAFT	AK	14.03.22	PF	PF
A	DRAFT	AK	22.02.22	CF	CF
-	DRAFT	AK	07.02.22	CF	CF



Atkins House, 150-155 Almside Business Park, Swords, Co. Dublin  
Tel (+353) 01 810 8000 Fax (+353) 01 810 8001

Unit 2B, 2200 Cork Airport Business Park, Cork  
Tel (+353) 021 429 0300 Fax (+353) 021 429 0360

1st Floor Technology House Parkmore Technology Park, Galway  
Tel (+353) 091 786 050 Fax (+353) 091 779 830

Client: FINGAL COUNTY COUNCIL

Project: SUTTON TO MALAHIDE PEDESTRIAN AND CYCLE SCHEME

Purpose: PUBLIC CONSULTATION			
Title: PRELIMINARY DESIGN SHEET 12 OF 28 0112 - PORTMARNOCK			
Original Scale: 1:500 at A1 1:1000 at A3	Design/Drawn: AK	Checked: CF	Authorised: CF
Date: 07.02.22	Date: 07.02.22	Date: 07.02.22	Date: 07.02.22
Status: I	Drawing Number: 5158418 / HTR / DR / 02 / 0112	Rev: D	