

A1

DO NOT SCALE

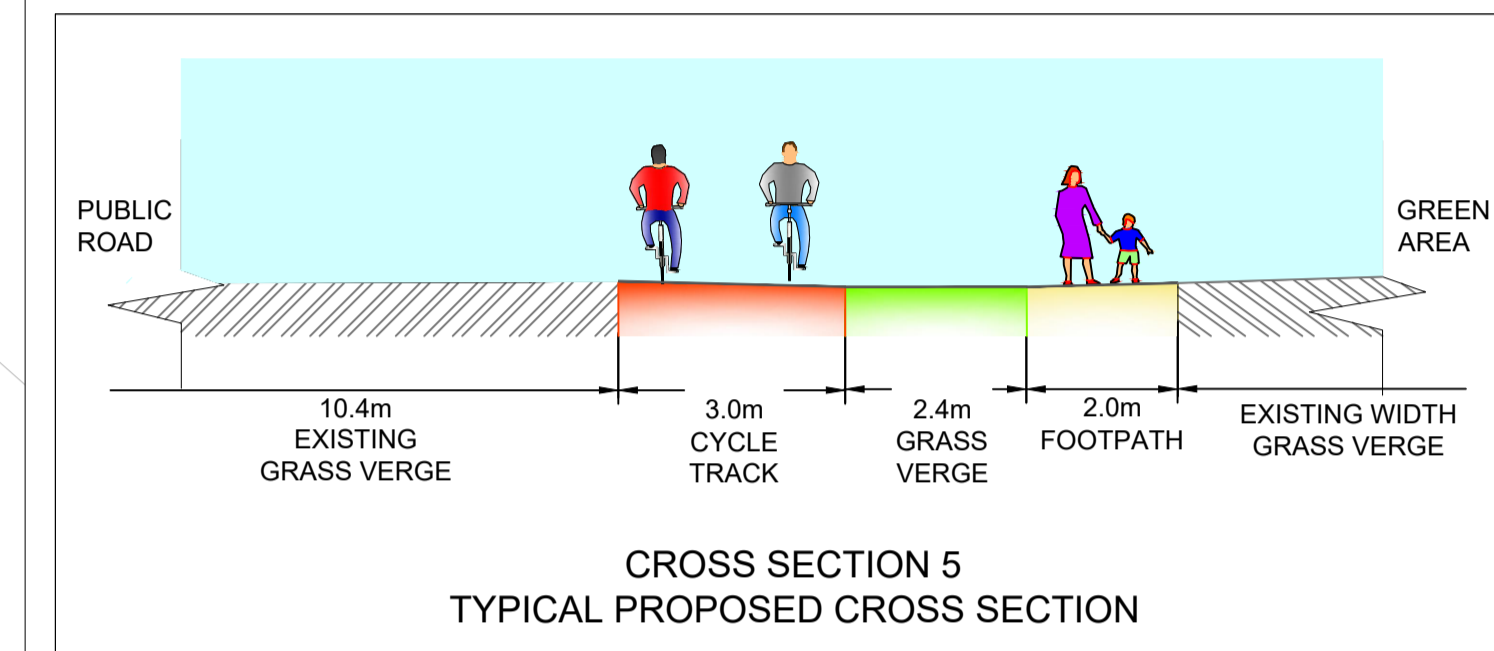
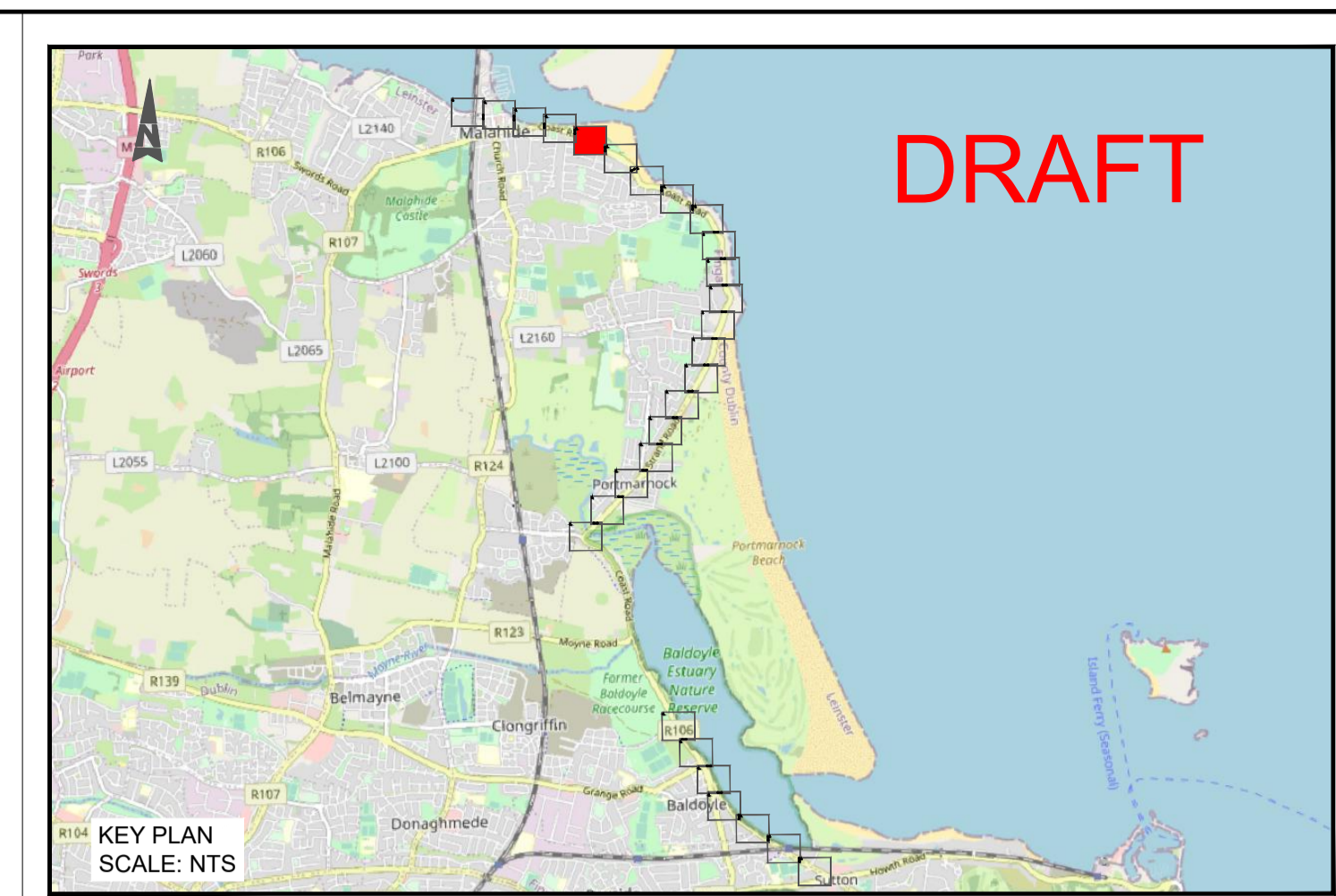
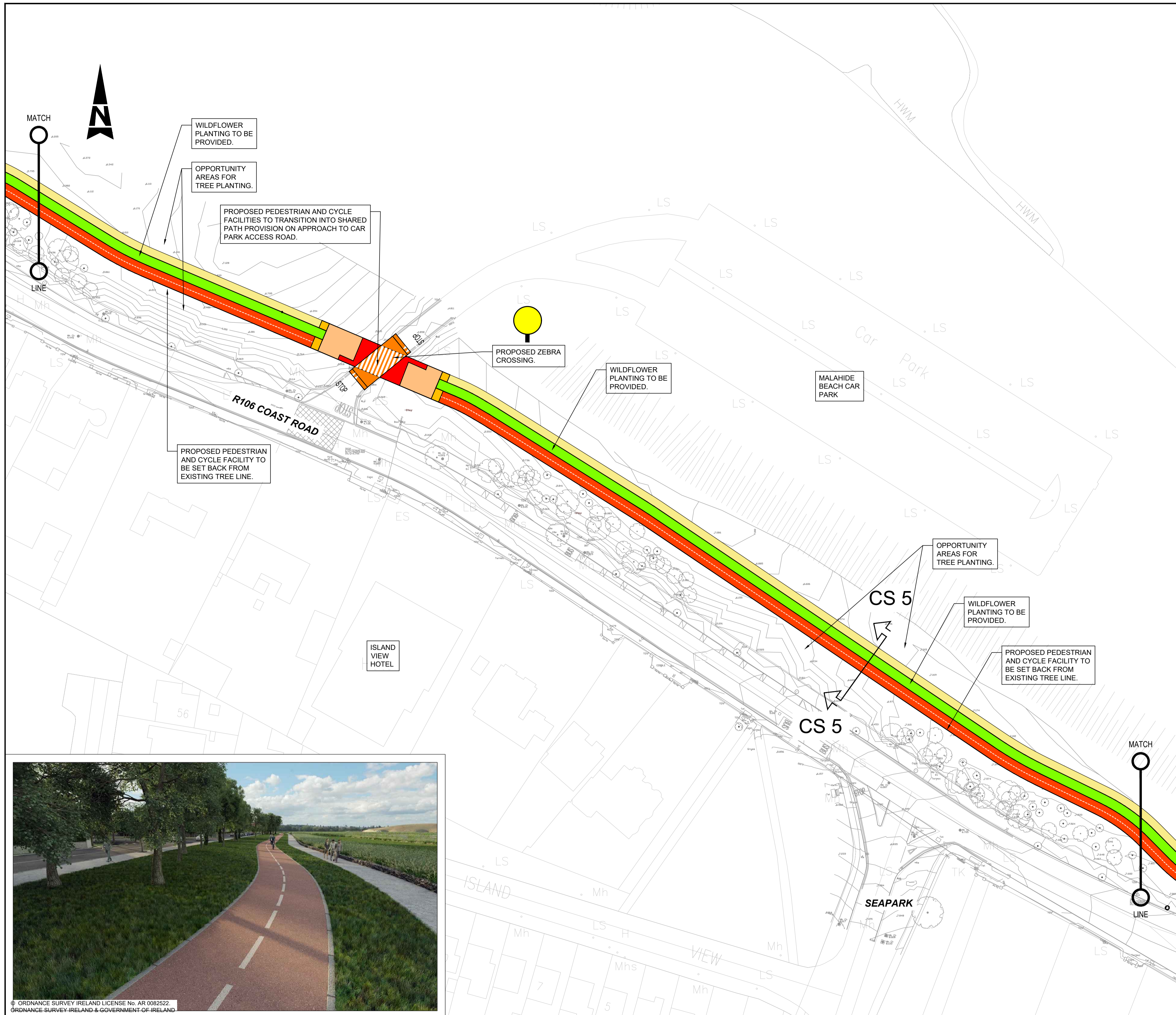

**LEGEND:**

CYCLE TRACK	BUS STOP
CYCLE LANE	LANDTAKE
SHARED PATH	EXISTING TREES TO BE REMOVED
FOOTPATH	EXISTING TREES TO BE RETAINED
BRIDGE / BOARDWALK	CROSS SECTION
CARRIAGEWAY	
RAISED CROSSING	
GRASS VERGE	
TACTILE PAVING - CONTROLLED	
TACTILE PAVING - UNCONTROLLED	
SHARED STREET (HIGH QUALITY PAVEMENT)	

(NOTE: ALL COLOURS ARE INDICATIVE)

© ORDNANCE SURVEY IRELAND LICENSE No. AR 0082522.  
 ORDNANCE SURVEY IRELAND & GOVERNMENT OF IRELAND

Comhairle Contae  
 Fhine Gall  
 Fingal County  
 Council

Rev	Description	By	Date	Chk'd	Auth
D	DRAFT	AK	21.03.22	PF	PF
C	DRAFT	AK	16.03.22	PF	PF
B	DRAFT	AK	14.03.22	PF	PF
A	DRAFT	AK	22.02.22	CF	CF
-	DRAFT	AK	07.02.22	CF	CF

**ATKINS**  
 Member of the SNC-Lavalin Group

Atkins House, 150-155 Alside Business Park, Swords, Co. Dublin  
 Tel (+353) 01 810 8000 Fax (+353) 01 810 8001

Unit 2B, 2200 Cork Airport Business Park, Cork  
 Tel (+353) 021 429 0300 Fax (+353) 021 429 0360

1st Floor Technology House Parkmore Technology Park, Galway  
 Tel (+353) 091 786 050 Fax (+353) 091 779 830

Client: FINGAL COUNTY COUNCIL

Project: SUTTON TO MALAHIDE PEDESTRIAN AND CYCLE SCHEME

Purpose: PUBLIC CONSULTATION			
Title: PRELIMINARY DESIGN SHEET 5 OF 28 0105 - MALAHIDE			
Original Scale: 1:500 at A1 1:1000 at A3	Design/Drawn: AK	Checked: CF	Authorised: CF
Date: 07.02.22	Date: 07.02.22	Date: 07.02.22	Date: 07.02.22
Status: I	Drawing Number: 5158418 / HTR / DR / 02 / 0105	Rev: D	

File: 5158418\_HTR\_DR\_02\_0101-0128(COMBINED).dwg  
 Date: Mar 21, 2022 - 7:57pm  
 Plotted by: AKoyobolisev