

HT C1 2B/4P/2S/ end unit

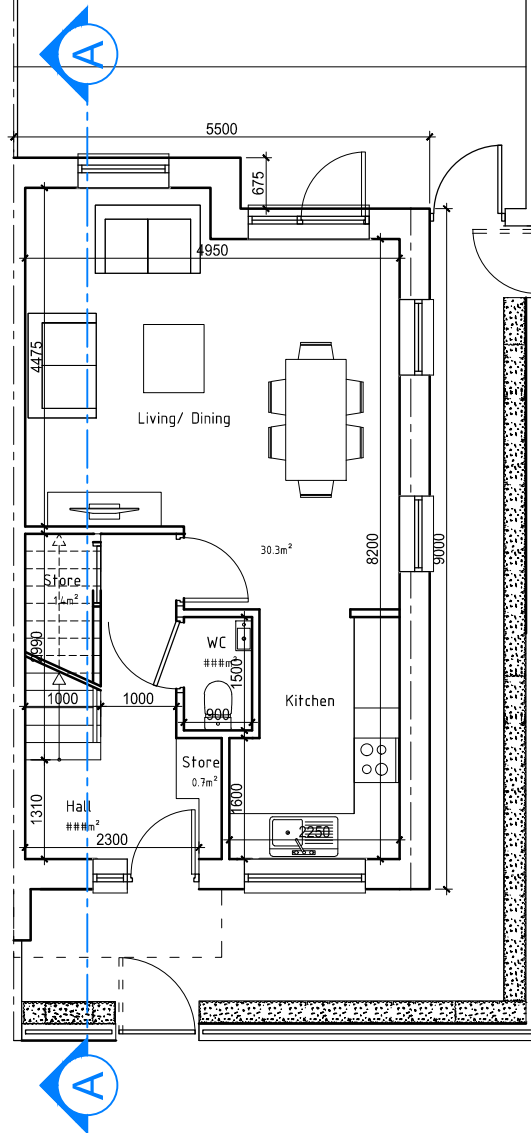

House Type C1
Proposed Ground Floor
 Scale 1:100 @ A3

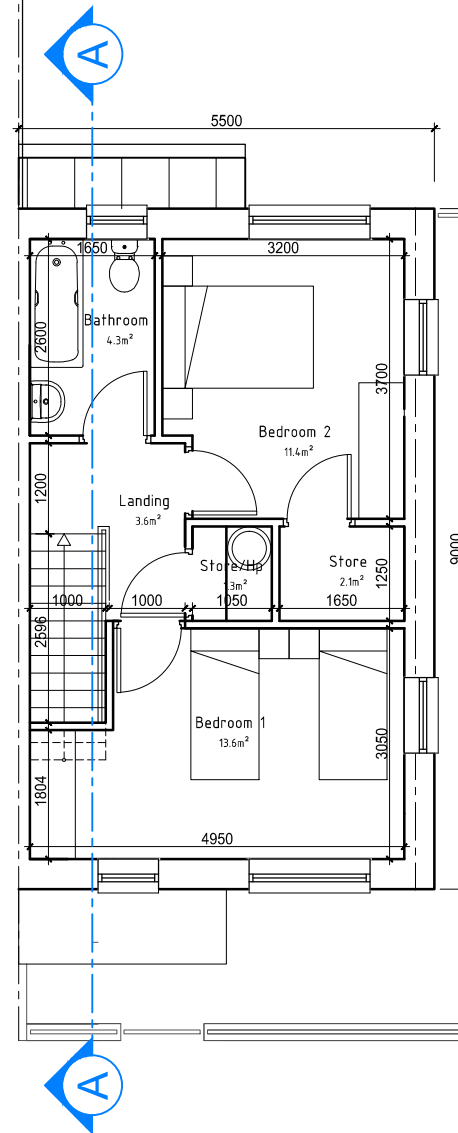

House Type C1
Proposed First Floor
 Scale 1:100 @ A3

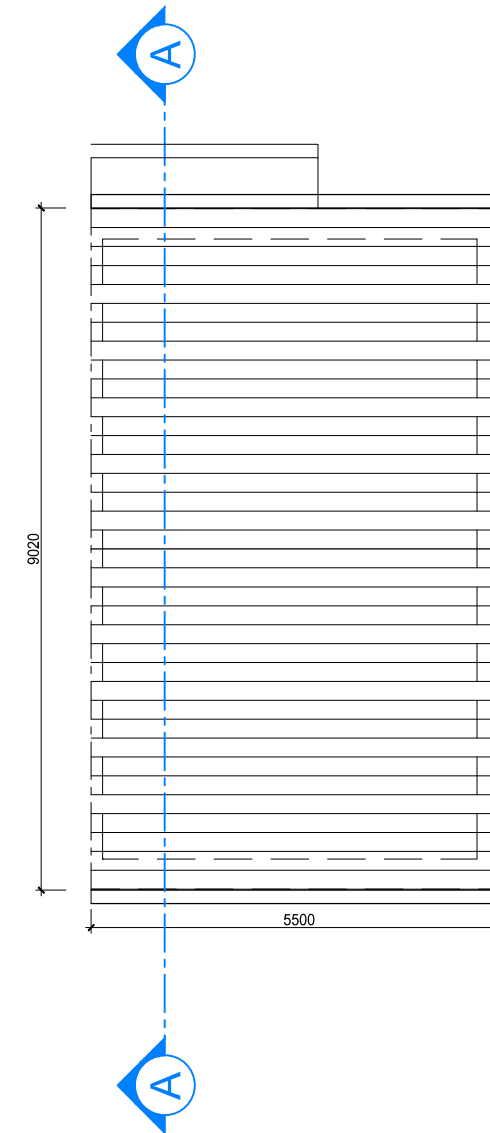

House Type C1
Proposed Roof Floor
 Scale 1:100 @ A3

2-BED/4P/2S eu PROPOSED HOUSE TYPE C1	proposed		required by DoE*			
9 no. on site	[m ²]		[m ²]	Bedroom 1 Area	11.4	11.4
Total Gross Area	82.8	103.5%	80	Bedroom 2 Area	13.6	13
GF Area	42.2			Aggregate Bedrooms Area	25.0	25
1st Floor Area	40.6					
Entrance hall	5.2			WC	1.4	-
Living Area	14.5		13	Bathroom	4.3	-
Kitchen & Dining	15.8		-	Aggregate Storage Area	5	4.5
Aggregate Living /Dinning/ Kitchen Area	30.3		30			

* as per Fingal Development Plan 2017-2023

REVISIONS AFTER LAST PLOT:

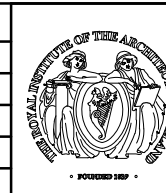

PROJECT: Part XI Church Fields Housing and Eastern Linear Park Development	DATE: Oct21	SCALE: 1:100@A3
DRAWN: RN	JOB NO. 20009	DWG. NO. P-032
DRAWING: House Type C1 (2-BED/4P/2S/end unit) PLANS	Stage: PLANNING	Revision:
walsh associates ARCHITECTS & PROJECT MANAGERS <small>Copyright © 2003 Walsh Associates All Rights Reserved.</small>		
Merchants House, 27-30 Merchants Quay, Dublin 8. Tel: (01) 633 4261. Fax: (01) 633 4265 Email: info@walshassociates.ie		