

HT B2 3B/5P/2S/

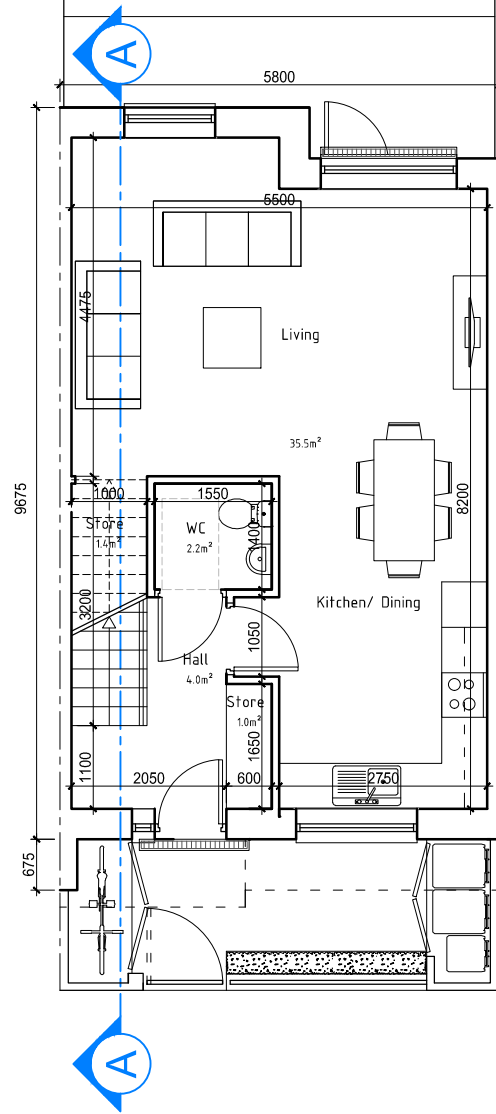

House Type B2
Proposed Ground Floor
 Scale 1:100 @ A3

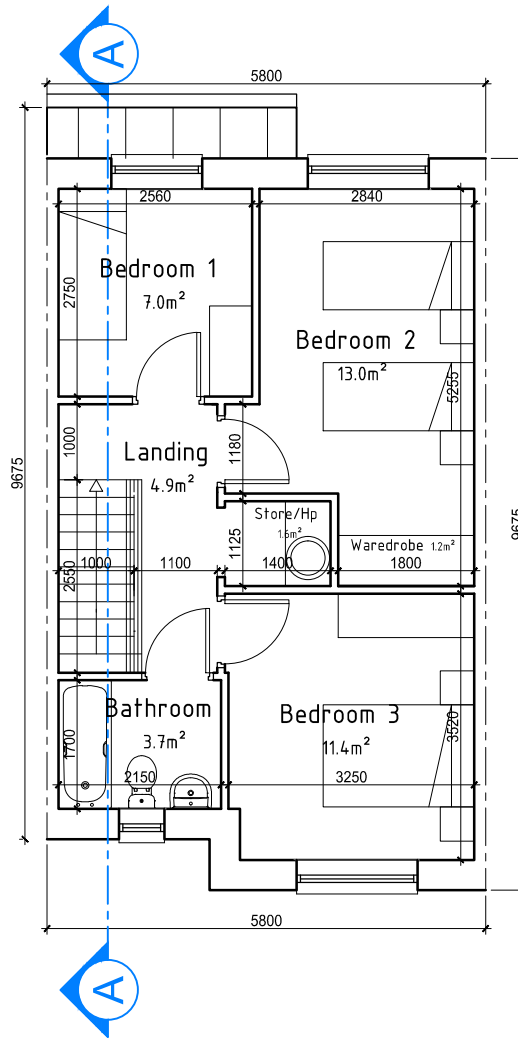

House Type B2
Proposed First Floor
 Scale 1:100 @ A3

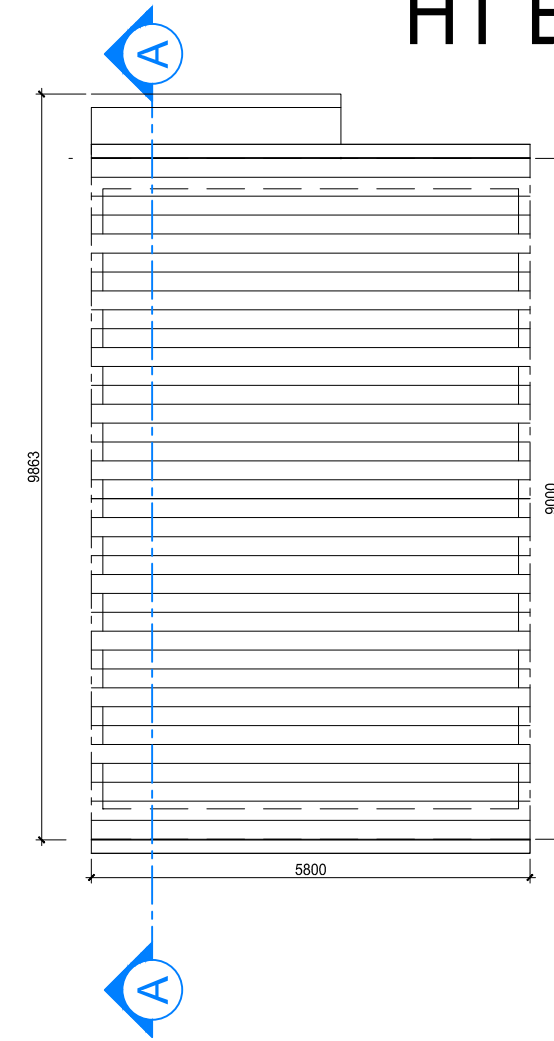

House Type B2
Proposed Roof Floor
 Scale 1:100 @ A3

3-BED/5P/2S dis PROPOSED HOUSE TYPE B2	proposed		required by DoE*			
60 no. on site	[m²]		[m²]	Bedroom 1 Area	7.1	7.1
Total Gross Area	94.2	102.4%	92	Bedroom 2 Area	13.0	11.4
<i>GF Area</i>	47.0			Bedroom 3 Area	11.4	13
<i>1st Floor Area</i>	47.2		-	Aggregate Bedrooms Area	31.5	32
Entrance hall	4.0		-	WC	2.2	-
Living Area	22.7		13	Bathroom	3.7	-
Kitchen & Dining	12.8		-	Aggregate Storage Area	5.2	5
Aggregate Living /Dinning/ Kitchen Area	35.5		34			

* as per Fingal Development Plan 2017-2023

REVISIONS AFTER LAST PLOT:

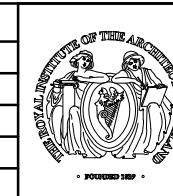

PROJECT: Part XI Church Fields Housing and Eastern Linear Park Development	DATE: Oct21	SCALE: 1:100@A3
DRAWN: RN	JOB NO. 20009	DWG. NO. P-028
DRAWING: House Type B2 (3-BED/5P/2S) PLANS	Stage: PLANNING	Revision:
walsh associates ARCHITECTS & PROJECT MANAGERS <small>Copyright © 2003 Walsh Associates All Rights Reserved.</small>		
Merchants House, 27-30 Merchants Quay, Dublin 8. Tel: (01) 633 4261. Fax: (01) 633 4265 Email: info@walshassociates.ie		