

# HT A2 4B/7P/3S/side entrance

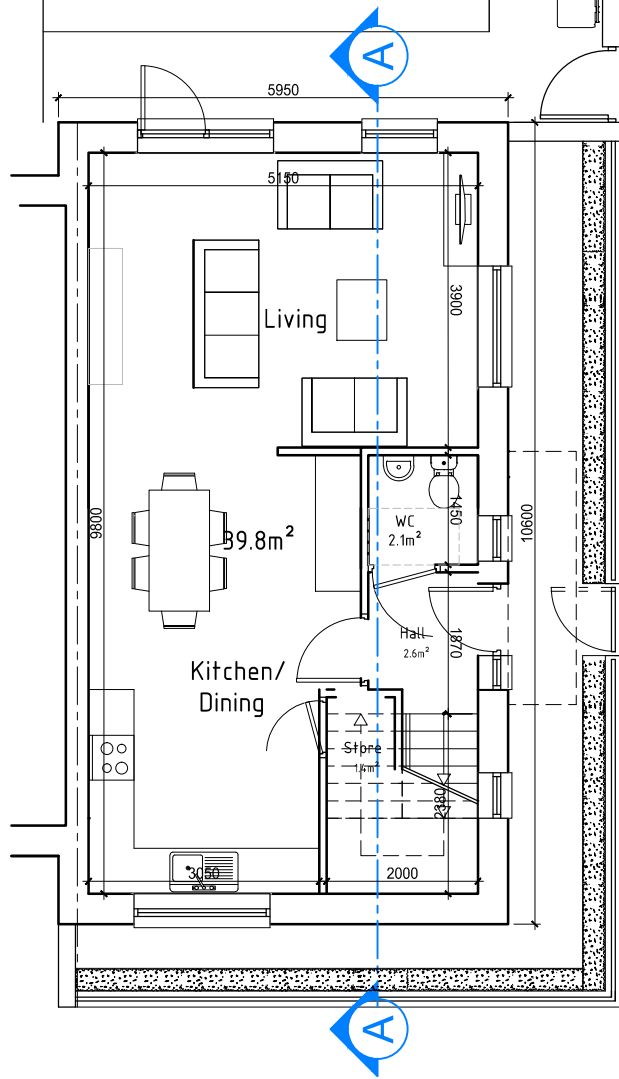

**House Type A2**  
**Proposed Ground Floor**  
 Scale 1:100 @ A3

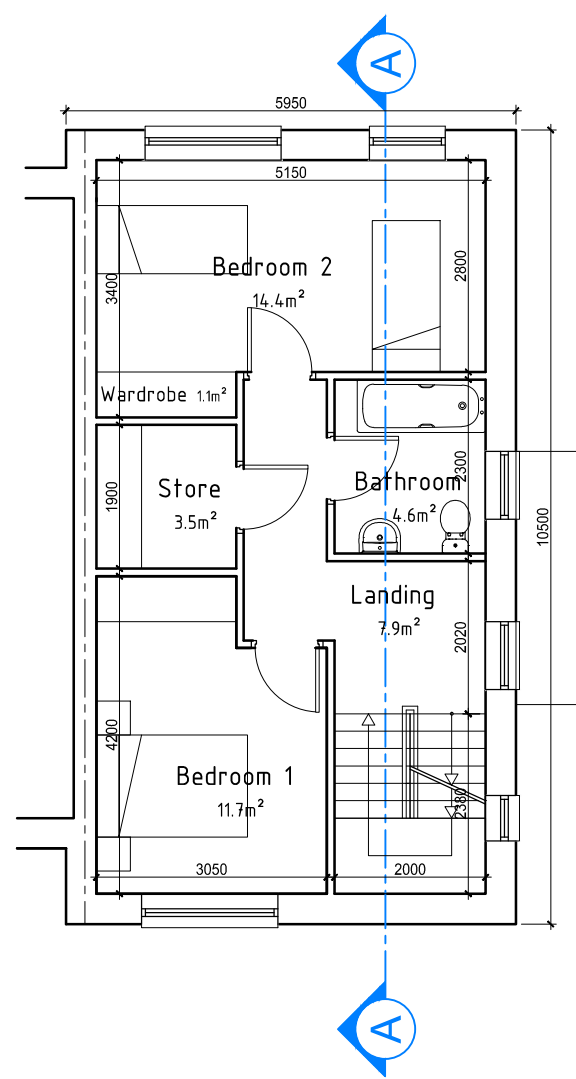

**House Type A2**  
**Proposed First Floor**  
 Scale 1:100 @ A3

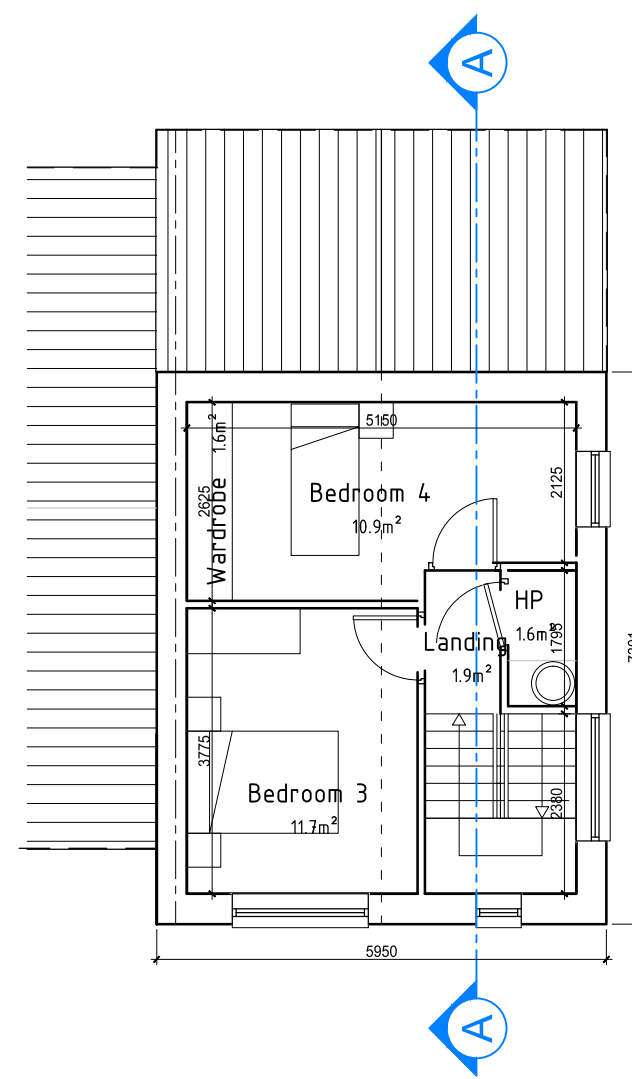

**House Type A2**  
**Proposed Second Floor**  
 Scale 1:100 @ A3

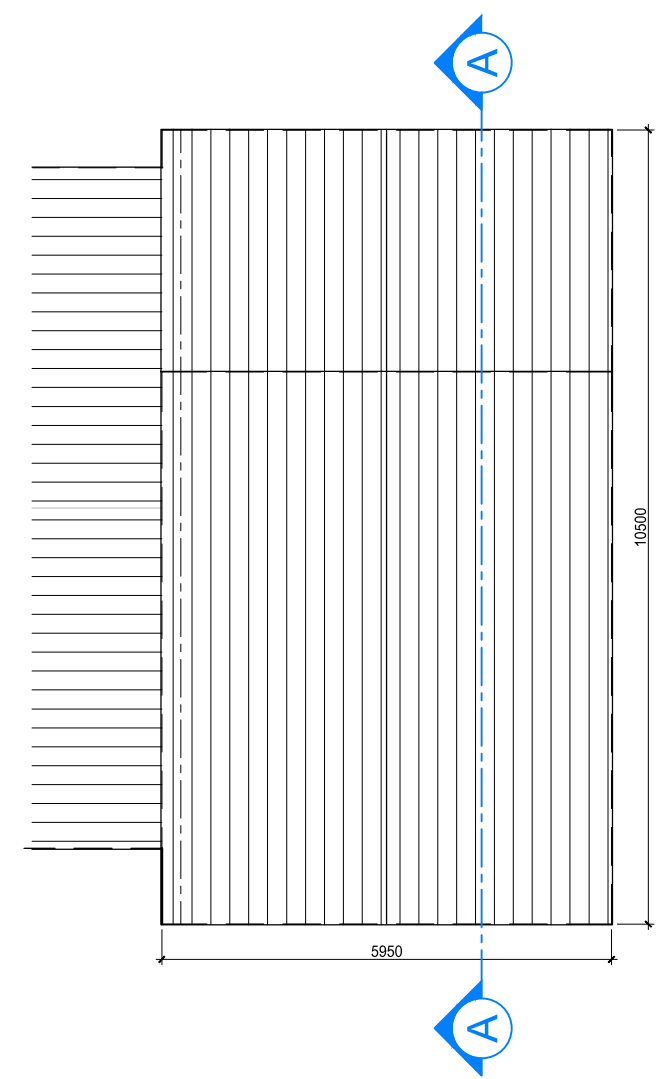

**House Type A2**  
**Proposed Roof Plan**  
 Scale 1:100 @ A3

4-BED/7P/3S SE PROPOSED HOUSE TYPE A2		proposed	required by DoE*			
6 no. on site	[m²]		[m²]	Bedroom 1 Area	11.7	11.4
Total Gross Area	133.5	111.2%	120	Bedroom 2 Area	14.4	13
GF Area	50.0			Bedroom 3 Area	10.8	7.1
1st Floor Area	50.0			Bedroom 4 Area	11.7	11.4
2nd Floor Area	33.5		-	Aggregate Bedrooms Area	44.3	43
Entrance hall	2.6		-	WC	2.1	-
Living Area	20.1		15	Bathroom	4.6	-
Kitchen & Dining	19.7		-	Aggregate Storage Area	7.4	6
Aggregate Living /Dinning/ Kitchen Area	39.8		40			

\* as per Fingal Development Plan 2017-2023

REVISIONS AFTER LAST PLOT:	

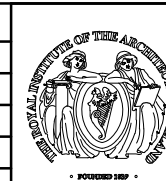

PROJECT: Part XI Church Fields Housing and Eastern Linear Park Development	DATE: Oct21	SCALE: 1:100@A3
DRAWING: House Type A2 (4-BED/7P/3S/side entrance) PLANS	DRAWN: RN	JOB NO. 20009
	K:DR/20009/P	DWG. NO. P-022
	Stage: PLANNING	Revision:
<b>walsh associates</b> ARCHITECTS & PROJECT MANAGERS <small>Copyright © 2003 Walsh Associates All Rights Reserved.</small>		Merchants House, 27-30 Merchants Quay, Dublin 8. Tel: (01) 633 4261. Fax: (01) 633 4265 Email: info@walshassociates.ie