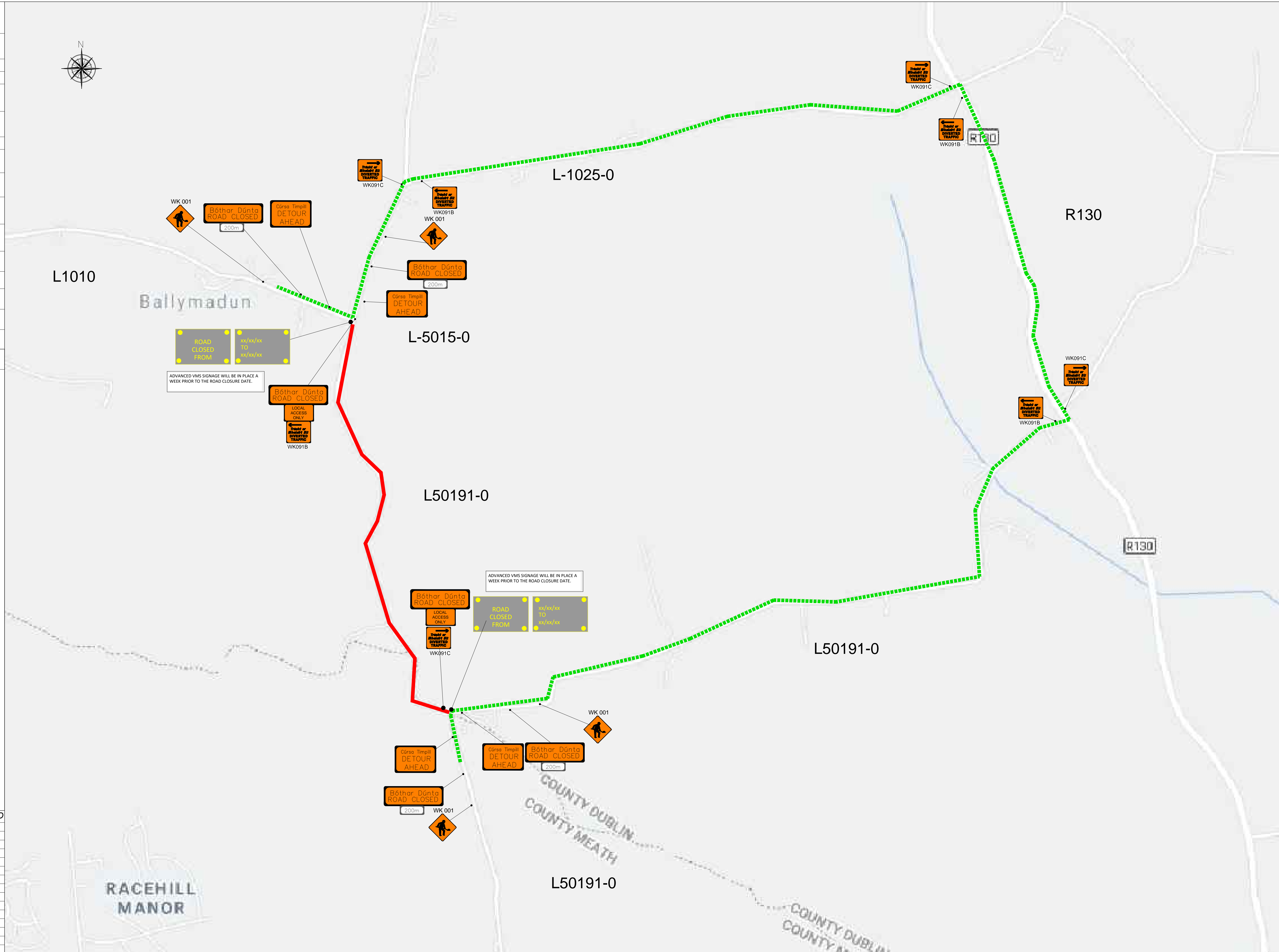

[illegible]

LEGEND:

- EXISTING ROAD MARKINGS
- EXTENT OF PROPOSED WORK AREA
- EXTENT OF PROPOSED SAFETY ZONE
- EXTENT OF PROPOSED TAPER
- TRAFFIC CONE
- MASS GUARD FENCING
- PEDESTRIAN BARRIERS
- PEDESTRIAN ROUTE
- EXISTING ON STREET PARKING
- EXISTING ON STREET TAXI RANK
- EXISTING BUS STOP
- PROPOSED TEMPORARY BUS STOP (TO BE CONFIRMED WITH DUBLIN BUS)

SIGNAGE:

- W002
- W003
- W001
- W183
- W000
- W001
- RUS 001
- RUS 002
- P 003L
- P 003R
- P 010

SITE ACCESS TO LEFT/RIGHT:

THESE SIGNS SHOULD BE USED TO INDICATE THE POSITION OF A SITE ENTRANCE AND/OR EXIT TO THE LEFT/RIGHT. SITE ACCESS ENTRANCE AND/OR EXIT LOCATIONS TO BE AGREED BY THE T.T.O.S. ON SITE.

PROPOSED SAFETY & SITE BARRIERS:

- SAFETY CONE
- SAFETY BARRIER
- SZ: SAFETY ZONE MASS GUARD PEDESTRIAN BARRIER OR SIMILAR APPROVED
- SF: SITE FENCING HERAS FENCING OR SIMILAR APPROVED
- SF: SITE FENCING NO BASE (0.00m)

PROJECT:

PHASE:

DWG No: **Route C-Road Closure Archerstown Rd-TMP-01**

REVISION: **Rev 01** DRAWN BY: **DC**

SCALE: **As Shown @ A3** DATE: **02.11.2020**