

Design Parameters:

1. Statutory Speed of the Road - 50/h
2. Distance between Advance Signs: 25 m
3. Number of Advance Signs: 3 No
4. Minimum Visibility of Signs: 50 m
5. Longitudinal Safety Zone: 25m
6. Lateral Safety Zone: 0.5m
7. Leading Taper: 45 deg
8. Maximum at Tapers Cone Space: 1m
9. Maximum Longitudinal Cone Space: 6m

Note:

1. All signs to comply with Chapter 8 of the "Traffic Signs Manual"-Guidance Document.
2. All Traffic Management to be carried out in accordance with Chapter 8 of the "Traffic Signs Manual".
3. Detailed Risk Assessment to be carried out prior to the installation of Traffic Management System.
4. The Contractor shall be responsible for providing all required ramp access to all changes in road surface level where traffic runs on a temporary surface and also for cycle/pedestrian ramps where footpath, cycle paths or any surface which has a level discontinuity as a result of the works.
5. Exact sign positions to be agreed on site.
6. All safety zones to be maintained at all times.
7. All affected Parties and an Garda Siochana to be notified prior to works commencing.
8. Signs to be positioned so as not to cause an obstruction to other road users.
9. Minimum lane width of 3 m to be maintained at all times.

10. All signs to be 600 X 600mm and faced with retro-reflective material to class ref 2 of EN 12899.
11. All delineation devices should be designed in accordance with IS EN 13422.
12. Safety barrier to be in accordance with IS EN 1317.
13. "End of Roadworks" sign placed 20m to 30m from end of works area.
14. Entrances to existing dwellings and businesses to be maintained at all times.
15. Pedestrian barriers to be used around works area if required.
18. Traffic Lights to be switched out for duration of works.
19. Pedestrian crossing to be manned and controlled in conjunction with stop and go system.

Legend

- ▲ Cones
- ▲ Diversion route
- Work Area

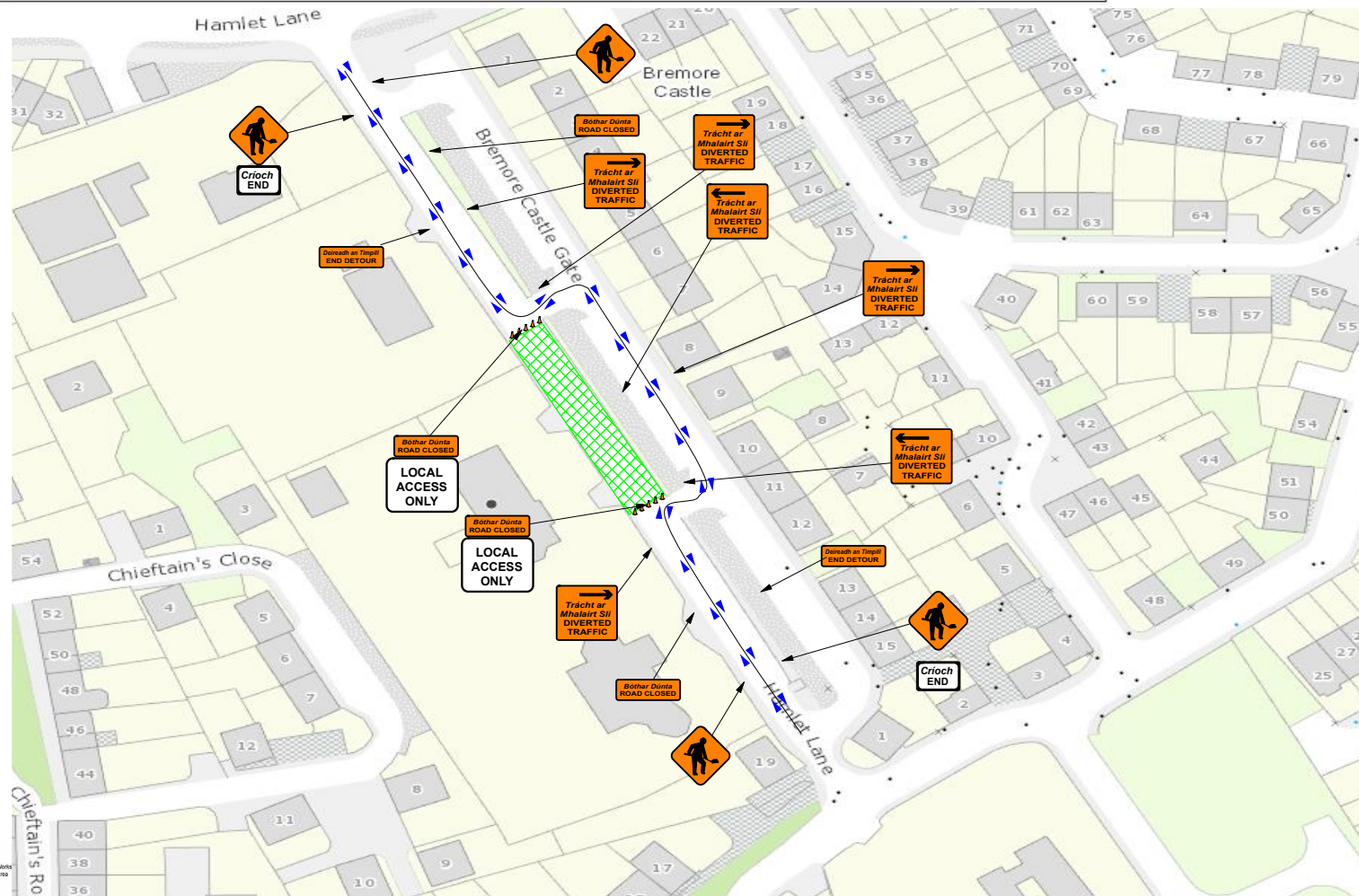
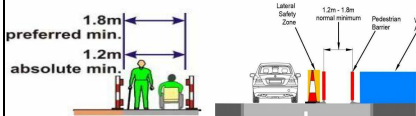
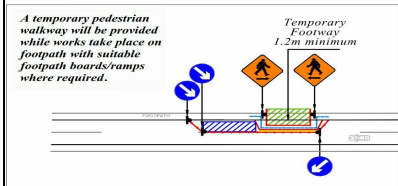

Author: TMP@SEQ.IE **Project:** 44435693 - The Warren, Hamlet Lane, Bremore, Balbriggan, Balbriggan, DUBLIN, K32AE83, IRELAND

Comments:

- Traffic coming from Bremore castle to turn right onto Bremore castle gate from Hamlet Lane, left, and left again back onto Hamlet Lane.
- Traffic coming from Hamlet Lane/Brega to turn left onto Bremore castle gate, right and right again, back onto Hamlet Lane
- Access and egress to be accommodated to local residents during these works.
- Pedestrians to be monitored and controlled by a tm operative during these works
- Suitable Ramps to be provided on site to maintain safe access to footpath for pedestrians
- TM Plan is not to scale and necessary adjustments will be made on site by SLG operative.

Balfour Beatty **clg**

On behalf of



Gas Networks Ireland

