

100  
0 10  
A1

DO NOT SCALE

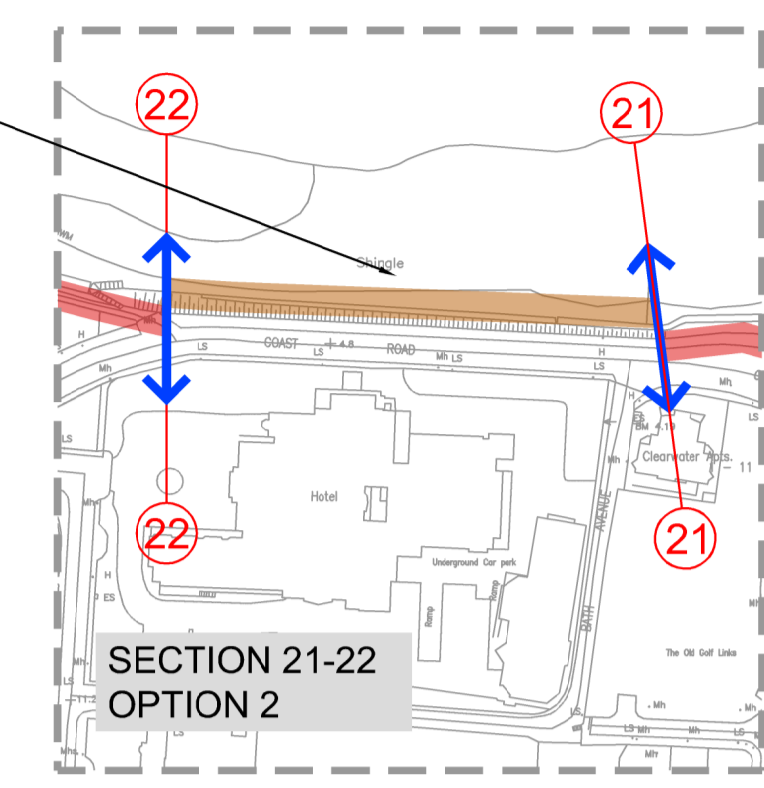
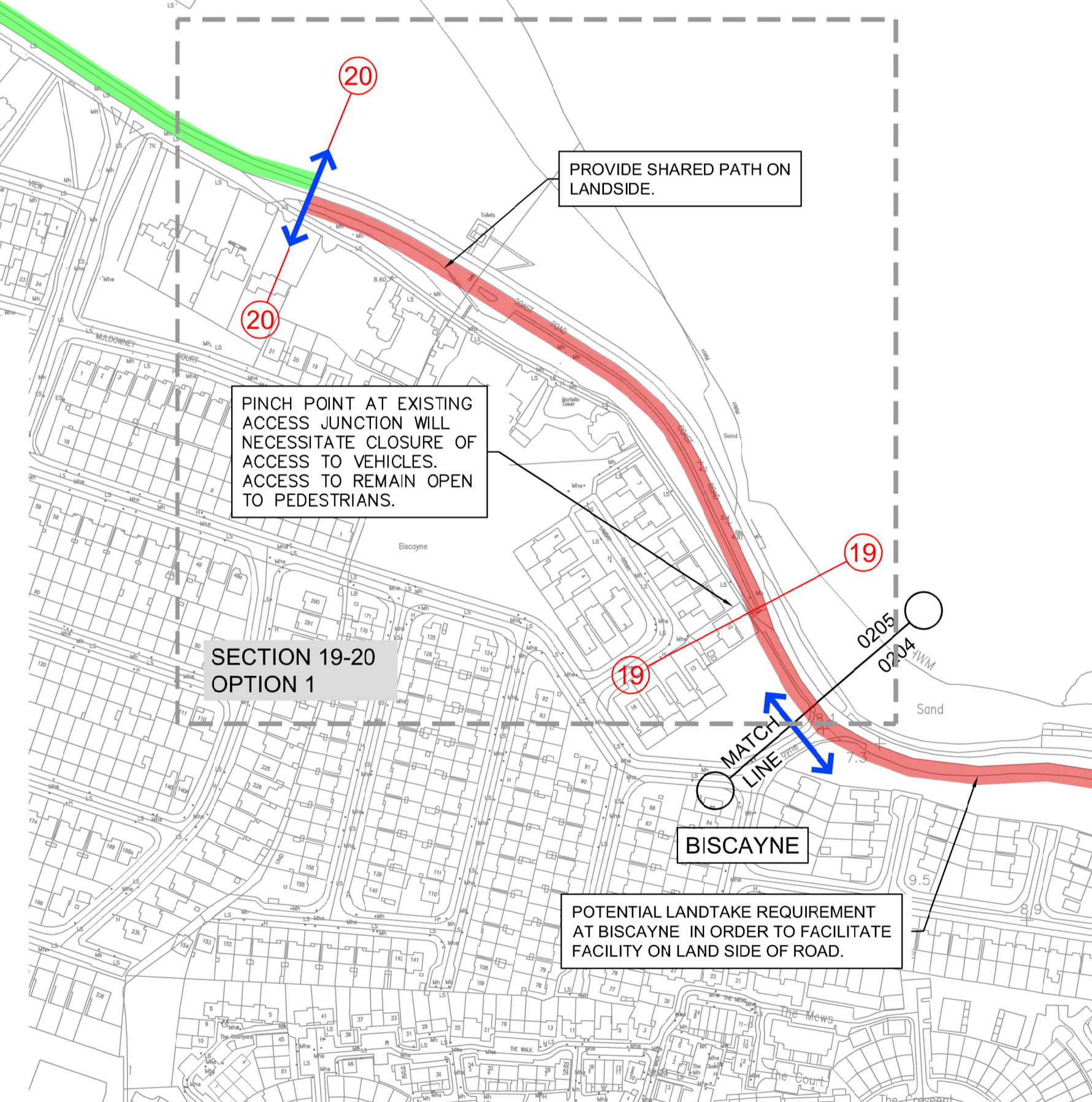
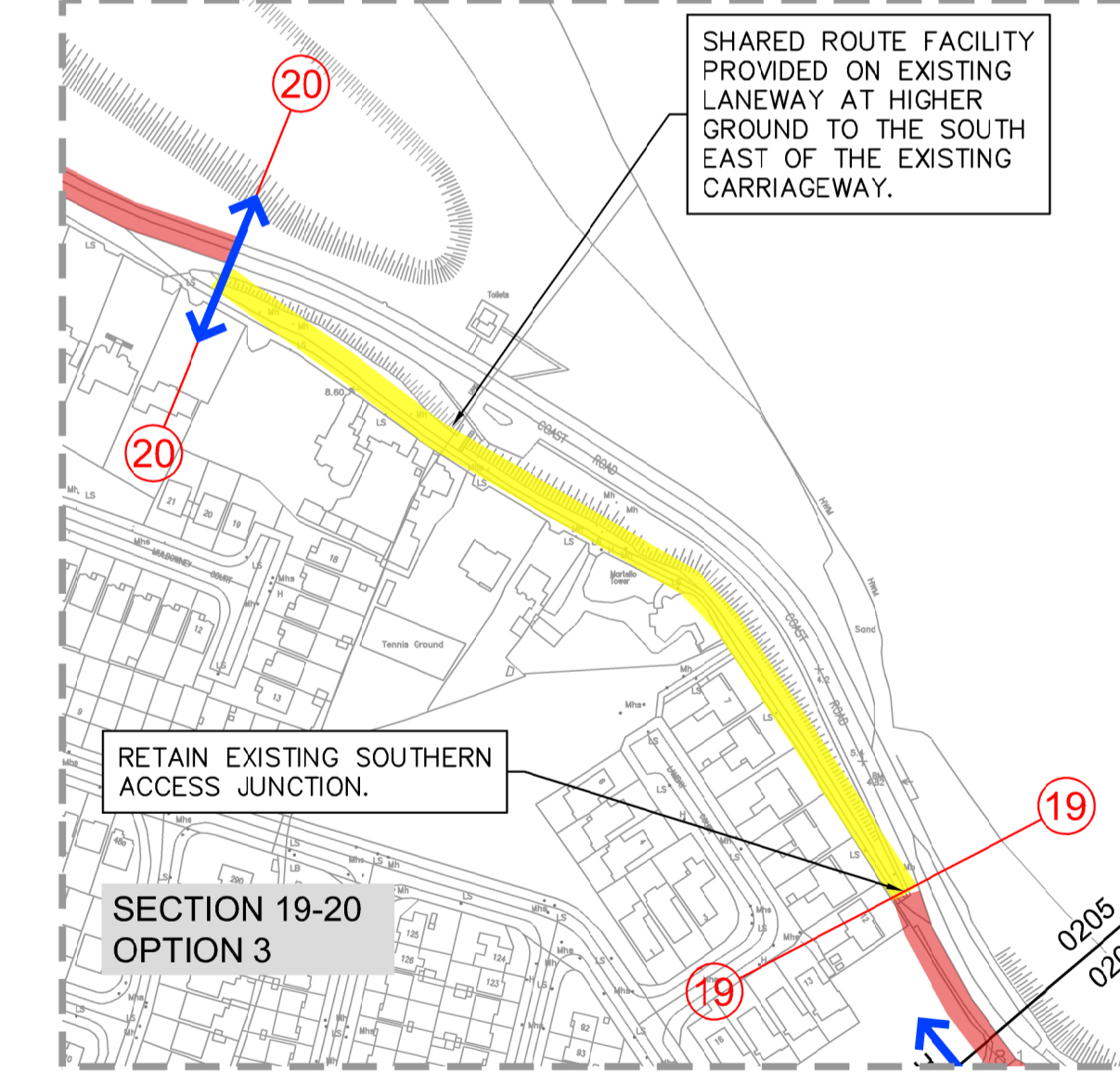
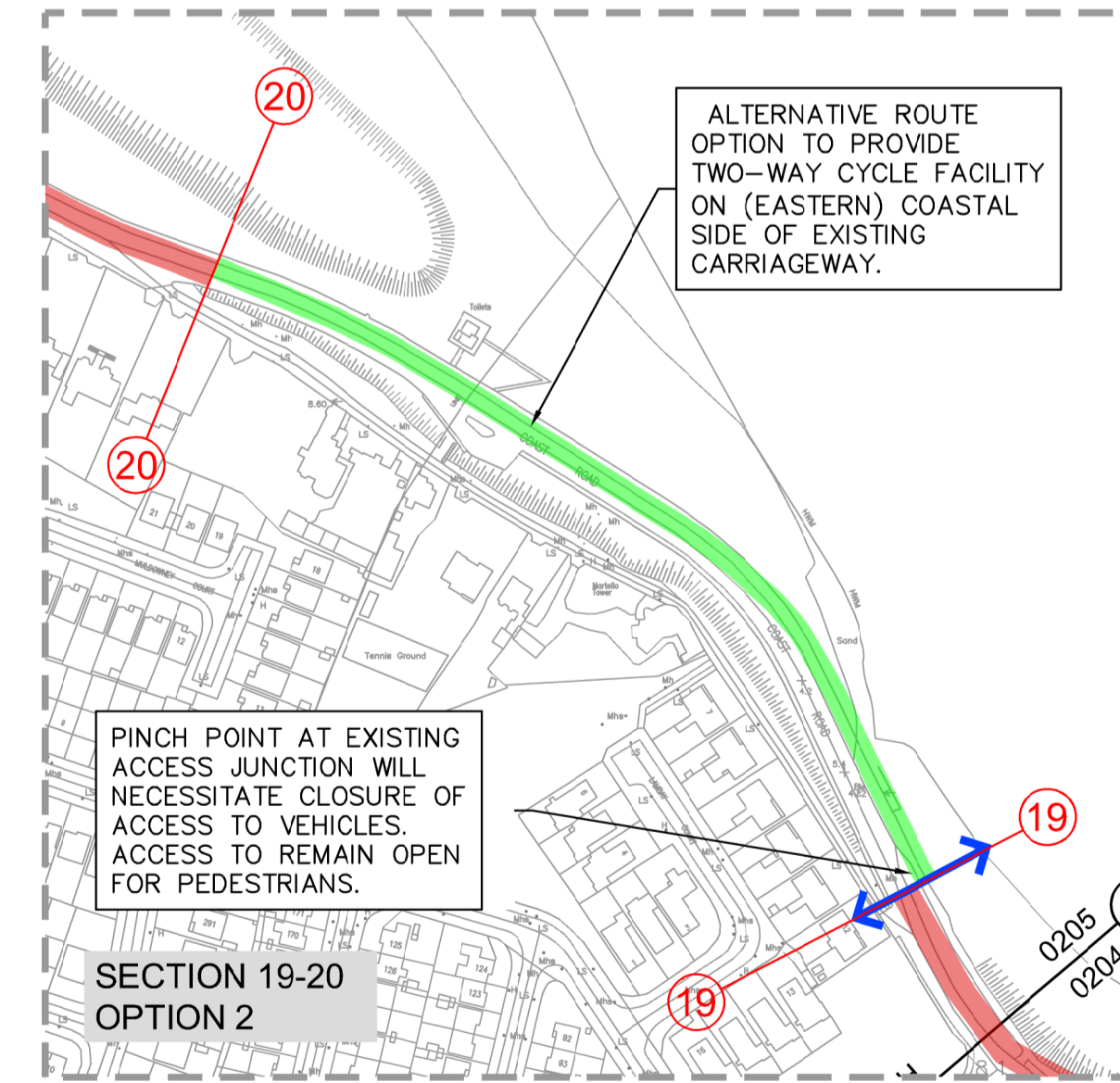
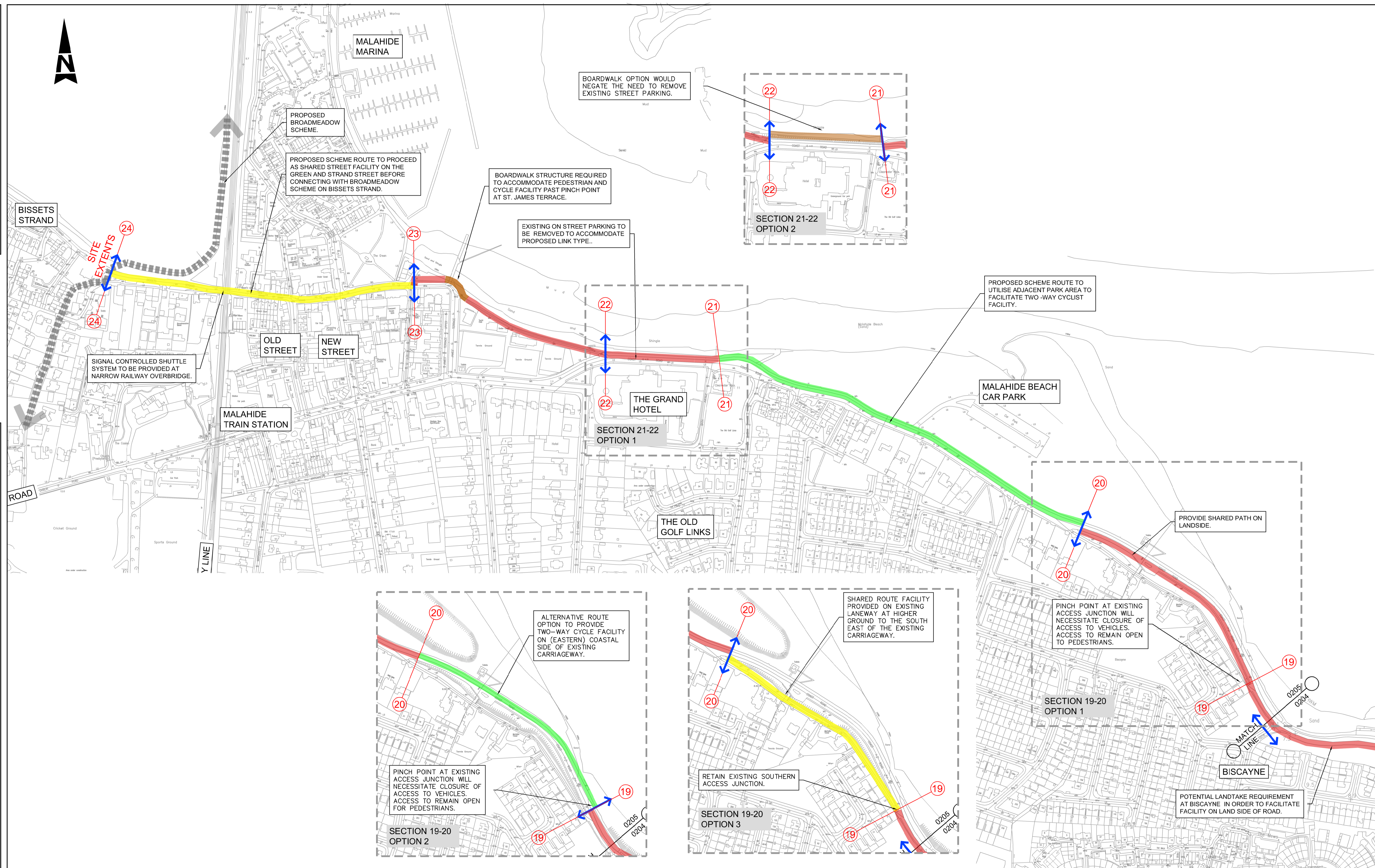

BOARDWALK OPTION WOULD NEGATE THE NEED TO REMOVE EXISTING STREET PARKING.

BOARDWALK STRUCTURE REQUIRED TO ACCOMMODATE PEDESTRIAN AND CYCLE FACILITY PAST PINCH POINT AT ST. JAMES TERRACE.

EXISTING ON STREET PARKING TO BE REMOVED TO ACCOMMODATE PROPOSED LINK TYPE..

PROPOSED SCHEME ROUTE TO UTILISE ADJACENT PARK AREA TO FACILITATE TWO-WAY CYCLIST FACILITY.

PROVIDE SHARED PATH ON LANDSIDE.

PINCH POINT AT EXISTING ACCESS JUNCTION WILL NECESSITATE CLOSURE OF ACCESS TO VEHICLES. ACCESS TO REMAIN OPEN TO PEDESTRIANS.

SHARED ROUTE FACILITY PROVIDED ON EXISTING LANEWAY AT HIGHER GROUND TO THE SOUTH EAST OF THE EXISTING CARRIAGEWAY.

RETAIN EXISTING SOUTHERN ACCESS JUNCTION.

ALTERNATIVE ROUTE OPTION TO PROVIDE TWO-WAY CYCLE FACILITY ON (EASTERN) COASTAL SIDE OF EXISTING CARRIAGEWAY.

PINCH POINT AT EXISTING ACCESS JUNCTION WILL NECESSITATE CLOSURE OF ACCESS TO VEHICLES. ACCESS TO REMAIN OPEN FOR PEDESTRIANS.

File: 5158418\_HTR\_SK\_0205.dwg  
Date: Oct 13, 2017 - 2:40pm  
Plotted by: madden

© ORDNANCE SURVEY IRELAND LICENSE No. AR 0082517.  
ORDNANCE SURVEY IRELAND & GOVERNMENT OF IRELAND



**LEGEND:**

- LINK TYPE 1 - TWO WAY CYCLE TRACK & SEGREGATED FOOTPATH
- LINK TYPE 2 - TWO WAY CYCLE TRACK
- LINK TYPE 3 - SHARED BOARDWALK
- LINK TYPE 4 - CYCLE LANES
- LINK TYPE 5 - SHARED STREET
- ↔ TOLLGATE CROSSING
- CYCLE & PEDESTRIAN BRIDGE

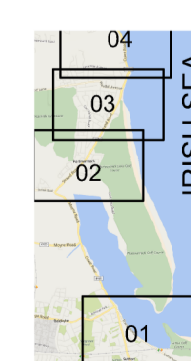

Rev	Description	By	Date	Chk'd	Auth
D	PUBLIC CONSULTATION	BH	13.10.17	CF	MD
C	NTA COMMENTS ADDRESSED	BH	10.10.17	MD	MD
B	CLIENT COMMENTS	KH	05.09.17	CF	MD
A	CLIENT COMMENTS	CMcA	2.08.17	CF	KB
-	FOR INFORMATION	RG	21.07.17	CF	KB

**ATKINS**  
WS Atkins Ireland Ltd. ©

Atkins House, 150-155 Ailside Business Park, Swords, Co. Dublin  
Tel (+353) 01 810 8000 Fax (+353) 01 810 8001

Unit 2B, 2200 Cork Airport Business Park, Cork  
Tel (+353) 021 429 0300 Fax (+353) 021 429 0360

2nd Floor Technology House Parkmore Technology Park, Galway  
Tel (+353) 091 786 0550 Fax (+353) 091 779 830

Client		Title			
FINGAL COUNTY COUNCIL		ROUTE AND LINK OPTIONS SHEET 5 OF 5			
Project		Original Scale	Design/Drawn	Checked	Authorised
SUTTON TO MALAHIDE PEDESTRIAN AND CYCLE SCHEME		1:2500 at A1 1:5000 at A3	RG	CF	MD
Status	Drawing Number	Date	Date	Date	Rev
I	5158418 / HTR / SK / 0205	21.07.17	21.07.17	21.07.17	D