

House Block Unit Type Summary

- House Type A: 2 Bedroom
4 Person, 2 Storey Terraced House, Mid Unit
- House Type B: 3 Bedroom
5 Person, 2 Storey Terraced House, Mid Unit
- House Type B2: 3 Bedroom
5 Person, 2 Storey Terraced House, End Unit
- House Type C1: 4 Bedroom
7 Person, 2 Storey End of Terraced House

Please refer to drawing House Type GA Floor plans (Drawing Series 1000) for specific unit details

Total No. of Houses in Block G : 7

PV Panels
Quantity and Roof
Locations TBC

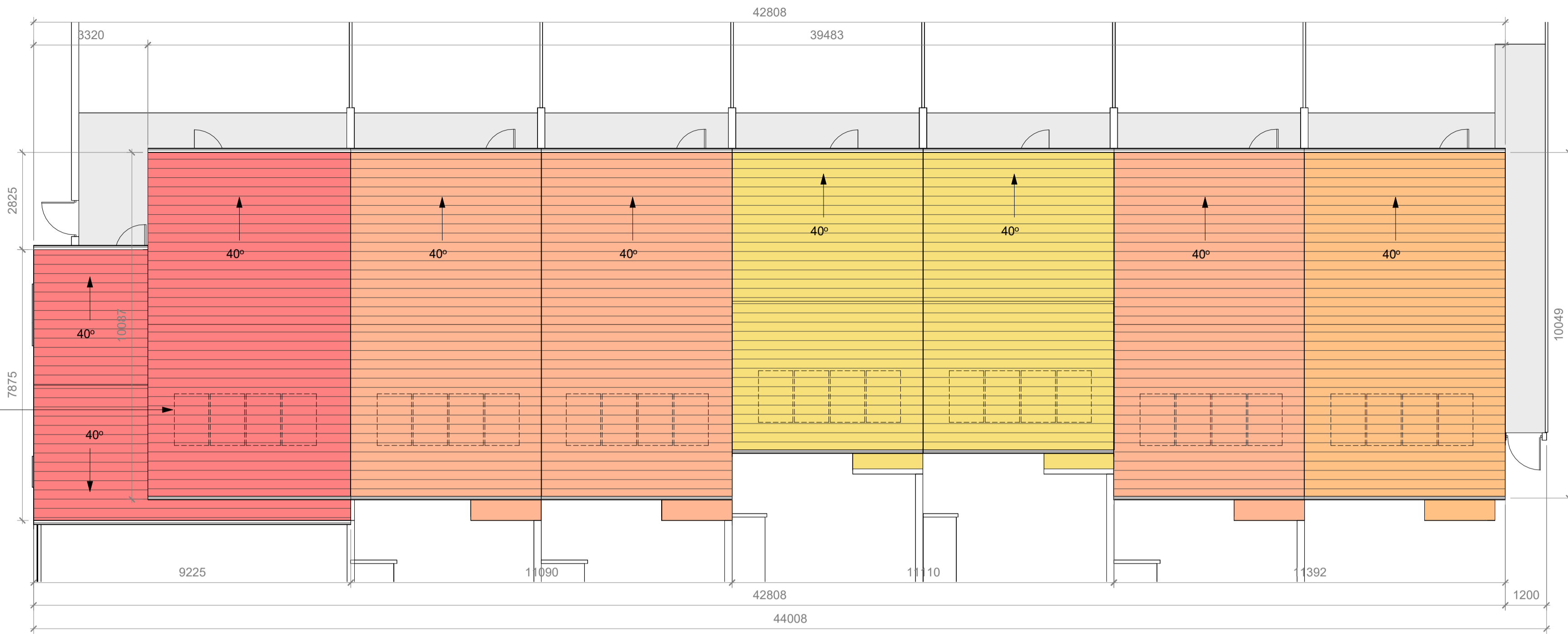

Block Type G - Typical Roof Plan

1 : 100

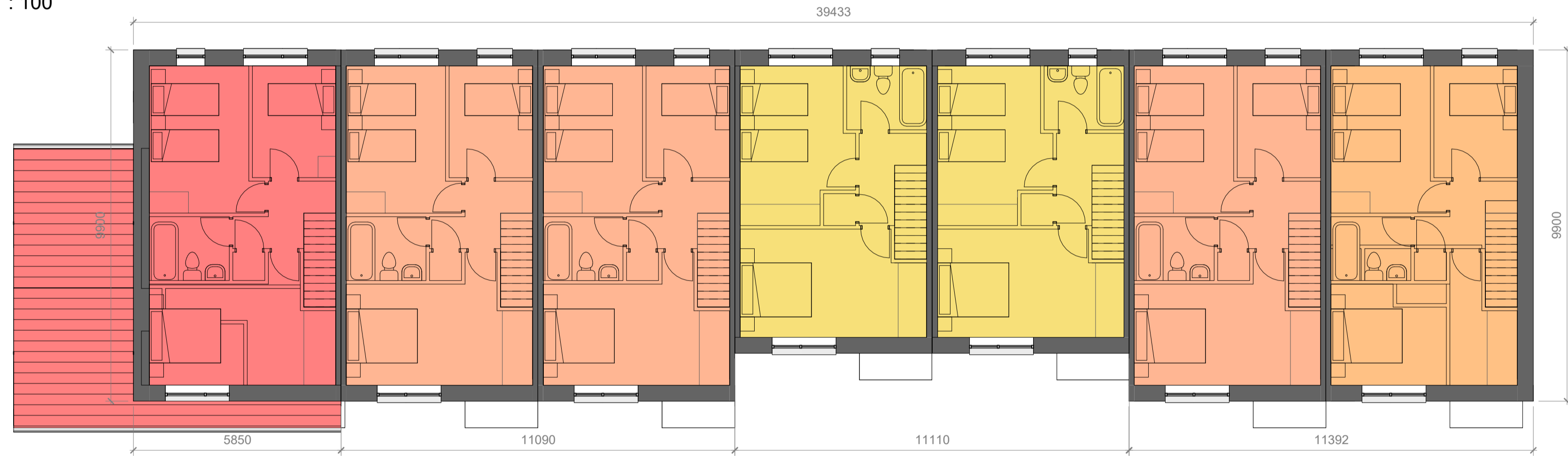

Block Type G - Typical First Floor Plan

1 : 100



Block Type G - Typical Ground Floor Plan

1 : 100

NOTE: REFER TO HOUSE TYPE DRAWINGS & SITE DEVELOPMENT PLAN FOR DETAILS ON FRONT PRIVACY STRIP AND DRIVEWAY LAYOUTS

- General Notes:**
1. USE FIGURED DIMENSIONS ONLY - DO NOT SCALE.
 2. ALL DRAWINGS TO BE READ IN CONJUNCTION WITH CIVIL, STRUCTURAL, MECHANICAL & ELECTRICAL, FIRE CONSULTANT ENGINEERS DRAWINGS & SPECIFICATIONS, AS WELL AS DAC DOCUMENTATION.
 3. ANY DISCREPANCIES TO BE BROUGHT TO ARCHITECTS ATTENTION.
 4. INFORMATION EXTRACTED FROM BIM MODELS I.E. PRINTED FORMAT TO TAKE PRECEDENCE OVER BIM MODEL.
 5. GROUND LEVELS VARY THROUGHOUT EACH BLOCK TYPE, REFER TO SITE PLAN 22-046-PP-0003 FOR SPECIFIC DETAILS ON GROUND LEVELS.

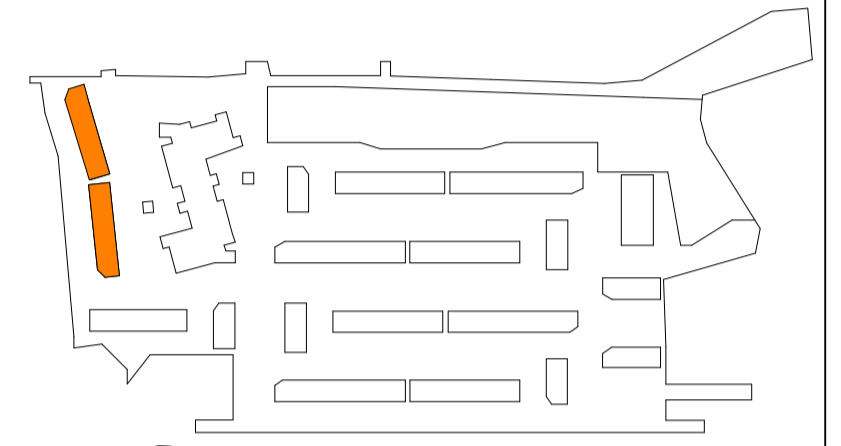

No.	Revision Description	Date

Revision Schedule		
No.	Revision Description	Date

**Comhairle Contae
Fine Gall**
Fingal County
Council

Architects Department
County Hall, Main Street, Swords, Co Dublin.

County Architect: Fionnuala May
Dip. Arch. B. Arch. Sc. MUBC MRAI

Tel: 01 890 5050
architects@fingal.ie

Client

**Fingal County Council
Housing Department**

Project Title
**Proposed New
Residential Development
at New Road, Donabate**

Drawing Title
**BLOCK TYPE G (1 & 2) -
TYPICAL GA FLOOR &
ROOF PLANS**

Project number	22-046
Project stage	P
Date	04-04-2024
Drawn by	SB
Project Architect	AP
Scale @ A1	1 : 100
Drawing number	Revision number
22-046 - P - 2601	