

**GENERAL SPECIFICATION NOTES**

- DO NOT SCALE FROM DRAWING. USE FIGURED DIMENSIONS ONLY.
- ALL WORKS TO BE CARRIED OUT IN STRICT ACCORDANCE WITH THIS DRAWING. NO CHANGES TO BE MADE ON SITE WITHOUT THE PRIOR PERMISSION OF EAMONN DOYLE ASSOCIATES.
- ALL LEVELS SHOWN ARE RELATIVE TO MALIN HEAD AOD.

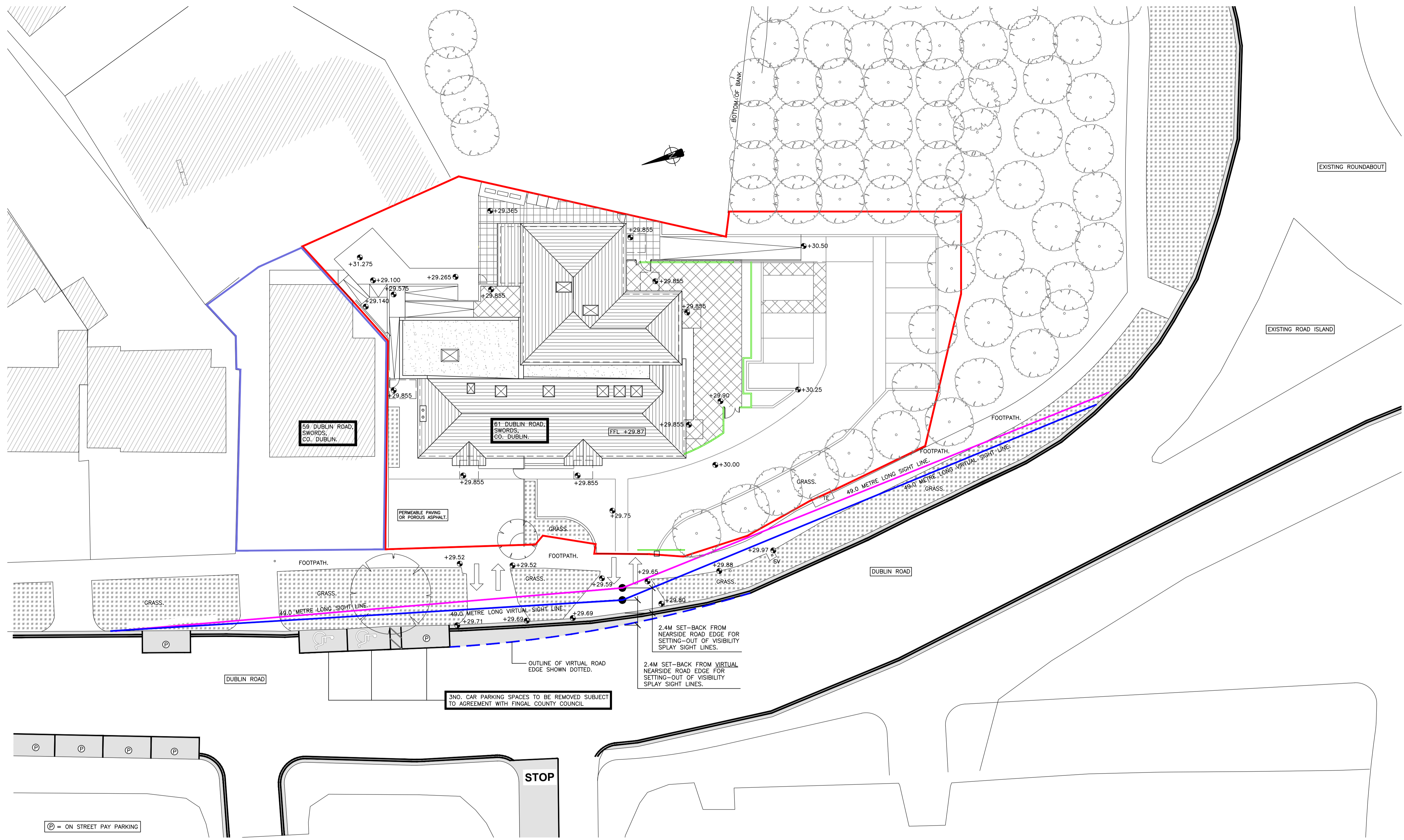

SIGHT LINES, SITE ACCESS & ROAD MARKINGS  
SCALE 1:200

REV.	DATE	AMENDMENT	DRN.	CKD.
B	21.07.21	GENERAL REVISIONS	RF	ED
A	11.05.21	GENERAL UPDATES	RF	ED

**EAMONN DOYLE ASSOCIATES**  
CONSULTING ENGINEERS  
UNIT 13, BLOCK 5  
PORT TUNNEL BUSINESS PARK  
CLONSILLAUGH  
DUBLIN 17  
D17 HY93  
PHONE: 01-8670261/62  
E-MAIL: info@edassoc.ie  
WEBSITE: www.edassoc.ie

CLIENT	ST. MICHAEL'S HOUSE		
ARCHITECT	MICHAEL MOHAN ARCHITECTS		
PROJECT	PROPOSED LOCAL DAY CARE CENTRE FOR ST. MICHAEL'S HOUSE AT 61 DUBLIN ROAD, SWORDS, CO. DUBLIN.		
TITLE	CIVIL WORKS SHEET NO.2: SIGHT LINES, SITE ACCESS & ROAD MARKINGS		
JOB No.	20-085	SCALE	AS SHOWN
DRG. No.	02	DRAWN BY	K.DUNNE
REVISION	B	CHECKED BY	E.DOYLE
DATE	11.05.2021	FOR PLANNING PURPOSES NOT FOR CONSTRUCTION	