

NOTES

- GENERAL
- 1) THESE DRAWINGS TO BE READ IN CONJUNCTION WITH ALL RELEVANT HAYES HIGGINS ENGINEERING DRAWINGS AND SPECIFICATIONS.
 - 2) DO NOT SCALE. USE FIGURED DIMENSIONS ONLY.
 - 3) FOUJL DRAINAGE SYSTEM TO RISH WATER SPECIFICATIONS (M-505-5030-01, 02 & 03)
 - 4) MAINS WATER SYSTEM TO RISH WATER SPECIFICATIONS (M-005-5020-01, 02 & 03)

DRAINAGE LEGEND

- EXISTING FOUJL SEWER COLLECTOR DEVELOPMENT
- EXISTING SURFACE WATER SEWER COLLECTOR DEVELOPMENT
- EXISTING SURFACE WATER SEWER
- PROPOSED SURFACE WATER SEWER
- EXISTING FOUJL SEWER
- PROPOSED FOUJL SEWER
- PROPOSED SURFACE WATER ACCESS JUNCTION
- PROPOSED PETROL INTERCEPTOR
- PROPOSED SURFACE WATER GULLY
- PROPOSED FOUJL SEWER ACCESS JUNCTION
- PROPOSED FOUJL SEWER INSPECTION CHAMBER
- EXISTING SURVEY LEVELS
- PROPOSED SURVEY LEVELS
- PROPOSED SITE LEVELS

NOTE: EACH PROPERTY TO HAVE SEPARATE FOUJL CONNECTIONS TO MAINS
NOTE: SECONDARY DRAINAGE TBC IN DETAILED DESIGN

PERFORABLE FRANK 350mm COARSE GRADE AGGREGATE AND PERFORATED PIPE CONNECTING TO SURFACE ATTENUATION

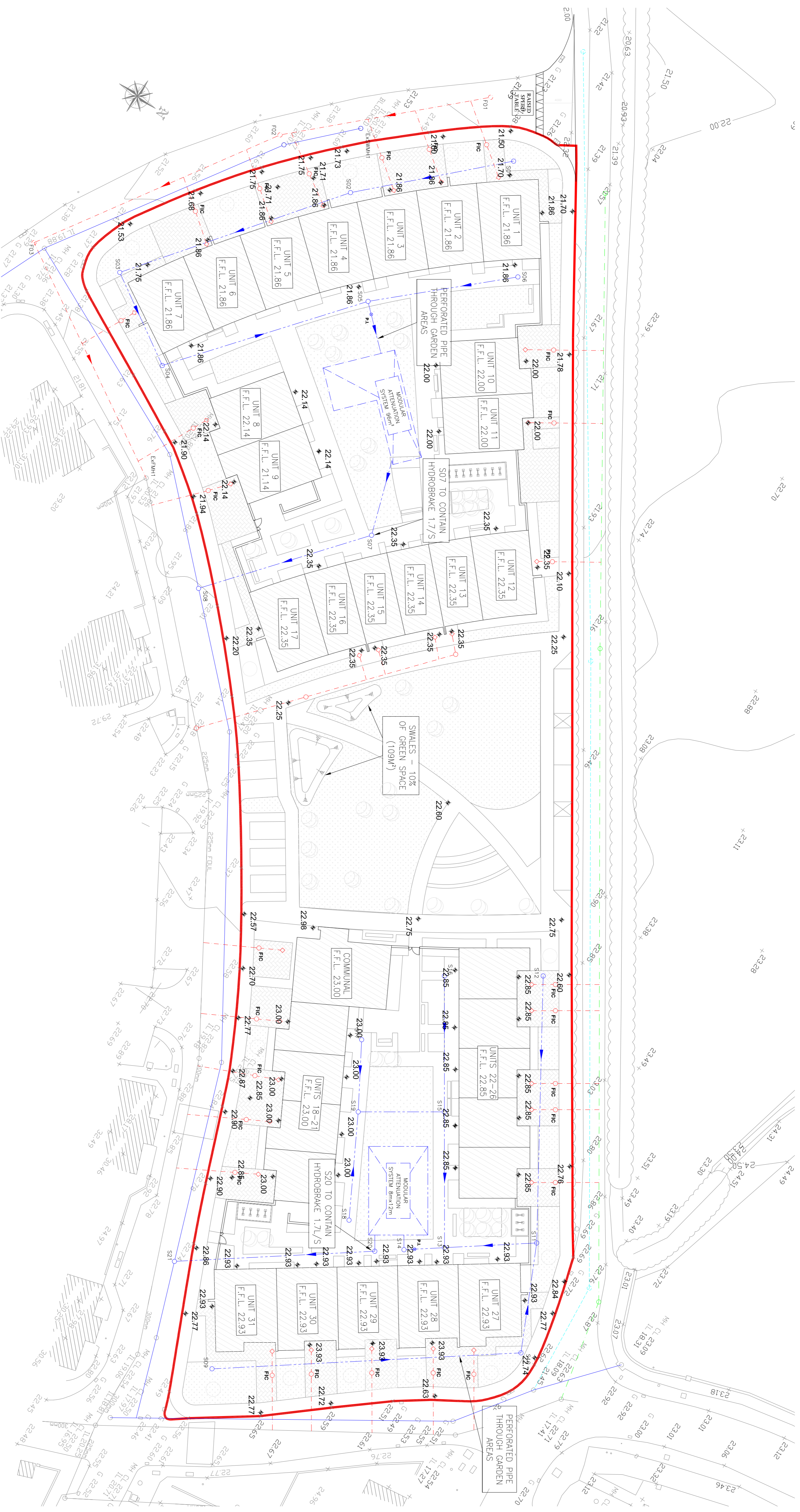

STORM WATER DRAINAGE TABLE

MANHOLE COVER LEVEL	INVERT LEVEL	MH - MH	PIPE DIA.	MIN. PEG. Ø90
S01	21.70	S01 - S02	225mm	1:170
S02	21.70	S02 - S03	225mm	1:170
S03	21.70	S03 - S04	225mm	1:170
S04	21.70	S04 - S05	225mm	1:170
S05	21.70	S05 - S06	225mm	1:170
S06	21.70	S06 - S07	225mm	1:170
S07	21.70	S07 - S08	225mm	1:170
S08	21.70	S08 - S09	225mm	1:170
S09	21.70	S09 - S10	225mm	1:170
S10	21.70	S10 - S11	225mm	1:170
S11	21.70	S11 - S12	225mm	1:170
S12	21.70	S12 - S13	225mm	1:170
S13	21.70	S13 - S14	225mm	1:170
S14	21.70	S14 - TANK	225mm	1:170
TANK	21.70	-	225mm	1:170

STORM WATER DRAINAGE TABLE

MANHOLE COVER LEVEL	INVERT LEVEL	MH - MH	PIPE DIA.	MIN. PEG. Ø90
S12	22.85	S12 - S11	225mm	1:170
S16	22.85	S16 - S15	225mm	1:170
S15	22.85	S15 - S14	225mm	1:170
S17	23.00	S17 - S19	225mm	1:170
S19	23.00	S19 - S18	225mm	1:170
S18	23.00	S18 - S17	225mm	1:170
S20	22.93	S20 - S21	225mm	1:170
S21	22.74	S21 - S20	225mm	1:170

FOUL SEWER DRAINAGE TABLE

MANHOLE COVER LEVEL	INVERT LEVEL	MH - MH	PIPE DIA.	MIN. PEG. Ø90
F01	21.40	F01 - F02	225mm	1:170
F02	21.67	F02 - F03	225mm	1:170
F03	21.36	F03 - EX/MH1	225mm	1:170
EX/MH1	21.86	-	225mm	1:170

HAYES HIGGINS PARTNERSHIP
The Glass House, 11 Coke Lane
Smithfield, Dublin 7. Tel: 01 661 2321
E-mail: admin@hayeshiggins.ie
One House Lane, Kilmoyr, Tel: (056) 7844710
Email: info@hh.ie

SCALE	1:300	DRAWN DATE	19.05.2021
CD/DRAWN BY	DW	CHECKED BY	LJM
		APPROVED BY	DH
PROJECT No.	18D062	REVISION	P
PRODUCT NAME	PROPOSED 31 HOUSING UNITS, AT KILLEDGE LANE LISK		
CLIENT	TUATH HOUSING		
ISSUED FOR PLANNING	DATE	DATE OF REV B	
PLANNING			
PROPOSED DRAINAGE LAYOUT			