

Road Level	Type Of works	Advance sign Distance (D) (m)	Min. Number of Advance Signs	Min. clear Visibility of signs (m)	Min. size of signs (MM)	Min. Height of cones (MM)	Long. Safety zone (L) (M)	side. Safety Zone(S) (M)	Long. Cone space	Long. Lamp space	Hard shoulder taper multiply Factor	Lane Taper taper multiply Factor	Lane Taper cone spacing	Lane Taper Lamp spacing	Lane Lead-in cone Tapers Recommended lengths.	Width of hazard Including Safety Zone			
Level 1 (i) 30KPH	Type A	20	1 (RWA) 1 (tm)	25	450	750	0.5	0.5	3	6	1	1	1	3	Length of taper (T) in (M)	1m	2m	3m	4m
	Type B															10	1 (RWA)	25	450
																Minimum no. of Cones	3	4	6
															Minimum no. of Lamps	2	2	3	3

**Legend**

- ▼ Diversion route 2
- Work Area

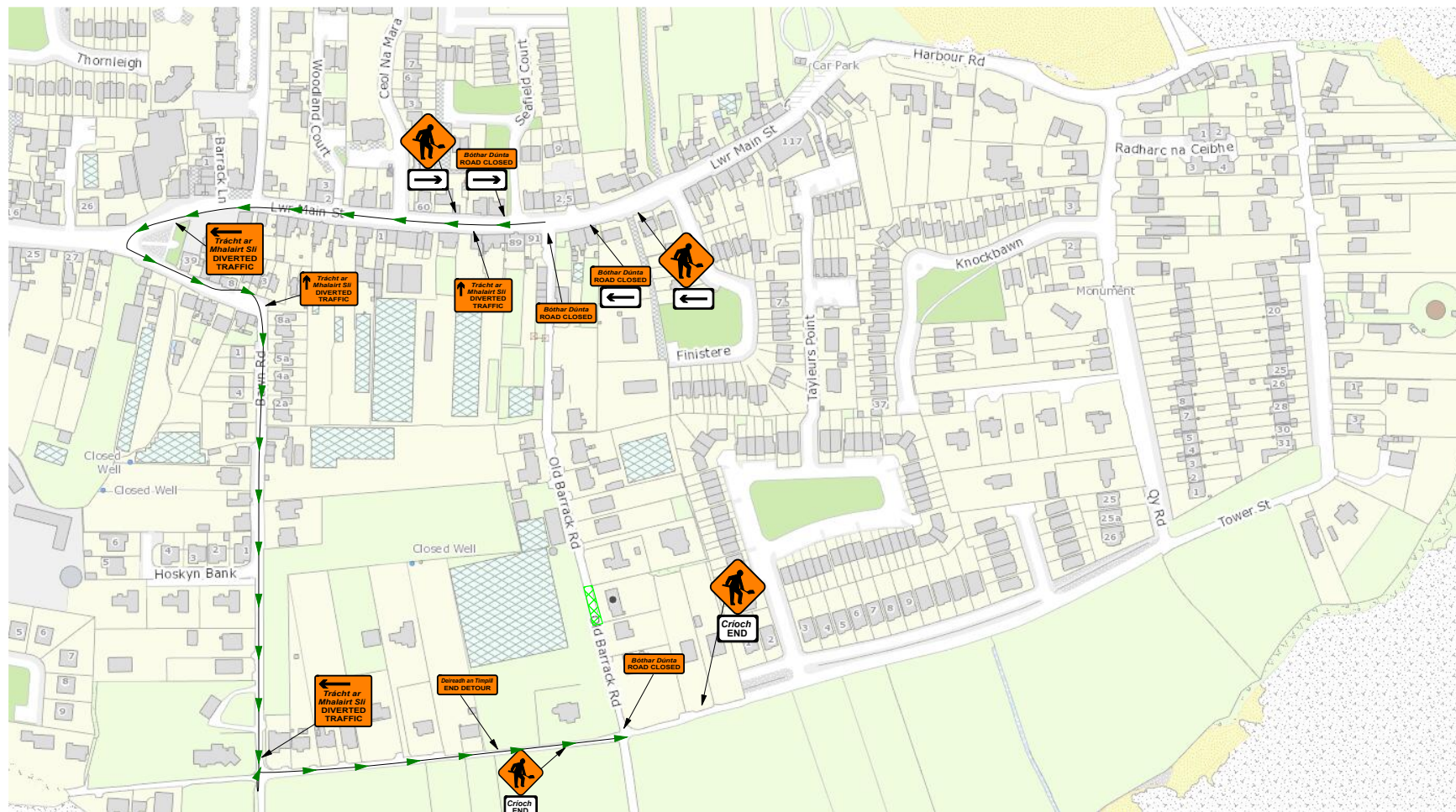
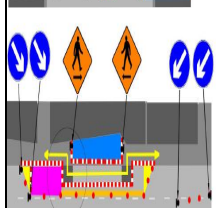
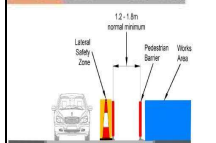
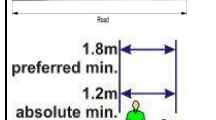
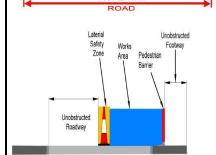

Project: 45650439 L.A.D.S OLD BARRICK ROAD-RUSH

**Comments:**

- All Signs to comply with Chapter 8 of the "Traffic signs Manual".
- All Traffic Management to be carried out in accordance with Chapter 8 of the "Traffic signs Manual".
- Detailed Risk assessment to be carried out prior to installation of the Traffic Management System.
- The Contractor shall be held responsible for providing all required ramp access to all changes in road surface paths or any surface which has a level discontinuity because of the works.
- All Safety zones to be always maintained.
- All Affected parties and An Garda Síochána to be notified prior to works commencing.
- Signs to be positioned to not cause an obstruction to other road users.

Author: tmp@seq.ie

**Comments:**

- All signs to be as per Parameters and faced with Retro-reflective material to class ref 2 of EN 12899.
- All Delineation devices should be designed in accordance with IS EN 13422. Safety Barriers to be in accordance with IS EN 1317.
- Entrance to existing dwellings and Business to be always maintained.
- Pedestrian barriers to be used around works if required. Pedestrians to be monitored and controlled by a tm operative during these works.
- A Mirror Image of this TMP will be used if & when working on the opposite side of the road with all signage adjusted accordingly.
- Suitable Ramps to be provided on site to maintain safe access to footpath for pedestrians.
- Traffic Management Plan is not to scale, and necessary adjustments will be made on site by SLG operative.

