

R:\MDT0875 - Church Fields Rd Link Design\8.0 Drawings\DMT0875-RPS-00-XX-DR-Z-IX0002-0004 - Scheme Location Planning Boundary.dwg

For next section refer to Sheet No. 2

Client

Comhairle Contae Fhine Gall  
Fingal County Council

Key Plan

General Notes

(i) Hard copies, dxf and pdf will form a controlled issue of the drawing. All other formats (dwg etc.) are deemed to be an uncontrolled issue and any work carried out based on these files is at the recipient's own risk. RPS will not accept any responsibility for any errors from the use of these files, either by human error by the recipient, listing of the un-dimensioned measurements, compatibility with the recipient's software, and any errors arising when these files are used to aid the recipient's drawing production, or setting out on site.

(ii) DO NOT SCALE. use figured dimensions only.

(iii) This drawing is the property of RPS, it is a project confidential classified document. It must not be copied used or its contents divulged without prior written consent. The needs and expectations of client and RPS must be considered when working with this drawing.

(iv) Information including topographical survey, geotechnical investigation and utility detail used in the design have been provided by others.

(v) All Levels refer to Ordnance Survey Datum, Malin Head.

Rev	Date	Drn Cnk	Amendment / Issue	App
P01	07.02.20	MDP	ISSUED FOR PLANNING	MN

West Pier  
Business Campus  
Dun Laoghaire  
Co. Dublin A96 N6T7

T +353 (0)1 4882900  
W www.rpsgroup.com/ireland  
E ireland@rpsgroup.com

Scale	1:1000 @ A1 1:2000 @ A3
Created on	FEB. '20
Sheet	1 of 3

Project		CHURCH FIELDS LINK ROAD & CYCLE NETWORK
Title		PART 8 PLANNING SCHEME LOCATION PLANNING BOUNDARY
File Identifier	MDT0875-RPS-00-XX-DR-Z-IX0002-0004 - Scheme Location Planning Boundary.dwg	Status
		S4
Rev		P01

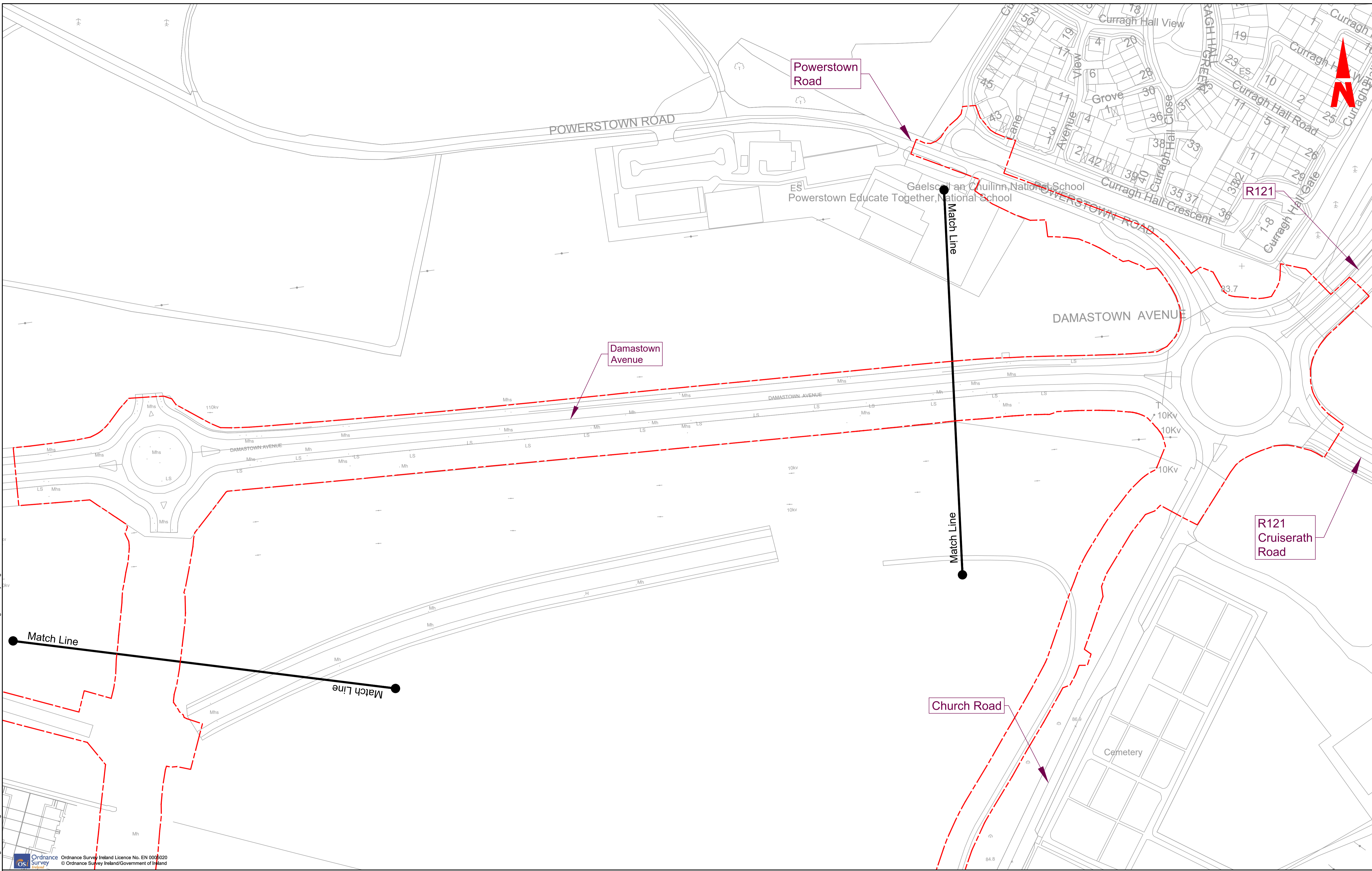

R:\MDT0875 - Church Fields Rd Link Design\8.0 Drawings\DMT0875-RPS-00-XX-DR-Z-IX0002-0004 - Scheme Location Planning Boundary.dwg

Ordnance Survey Ireland Licence No. EN 0005020  
© Ordnance Survey Ireland/Government of Ireland

For previous section refer to Sheet No. 1

For next section refer to Sheet No. 3

Client

Comhairle Contae Fhine Gall  
Fingal County Council

Key Plan

General Notes

(i) Hard copies, dwf and pdf will form a controlled issue of the drawing. All other formats (dwg etc.) are deemed to be an uncontrolled issue and any work carried out based on these files is at the recipient's own risk. RPS will not accept any responsibility for any errors from the use of these files, either by human error by the recipient, listing of the un-dimensioned measurements, compatibility with the recipient's software, and any errors arising when these files are used to aid the recipient's drawing production, or setting out on site.

(ii) DO NOT SCALE, use figured dimensions only.

(iii) This drawing is the property of RPS, it is a project confidential classified document. It must not be copied used or its contents divulged without prior written consent. The needs and expectations of client and RPS must be considered when working with this drawing.

(iv) Information including topographical survey, geotechnical investigation and utility detail used in the design have been provided by others.

(v) All Levels refer to Ordnance Survey Datum, Malin Head.

Rev	Date	Drn Cnk	Amendment / Issue	App
P01	07.02.20	MJD/DF	ISSUED FOR PLANNING	MN

West Pier  
Business Campus  
Dun Laoghaire  
Co. Dublin A96 N6T7

T +353 (0)1 4882900  
W www.rpsgroup.com/ireland  
E ireland@rpsgroup.com

Scale	1:1000 @ A1 1:2000 @ A3
Created on	FEB. '20
Sheet	2 of 3

Project	CHURCH FIELDS LINK ROAD & CYCLE NETWORK
Title	PART 8 PLANNING SCHEME LOCATION PLANNING BOUNDARY
File Identifier	MDT0875-RPS-00-XX-DR-Z-IX0002-0004 - Scheme Location Planning Boundary.dwg
Status	S4
Rev	P01

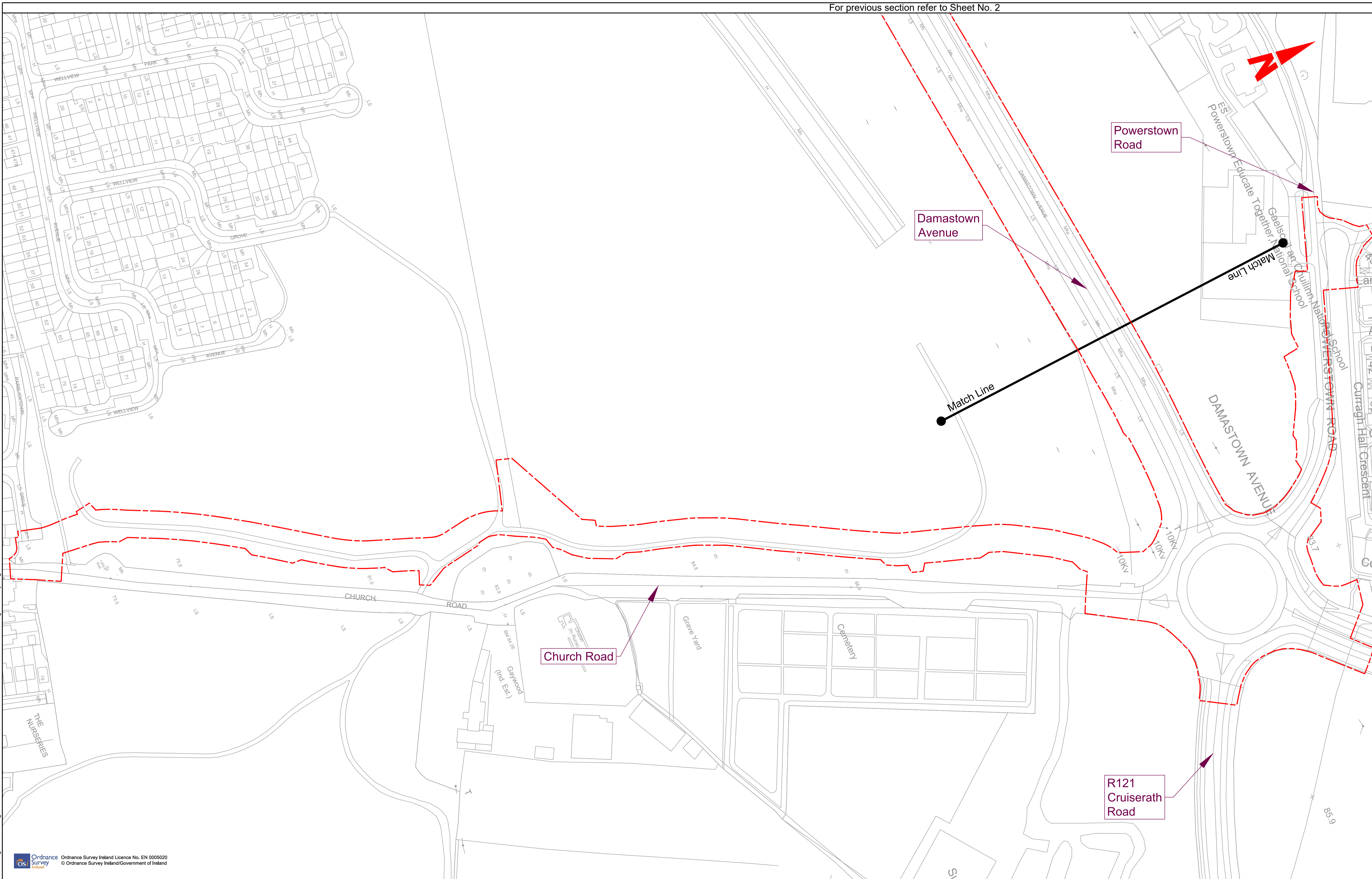

R:\MDT0875 - Church Fields Rd Link Design\8.0 Drawings\DM\MDT0875-RPS-00-XX-DR-Z-IX0002-0004 - Scheme Location Planning Boundary.dwg

Ordnance Survey Ireland Licence No. EN 0005020  
© Ordnance Survey Ireland/Government of Ireland

Client

Comhairle Contae Fhine Gall  
Fingal County Council

Key Plan

General Notes

(i) Hard copies, dwf and pdf will form a controlled issue of the drawing. All other formats (dwg etc.) are deemed to be an uncontrolled issue and any work carried out based on these files is at the recipient's own risk. RPS will not accept any responsibility for any errors from the use of these files, either by human error by the recipient, listing of the un-dimensioned measurements, compatibility with the recipient's software, and any errors arising when these files are used to aid the recipient's drawing production, or setting out on site.

(ii) DO NOT SCALE, use figured dimensions only.

(iii) This drawing is the property of RPS, it is a project confidential classified document. It must not be copied used or its contents divulged without prior written consent. The needs and expectations of client and RPS must be considered when working with this drawing.

(iv) Information including topographical survey, geotechnical investigation and utility detail used in the design have been provided by others.

(v) All Levels refer to Ordnance Survey Datum, Malin Head.

Rev	Date	Drn Cnk	Amendment / Issue	App
P01	07.02.20	WJG/DF	ISSUED FOR PLANNING	MN

West Pier  
Business Campus  
Dun Laoghaire  
Co. Dublin A96 N6T7

T +353 (0)1 4882900  
W www.rpsgroup.com/ireland  
E ireland@rpsgroup.com

Scale	1:1000 @ A1 1:2000 @ A3
Created on	FEB. '20
Sheet	3 of 3

Project	CHURCH FIELDS LINK ROAD & CYCLE NETWORK
Title	PART 8 PLANNING SCHEME LOCATION PLANNING BOUNDARY
File Identifier	MDT0875-RPS-00-XX-DR-Z-IX0002-0004 - Scheme Location Planning Boundary.dwg
Status	S4
Rev	P01