

NOTES:
 ALL TOPSOIL TO BE REUSED ON SITE.
 TRAIL TO BE LAID WITH A 1/40 CROSS FALL TO ALLOW SURFACE WATER TO NATURALLY DRAIN INTO THE SURROUNDING LANDS.

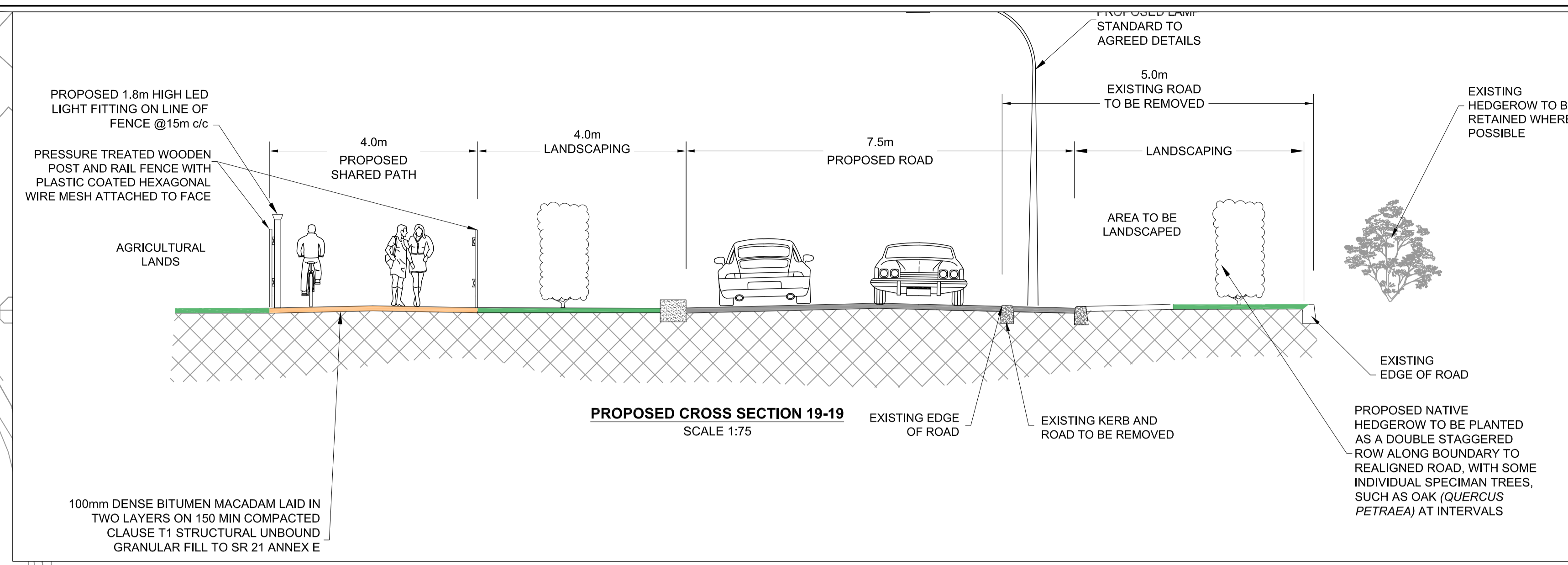

This drawing is produced using the Irish Grid Geographic Coordinate System

A1

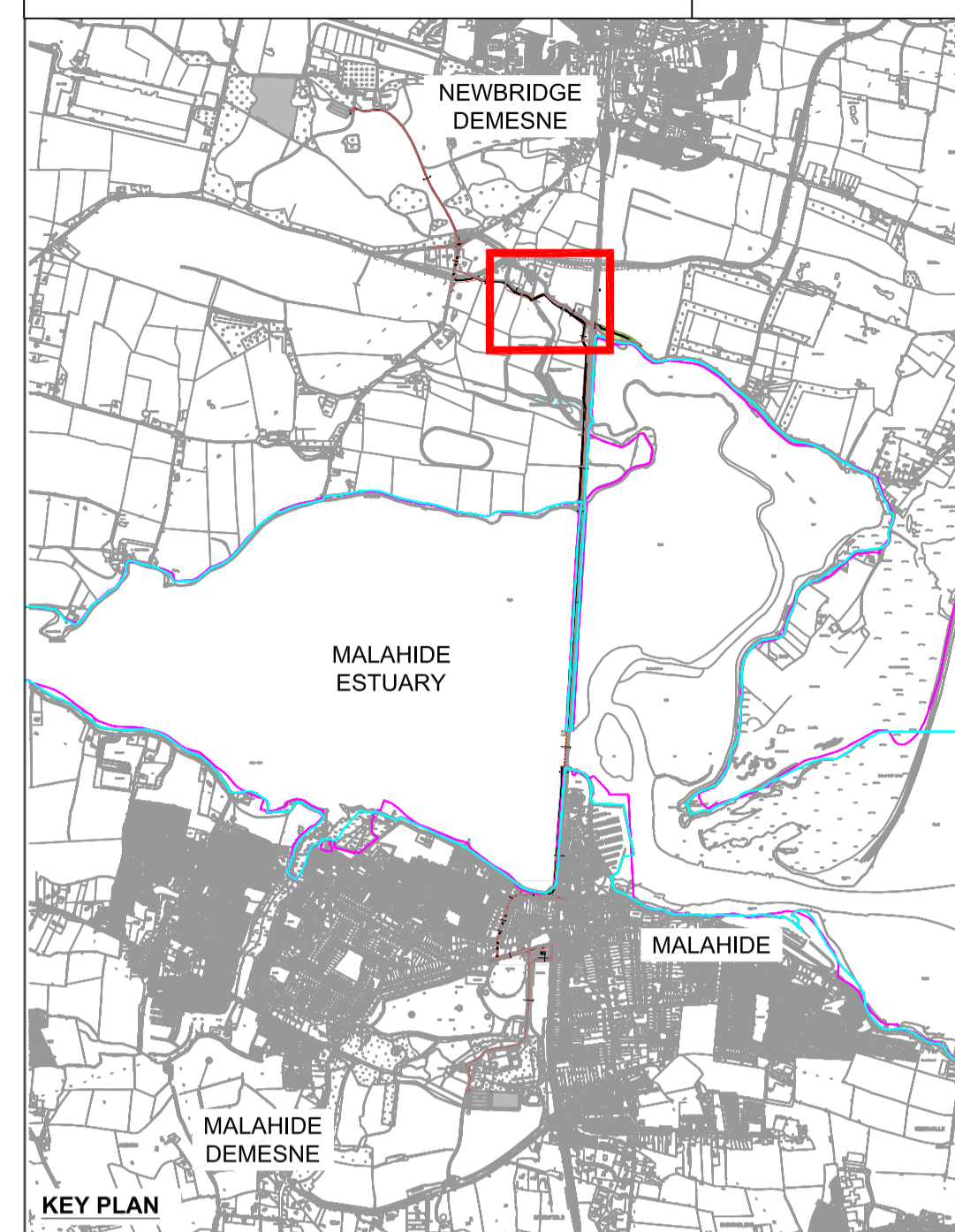

ALL EXISTING HEDGEROW TO BE MAINTAINED WHERE POSSIBLE

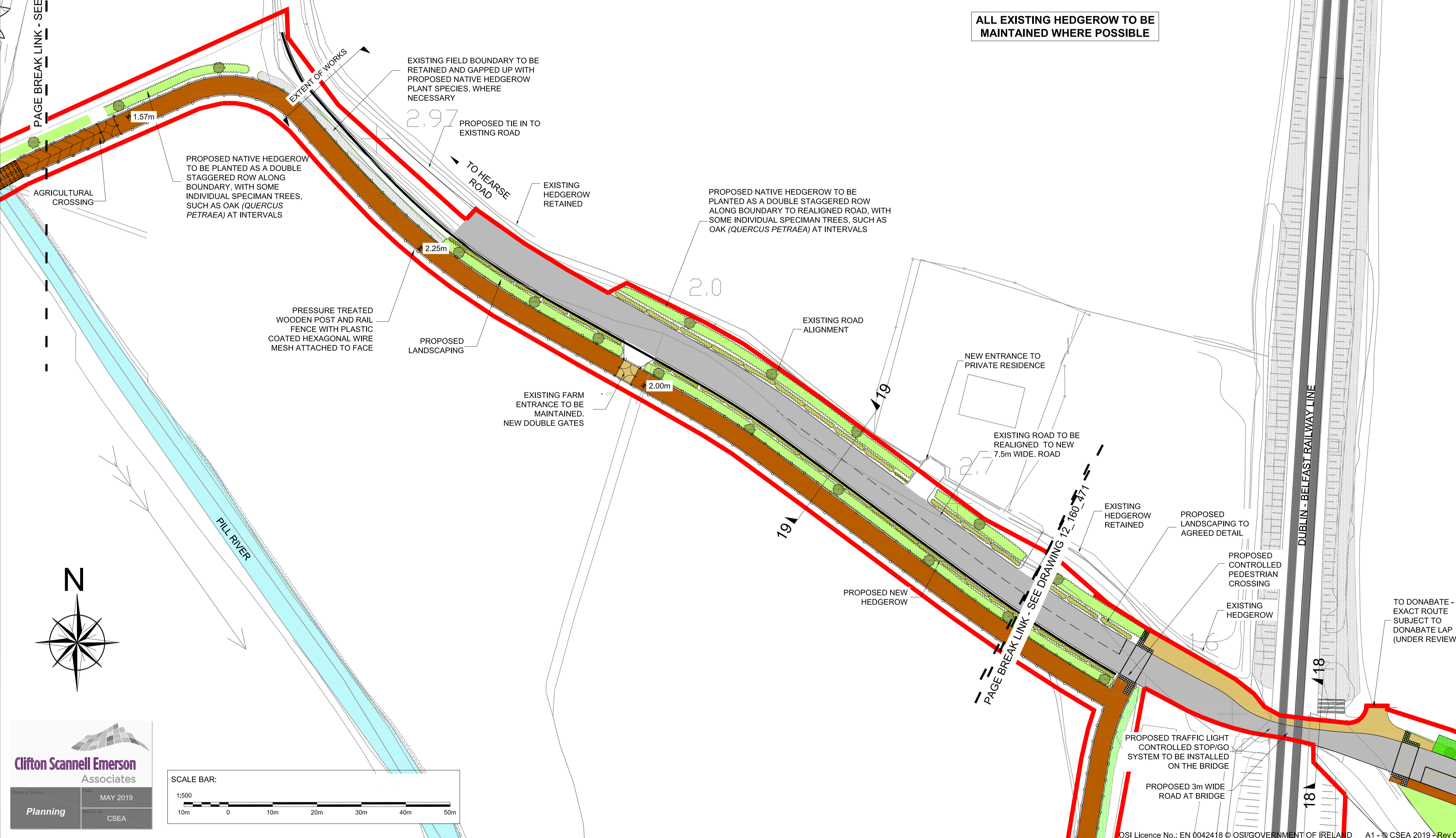

LEGEND:

EXISTING FOOTPATH	[Grey line]
PROPOSED FOOTPATH OR PROPOSED FOOTPATH IMPROVEMENT AS REQUIRED	[Yellow line]
PROPOSED GRASS VERGE/LANDSCAPING	[Green area]
PROPOSED CARRIAGEWAY REALIGNMENT & RESURFACING	[Grey area]
PROPOSED CAR PARKING	[Purple area]
PROPOSED SHARED AREA	[Orange area]
EXISTING SHARED AREA	[Red area]
EXISTING SHARED STREET TO BE RESURFACED	[Blue area]
SHARED STREET (NEW ROAD MARKINGS ONLY)	[Green area]
TRAIN TRACKS	[Black lines]
PROPOSED DEVELOPMENT AREA	[Red outline]
PROPOSED TRAIL FINISHED LEVELS	[Red line with +0.00m OD]

Revision	Description	Initials	Date

Comhairle Contae Fhine Gall
 Fingal County Council



An Roinn um Pleanáil agus Infrastruictúr Straitéiseach
 Planning and Strategic Infrastructure Department

Clifton Scannell Emerson Associates

Project	Broadmeadow Way		
Dwg. Title	Overall Surface Layout (Sheet 13 of 19)		
Drawn By	AMS	Date	May 2019
Checked by	PD	Scale	1:500 @ A1
Dwg. No.	12_160_472		

Clifton Scannell Emerson Associates
 Planning
 MAY 2019
 CSEA

