

# Broadmeadow Way - Section 6

## Newbridge Demesne

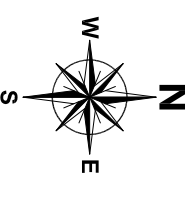

- Legend:**
- Section 1 Route A1 etc
  - Section 1 Route Junction
  - Crossings
  - Local Constraints
  - Lands Zoned (For Development)
  - Local Amenities (Newbridge Demesne)

TABLE OF POSSIBLE ROUTE COMBINATIONS:-

A1+A2+A3

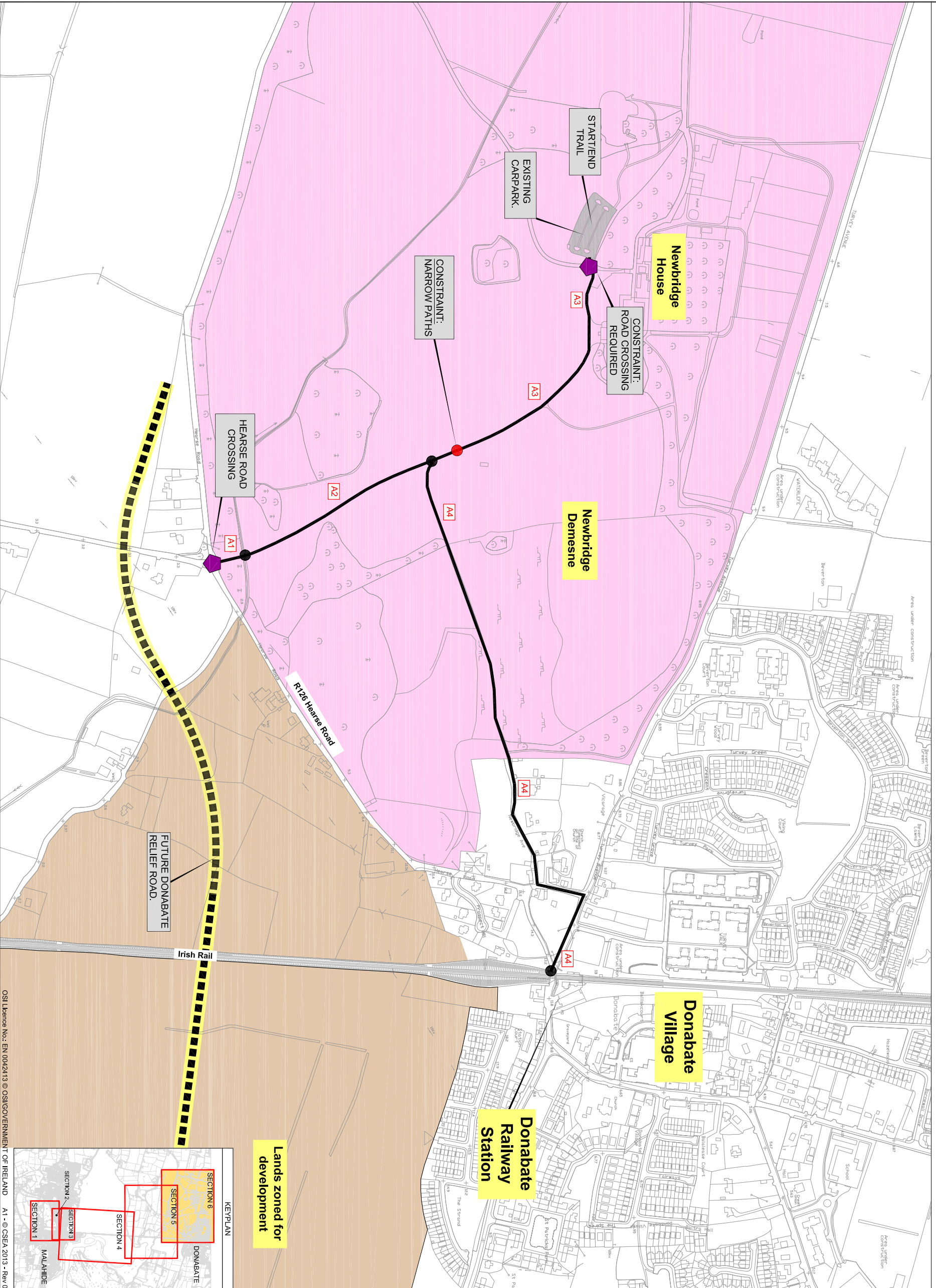

Lands zoned for development

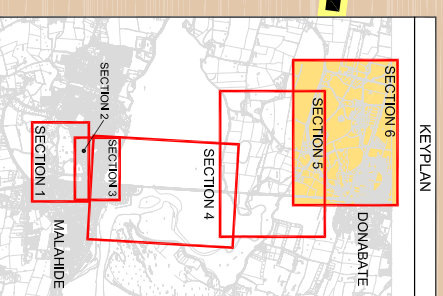

**Clifton Scannell Emerson Associates Limited**  
Consulting Engineers  
Sailort Lodge,  
Chalderdown Avenue,  
Blackrock, Co. Dublin,  
Ireland.  
T: +353 1 298 5008  
F: +353 1 293 3465  
E: info@cses.ie  
W: www.cses.ie

FINGAL COUNTY COUNCIL

BROADMEADOW WAY

ROUTE OPTIONS DESIGN REPORT  
SECTION 6 - ROUTES IDENTIFIED

Client: **FINGAL COUNTY COUNCIL**  
Project: **BROADMEADOW WAY**  
Drawn By: **NH** Date: **DECEMBER 2013**  
Checked by: **PM** Scale: **1:500 @ A1**  
Dwg. Progress: **12\_160\_133**  
Dwg. No.: