

Broadmeadow Way - Section 5

North Shore Of Malahide Estuary To R126 Hearse Road

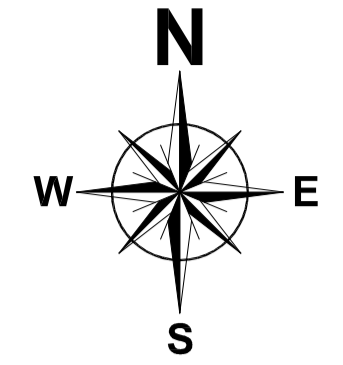

Legend:

- Section 5 Route A1 etc:
- Section 5 Route Junction:
- Crossings:
- Local Constraints:
- Lands Zoned (For Development):
- Local Amenities (Newbridge Demesne):

TABLE OF POSSIBLE ROUTE COMBINATIONS:-

- A1+A2+A3
- B1+B2+A2+A3
- B1+C1+C2+C3+C4+A3
- B1+C1+C2+D2+D3+D4
- B1+C1+E4+E5+E6+C4+A3
- B1+C1+E4+E5+D3+D4
- B1+C1+E4+E5+E7+D4
- B1+D1+C2+C3+C4+A3
- B1+D1+C2+D2+D3+D4
- B1+D1+C2+D2+E7+D4
- B1+D1+E4+E5+E6+C4+A3
- B1+D1+E4+E5+D3+D4
- B1+D1+E4+E5+E7+D4
- B1+E1+E2+C2+C3+C4+A3
- B1+E1+E2+C2+D2+D3+D4
- B1+E1+E2+C2+D2+E7+D4
- B1+E1+E3+E5+E6
- B1+E1+E3+E5+E6+C4+A3
- B1+E1+E3+E5+D3+D4
- B1+E1+E3+E5+E7+D4

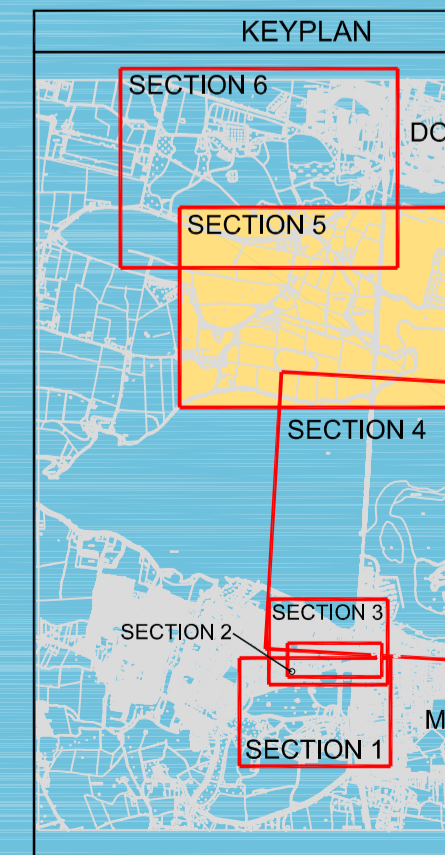
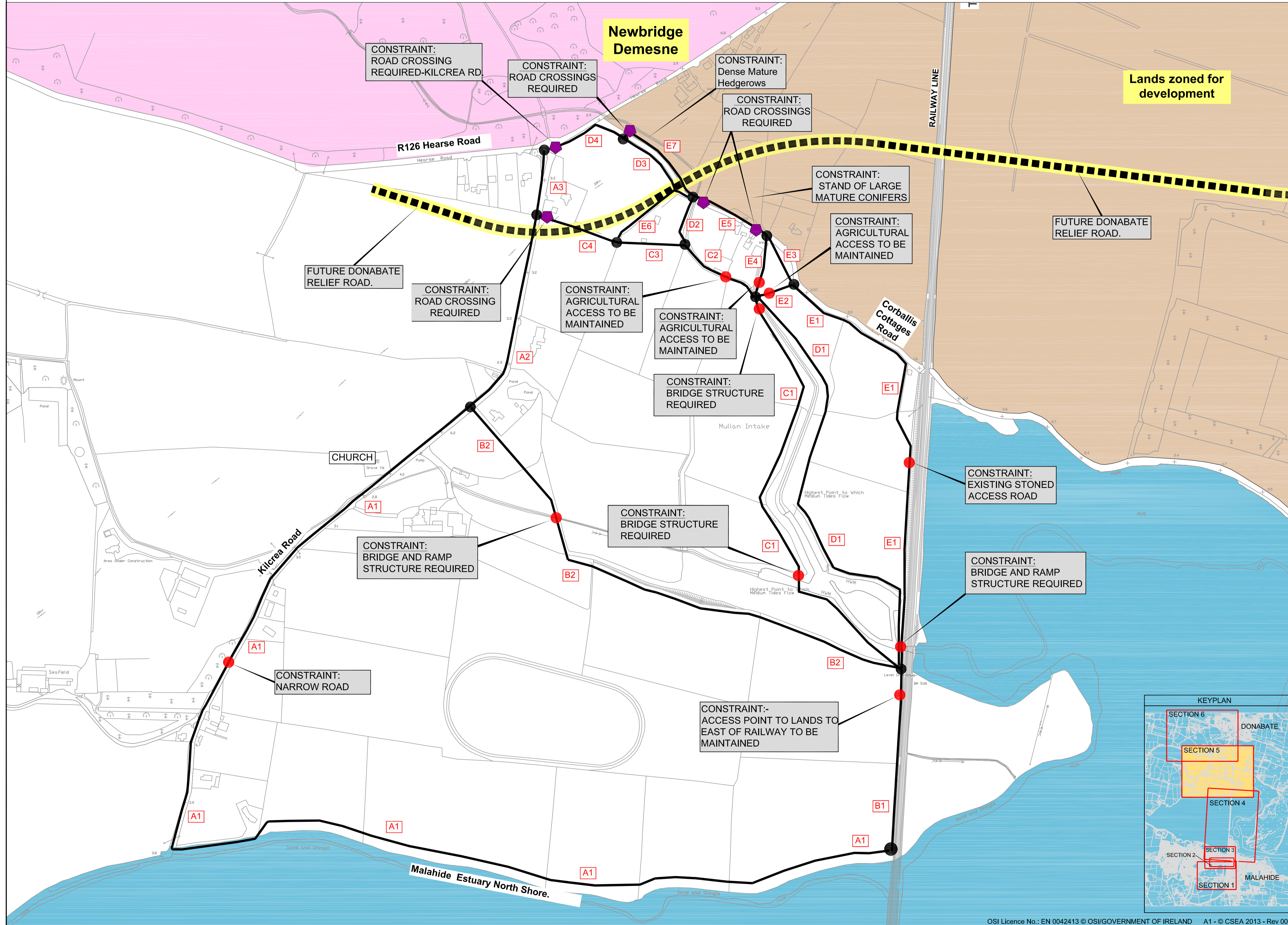

Revision | Description | Initials | Date

Clifton Scannell Emerson Associates
Clifton Scannell Emerson Associates Limited
Consulting Engineers,
Seafort Lodge,
Castledawson Avenue,
Blackrock, Co. Dublin,
Ireland.
T. +353 1 288 5006
F. +353 1 283 3466
E. info@csea.ie
W. www.csea.ie

Client	Fingal County Council
Project	Broadmeadow Way
Dwg. Title	ROUTE OPTIONS DESIGN REPORT SECTION 2
Drawn By	NH Date DECEMBER 2013
Checked by	NH Scale NTS @ A1
Dwg. Progress	
Dwg. No.	12_160_132